

REV.	SPECIFICATION	ECN NO.	APPD.

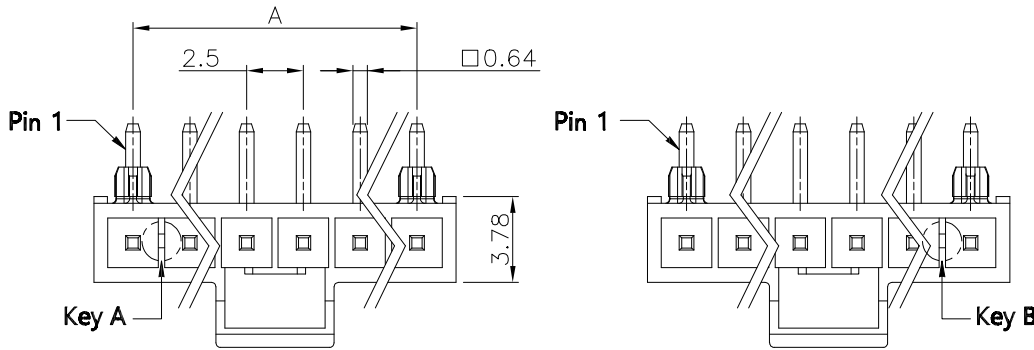

**Material:**  
Housing: LCP, UL 94V-0.  
Contacts: Brass, Tin 100u" Plated over Nickel 30u".  
**Electrical Characteristics:**  
Current Rating: 4.5 AMP .  
Dielectric Withstanding Voltage: AC 1500V.  
Insulation Resistance: 1000MΩ min.  
Contact Resistance: 10mΩ max.  
Operating Temperature: -40°C~+105°C.  
**\*RoHS Compliant**

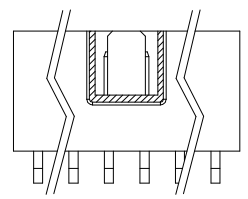
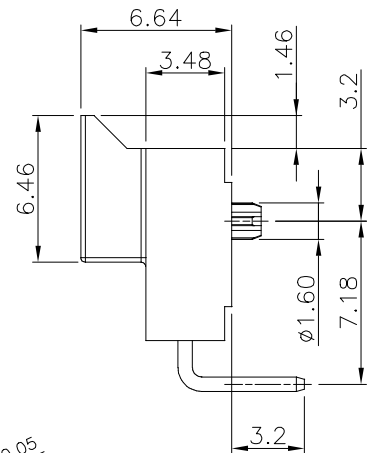
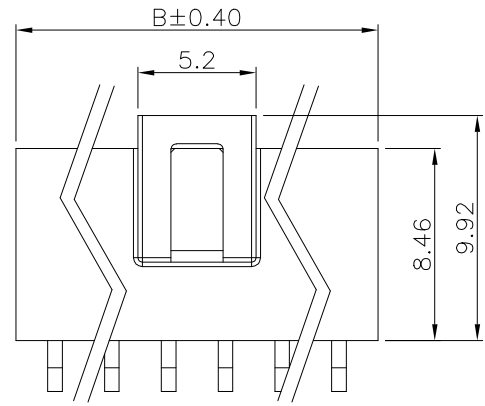

**02, 04, 06, 08P**  
Plastic

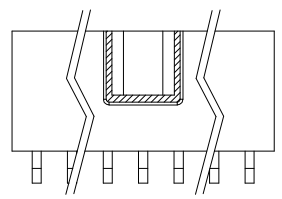

**03, 05, 07P**  
Plastic

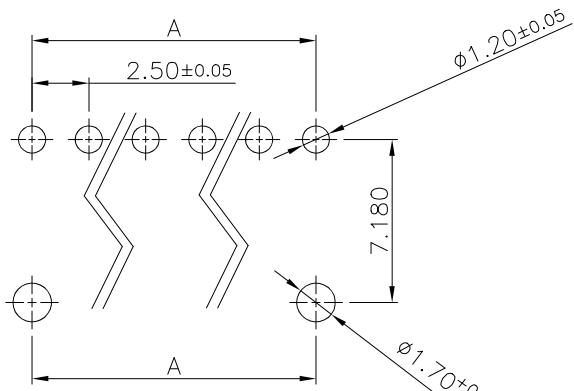

**Recommended PCB Layout**

Series: 4671-1 X xx T R P x B  
Single Row  
Positions  
T: Tin Plated  
R: Right Angle Type  
P: With Pspot  
B: Bulk Package  
A: A Key Only Black Color  
B: B Key Only Natural Color

Positions	Dimensions	
	A	B
02	2.50	5.94
03	5.00	8.44
04	7.50	10.94
05	10.00	13.44
06	12.50	15.94
07	15.00	18.44
08	17.50	20.94

Tolerances	Dwg. No.	S2320220516-01	Title:	4671 Series	 OUPIIN ELECTRONIC(KUNSHAN) CO., LTD. P/N: 4671-1XxxTRPx B
.x = ±0.4	Projection		Wafer 2.50mm Right Angle Type		
.xx = ±0.25	Unit	mm	Scale 1:N		
.xxx = ±0.08	Drawn By	Martin 10/28'22	Single Row with Post	① 667	SHEET 1/2 Ver.No. X2

REV.	SPECIFICATION	ECN NO.	APPD.

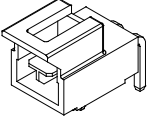
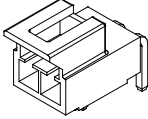
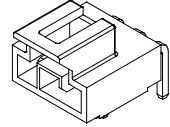
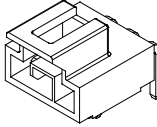
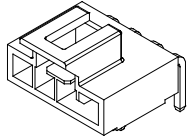
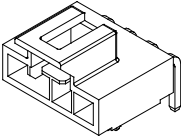
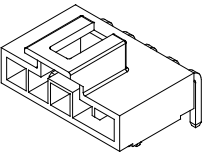
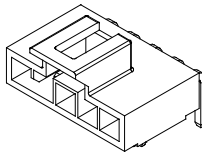
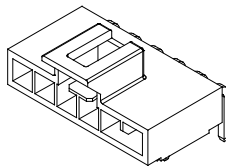
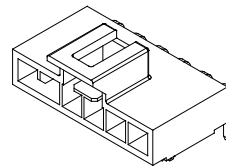
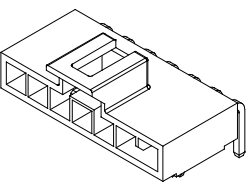
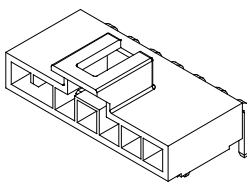
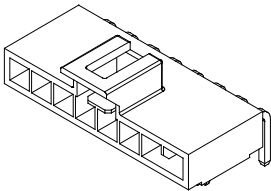
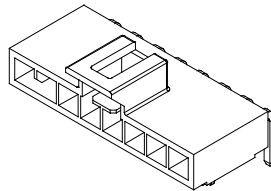
<b>02P</b>	<b>Key A / Black</b>	<b>02P</b>	<b>Key B / Natural</b>	<b>03P</b>	<b>Key A / Black</b>	<b>03P</b>	<b>Key B / Natural</b>
							
<b>04P</b>	<b>Key A / Black</b>	<b>04P</b>	<b>Key B / Natural</b>	<b>05P</b>	<b>Key A / Black</b>	<b>05P</b>	<b>Key B / Natural</b>
							
<b>06P</b>	<b>Key A / Black</b>	<b>06P</b>	<b>Key B / Natural</b>	<b>07P</b>	<b>Key A / Black</b>	<b>07P</b>	<b>Key B / Natural</b>
							
<b>08P</b>	<b>Key A / Black</b>	<b>08P</b>	<b>Key B / Natural</b>				
							

<b>Tolerances</b> .x = ±0.4 .xx = ±0.25 .xxx = ±0.08	<b>Dwg. No.</b>	S2320220516-01		<b>Title:</b> 4671 Series Wafer 2.50mm Right Angle Type Single Row with Post 667	 <b>OUPIIN ELECTRONIC(KUNSHAN) CO., LTD.</b> P/N: 4671-1XxxTRPxB	
	<b>Projection</b>					
	<b>Unit</b>	<i>mm</i>	<b>Scale</b>			1:N
	<b>Drawn By</b>	Martin 10/28'22				SHEET