

REV.	SPECIFICATION	ECN NO.	APPD.

**Material:**

Housing: PBT, UL94V-0, Black.  
 Contacts: Brass, Gold Plated over 30u" Nickel Plated.  
 Shell: Steel.

**Electrical Characteristics:**

Current Rating: 1 AMP.  
 Dielectric Withstanding Voltage: AC 1000V.  
 Insulation Resistance: 1000M Ωmin.  
 Contact Resistance: 30mΩ max.  
 Operating Temperature: -20°C~+70°C.

**\*RoHS Compliant**

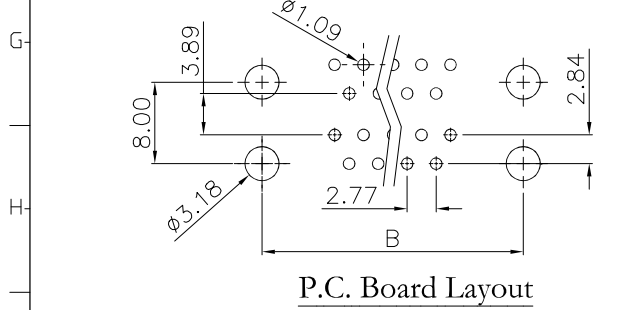
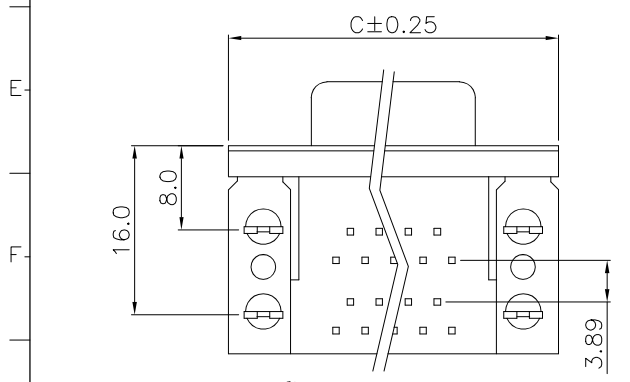
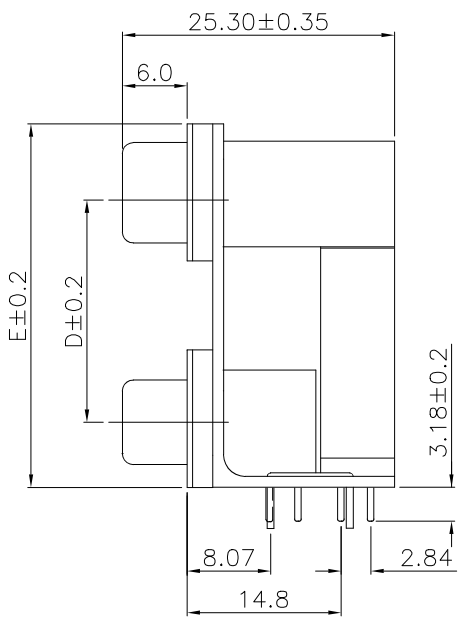
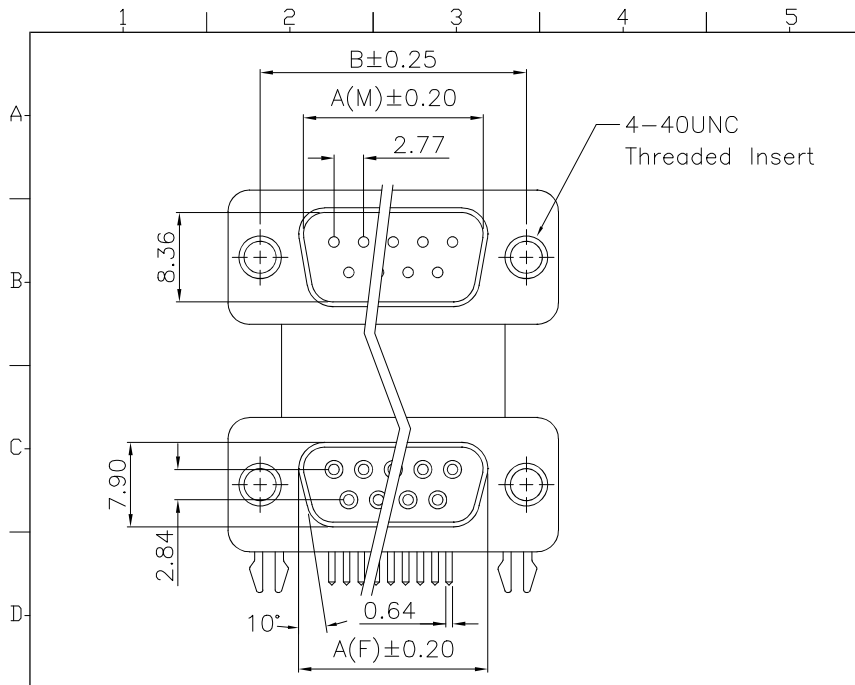

**7936-** Series    **xx** Position    **M** M: Male Top    **F** F: Female Bottom    **B** B: Grounding Fork    **x** 1: 15.88 See Dim: D    2: 19.05 See Dim: D    **A** A: Tray Package

Position	Dimension							
	A(M)	A(F)	B	C	D	E	E	
9	16.92	16.32	24.99	30.81	15.88	19.05	28.43	31.60
15	25.25	24.66	33.32	39.14	15.88	19.05	28.43	31.60
25	38.96	38.38	47.04	53.04	15.88	19.05	28.43	31.60

Tolerances	Dwg. No.	7936D03024	
x = ±0.50	Date	⊕ ⏏	
.x = ±0.25	Unit	mm	Scale 1:1
.xx = ±0.15	Drawn By	Martin 10/06'22	

Title: 7936 Series  
 D-SUB Double Port  
 Right Angle Type

**OUPIIN**  
 OUPIIN ELECTRONIC(KUNSHAN) CO., LTD.  
 P/N: 7936-xxMFBxA

SHEET	1/1	Ver.No.	A3
-------	-----	---------	----

⊕ 512