

REV.	SPECIFICATION	ECN NO.	APPD.
X2			

Material:

Housing: LCP, UL94V-0.
Contacts:
Power Contacts: High Conductivity Copper
 30u" Au+Pd/Ni on Contact Area and 80u" Min Tin Plated on Solder Tail over Nickel 50u" Min.
Signal Contacts: Phosphor Bronze
 30u" Au+Pd/Ni on Contact Area and 80u" Min Tin Plated on Solder Tail over Nickel 50u" Min.
Lock: Phosphor Bronze.

Electrical Characteristics:

Current Rating: Signal Pin 2.5 AMP.
 Power Pin 60 AMP.
Dielectric Withstanding Voltage: Signal Pin DC 1000V For 1 minute.
 Power Pin DC 2500V For 1 minute.
Insulator Resistance: Signal Pin 5000MΩ min. at DC 500V.
 Power Pin 20000MΩ min. at DC 500V.
Contact Resistance: Signal Pin 15mΩ max. at DC 20mA.
 Power Pin 0.7mΩ max. at DC 20mA.
Operating Temperature: -40°C ~ +105°C.

***RoHS Compliant**

Note:

H: High density Power---PCB Mount 5.08mm Pitch
 P: DC Power---PCB Mount 6.35mm Pitch
 A: AC Power---PCB Mount 7.62mm Pitch
 S: Signal---PCB Mount 2.54mm Pitch

ROWS	POWER			SIGNAL		POWER						
	P10	P9	P8	2	1	P7	P6	P5	P4	P3	P2	P1
D				L	L	FS	FS	FS	FS	FM	FM	
C				L	L	FS	FS	FS	FS	FM	FM	
B				L	L	FS	FS	FS	FS	FM	FM	
A				L	L	FS	FS	FS	FS	FM	FM	

POWER CONTACT TO THE TOP DISTANCE 2.34mm	PM
POWER CONTACT TO THE TOP DISTANCE 1.07mm	PS
POWER CONTACT TO THE TOP DISTANCE 2.34mm, THE MATING LENGTH 4.06mm	FM
POWER CONTACT TO THE TOP DISTANCE 1.07mm, THE MATING LENGTH 5.33mm	FS
SIGNAL CONTACT 3.43 SOLDER TAIL, PD/NI	L

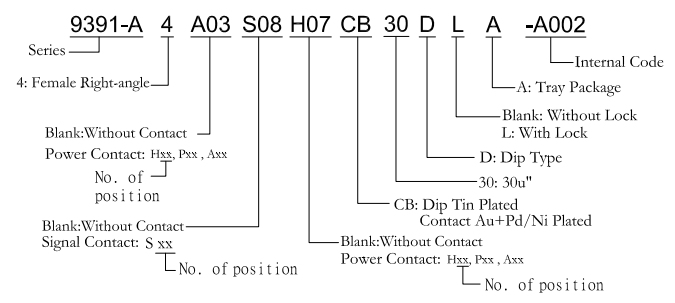
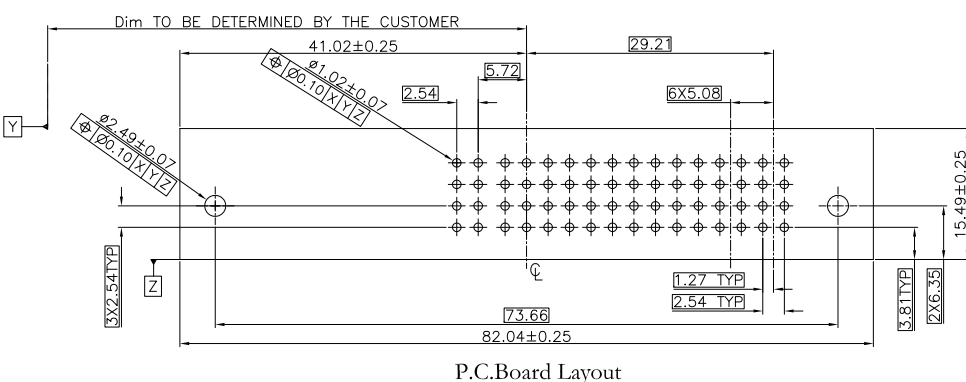
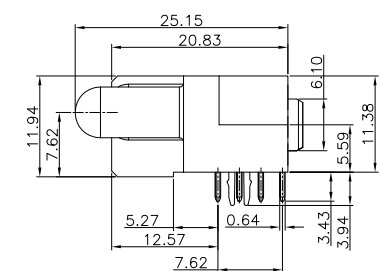
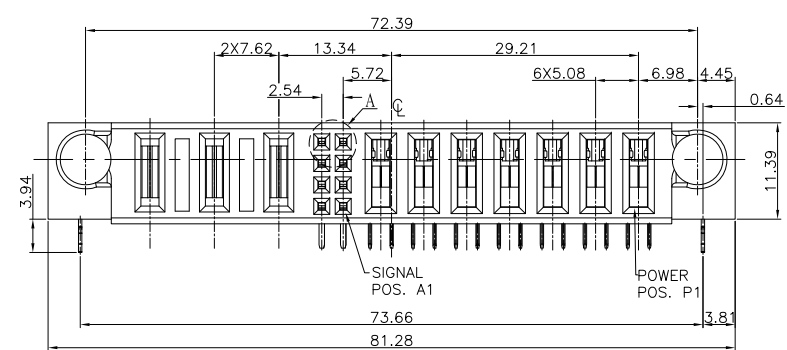
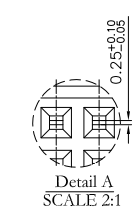
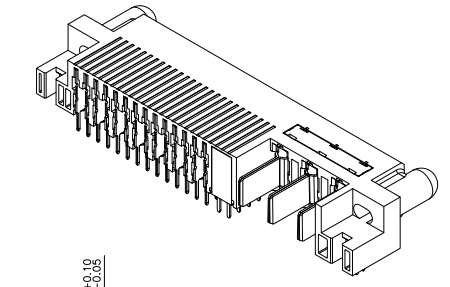
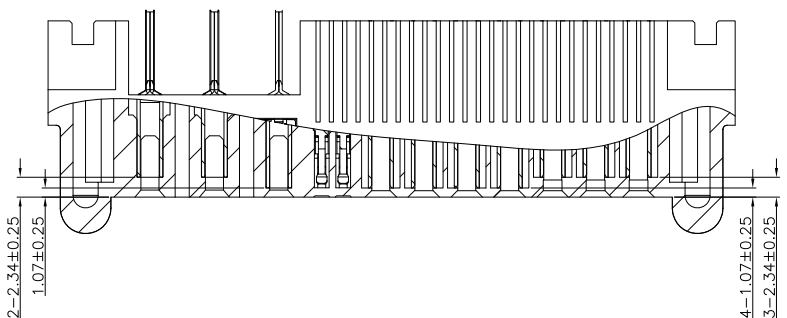

Tolerances	Dwg. No.	9391-D0000-188	Title:		 OUPIN ELECTRONIC(KUNSHAN) CO., LTD. P/N: 9391-4A03S08H07CB30DLA-A002
x = ±0.5	Projection		9391-A Series Female Right-angle Dip Type		
.x = ±0.25	Unit	mm	Scale	1:1	
.xx = ±0.15	Drawn By	CXP 12/03'18	SHEET	1/1	Ver. No.
					X2