

REV.	SPECIFICATION	ECN NO.	APPD.
R3		ECN220859	

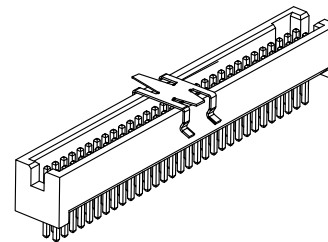
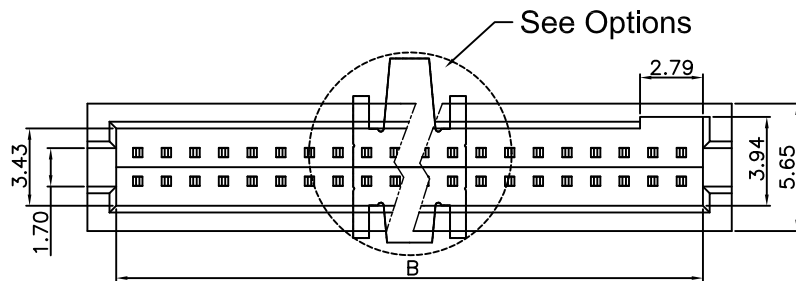

Material and Plating:

Housing: LCP, UL94V-0, BLACK.

Contact: Brass.

Gold Plated on Contact Area and 80u" Min Tin or Gold Flash Plated on Solder Tail over Nickel 50u" Min.

Electrical Characteristics:

Current Rating: 1 AMP.

Dielectric Withstanding: AC 500V For 1 minute.

Insulation Resistance: 1000MΩ min. at DC 500V.

Contact Resistance: 20mΩ max. at DC 100mA.

Operating Temperature: -65°C ~ +125°C

***RoHS Compliant**

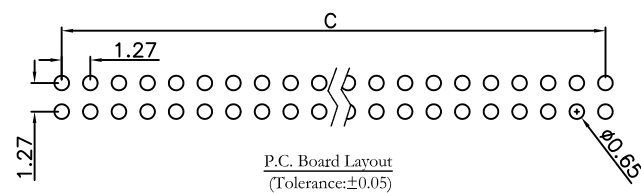
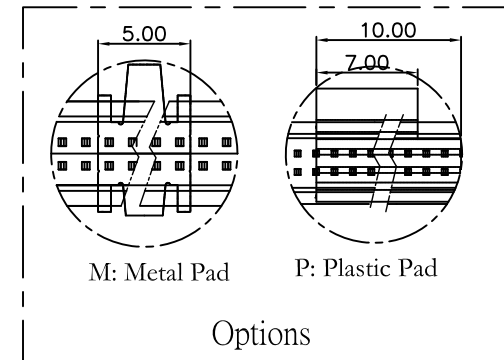
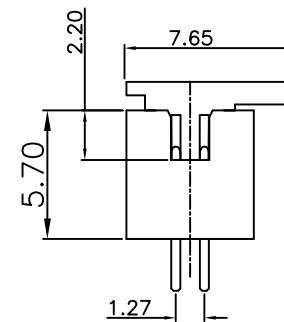
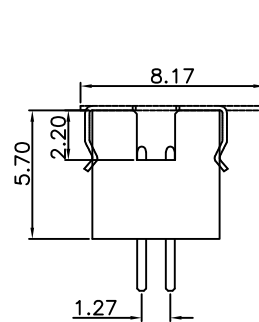
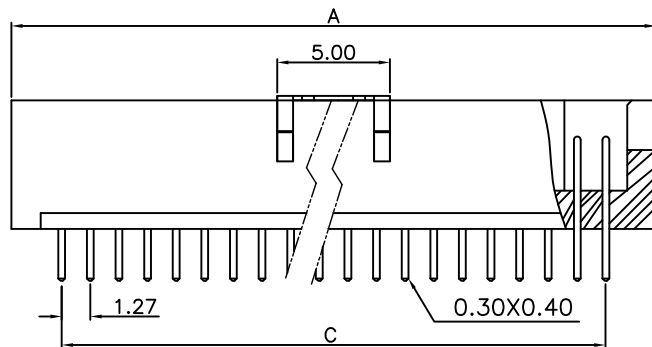

Series: 2216-xx C xx S N x x- x
 No. of Pin Count: xx
 C: Selective Gold Plated
 G: Gold Plated
 00: G/F
 10: 10μ
 15: 15μ
 30: 30μ
 S: Straight
 Blank: Without Pad
 M: Metal Pad
 P: Plastic Pad
 T: Tape & Reel Package
 U: Tube Package
 1: 3.05mm
 2: 1.91mm
 3: 2.30mm
 N: Without Post

X	1	2	3
Length	3.05	1.91	2.30
Position	10 Thru 100		
Dimension	10 Thru 100		
A	1.27 X No. of Positions / 2+3.18		
B	1.27 X No. of Positions / 2+0.64		
C	1.27 X No. of Positions / 2-1.27		

Tolerances	Dwg No.	2216D01001
x = ±0.5	Projection	
.x = ±0.25	Unit	mm
.xx = ±0.15	Scale	1:1
	Drawn By	CCH8/25/22

Title: 2216 Series
 Box Header
 1.27mmX1.27mm(0.050"X0.050")

OUPIN			
OUPIN ELECTRONIC(KUNSHAN) CO., LTD.			
P/N: 2216-xxCxxSNxx-x			
SHEET	1/1	Ver. No.	R3