

REV.	SPECIFICATION	ECN NO.	APPD.
R3		ECN151236	

**Material:**

Housing: Thermoplastic Polyester Glass Filled UL94V-0.

Contacts: Copper Alloy.

**Electrical Characteristics:**

Current Rating: 2 AMP.

Dielectric Withstanding Voltage: AC 1000V For 1 minute.

Insulator Resistance: 1000MΩ min. at DC 500V.

Contact Resistance: 20mΩ max. at DC 100mA.

Operating Temperature: -55°C~+105°C .

**\*RoHS Compliant**

Insertion Depth: 2.55mm to 3.80mm.

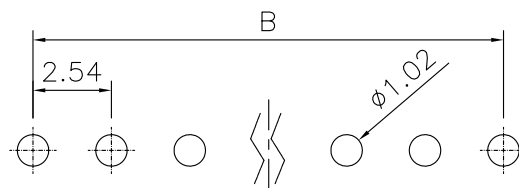
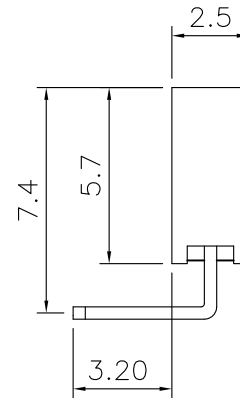
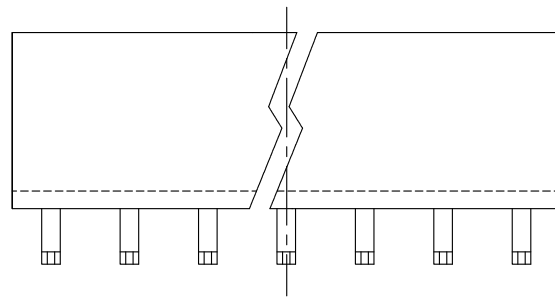
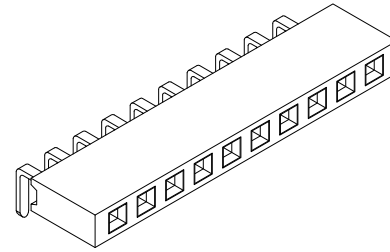
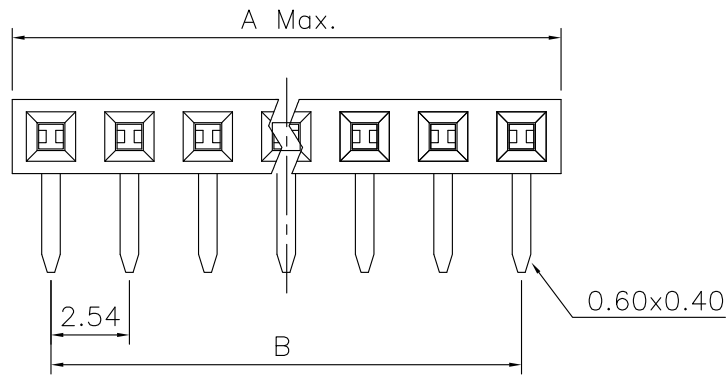

P.C. Board Layout  
(Tolerance: ±0.05mm)

Series: 2042-  
Single Row: 1 X  
No. of Pin Per Row: xx  
G: Gold Plated  
T: Tin Plated  
xx G xx R A  
A: Tray Package  
B: Bulk Package  
R: Right Angle  
00: G/F  
10: 10μ"  
15: 15μ"  
30: 30μ"

Position	2 Thru 40
Dimension	
A	2.54 X No. of Position
B	2.54 X No. of Position -2.54

Tolerances	Dwg. No.	2042-D0000-002
x = ±0.5	Projection	
.x = ±0.25	Unit	mm
.xx = ±0.15	Scale	1:1
	Drawn By	zbs 02/29'16

Title:  
2042 Series  
P.C.B. Socket 2.54mm  
(0.100")

OUPIIN ELECTRONIC(KUNSHAN) CO., LTD.			
P/N: 2042-1XxxGxxRA			
SHEET	1/1	Ver.No.	R3