

REV.	SPECIFICATION	ECN NO.	APPD.
R1		ECN171230	

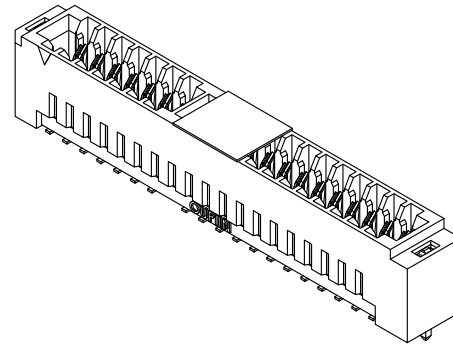
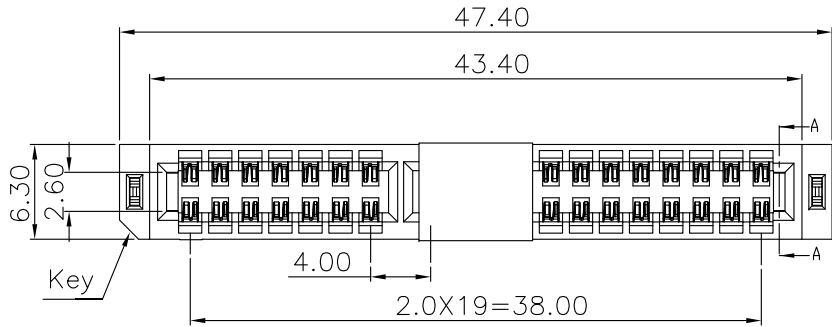

Material:

Housing: High Temperature Plastic UL94V-0.

Contacts: Copper Alloy.

Electrical Characteristics:

Current Rating: 2.5 AMP.

Dielectric Withstanding Voltage: AC 500V For 1 minute.

Insulator Resistance: 5000MΩ min. at DC 500V.

Contact Resistance: 5.8mΩ max. at DC 100mA.

Operating Temperature: -55°C~+125°C.

***RoHS Compliant**

Insertion Depth: 3.15mm.

Mates With: 2.36±0.05mm Thick Edge Card.

Speed: 28+Gbps @-3dB.

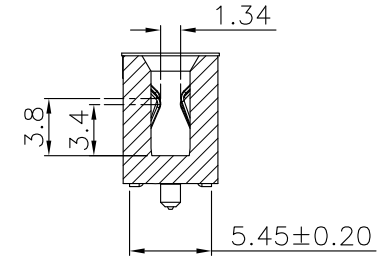
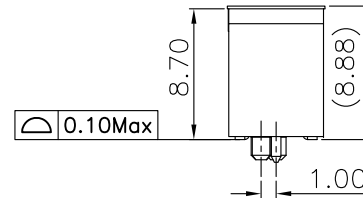
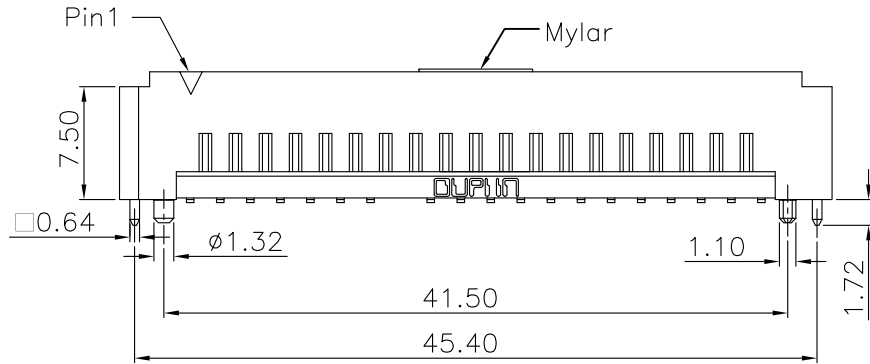

SECTION A-A

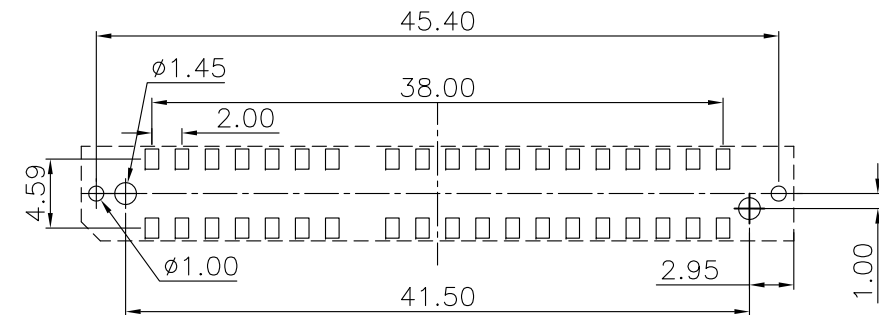

P.C. Board Layout
(Tolerance ±0.05)

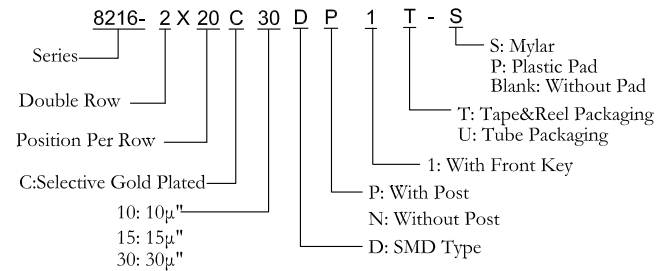

Tolerances	Dwg. No.	8216-D0000-004	Title:	 OUPIIN ELECTRONIC(KUNSHAN) CO., LTD. P/N: 8216-2X20C30DP1T-S			
x = ±0.50	Projection		8216 Series				
.x = ±0.25	Unit mm	Scale 1:1	Edge Card Connector				
.xx = ±0.15	Drawn By MXM 12/12'17		2.0mm (0.0787") Pitch SMD Type				
				SHEET	1/1	Ver.No.	R1