

REV.	SPECIFICATION	ECN NO.	APPD.
X5			

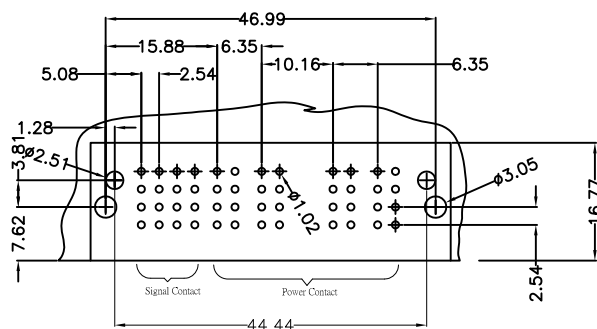

P.C.Board Layout
(Tolerance:±0.05)

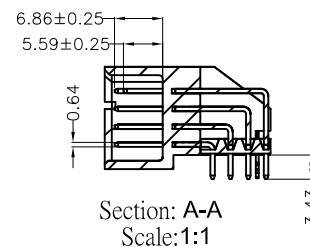
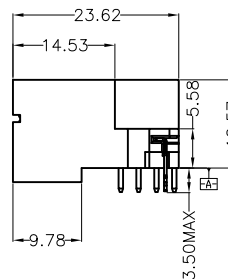
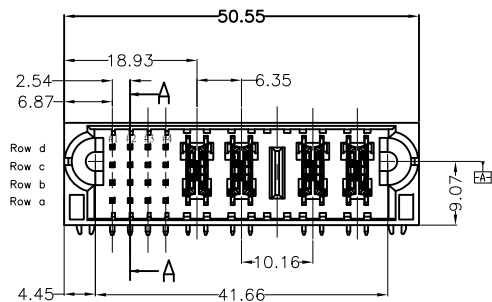
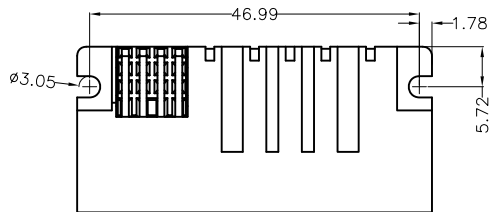
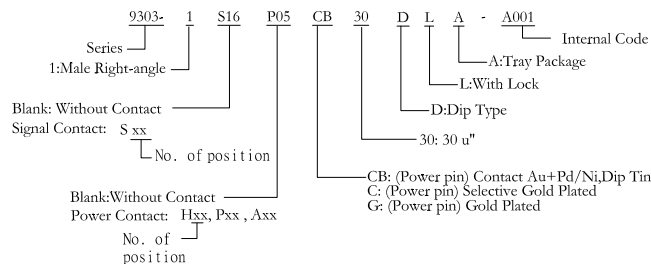

Material:

Housing: High Temperature Plastic UL94V-0.

Contacts: Copper Alloy.

Electrical Characteristics:

Current Rating: Signal Pin: 2.5 A .

Power Pin: 65 A(2oz x 6).

Dielectric Withstanding Voltage:

Signal Pin DC 1000V For 1 minute.

Power Pin DC 2500V For 1 minute.

Insulator Resistance: Signal Pin 500MΩ max.

Power Pin 1000MΩ max.

Contact Resistance: Signal Pin 20mΩ max.

Power Pin 10mΩ max.

Operating Temperature: -20°C ~+85°C .

***RoHS Compliant**

Notes 1 :

H: High density Power--PCB Mount 5.08mm Pitch

P: DC Power--PCB Mount 6.35mm Pitch

A: AC Power--PCB Mount 7.62mm Pitch

S: Signal--PCB Mount 2.54mm Pitch

Notes 2 :

a4 , d2 Contact Length is 5.59mm.

Other Pin Contact Length is 6.86mm.

ROWS	SIGNAL				POWER				
	1	2	3	4	P1	P2	P3	P4	P5
D	G	G	G	G					
C	G	G	G	G	MS	MS	Retaining Wall	MS	MS
B	G	G	G	G					
A	G	G	G	E					

SIGNAL PIN CONTACT LENGTH 4.32mm	H
SIGNAL PIN CONTACT LENGTH 5.59mm	E
SIGNAL PIN CONTACT LENGTH 7.05mm	F
SIGNAL PIN CONTACT LENGTH 6.86mm	G
HOT PLUG POWER CONTACT.STD	MS

Tolerances	Dwg. No.	9303-D0000-001	Title:	9303 Series
x = ±0.5	Projection		Unit	mm
.x = ±0.25	Scale	1:1	Drawn By	WP 05/04'15
.xx = ±0.15				

9303 Series
Male Right-angle Dip Type

OUPIN			
OUPIN ELECTRONIC(KUNSHAN) CO., LTD.			
P/N: 9303-1S16P05CB30DLA-A001			
SHEET	1/1	Ver. No.	X5