

REV.	SPECIFICATION	ECN NO.	APPD.
A1			

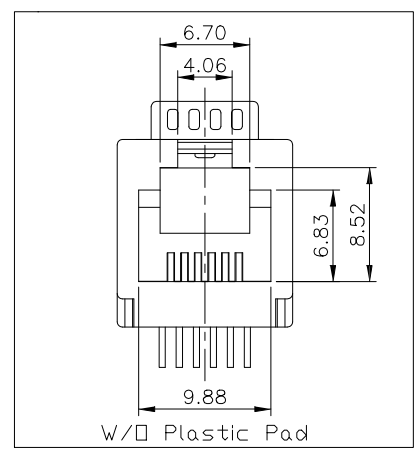
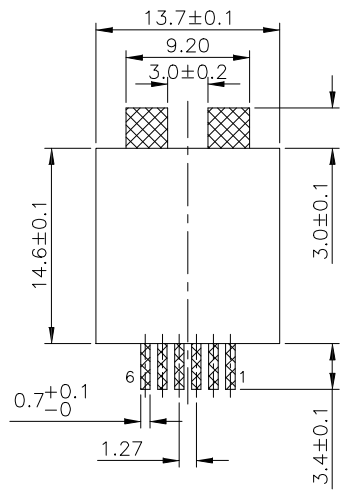
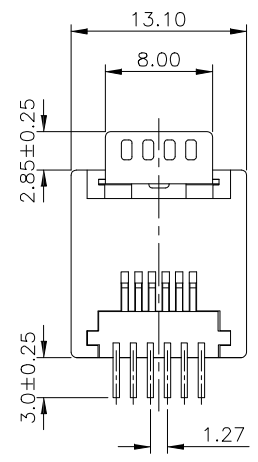
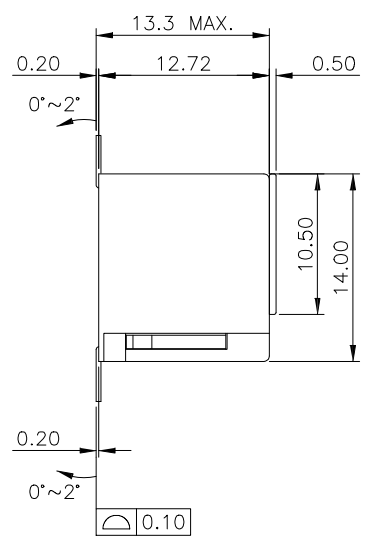
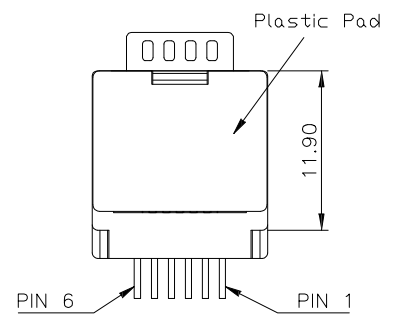

RECOMMENDED PCB LAYOUT  
 PCB THICKNESS: 1.6mm  
 TOLERANCE: ±0.05mm

**Material:**

Housing: PA9T, UL94V-0, Black.  
 Insert Housing&Cover: PA46, UL94V-0, Black.  
 Contacts: Phosphor Bronze, Gold Plated on Contact Area and Gold Flash on Solder Tail over Nickel.  
 Hold Down: Brass, 50u" Matte Tin Plated.

**Electrical Characteristics:**

Voltage Rating: AC 150V.  
 Current Rating: 1.5 AMP.  
 Dielectric Withstanding Voltage: 1000V for 1 minute.  
 Insulator Resistance: 500MΩ min. at DC 500V.  
 Contact Resistance: 30mΩ max. at DC 100mA.  
 Operating Temperature: -40°C~+85°C.

**\*RoHS Compliant**

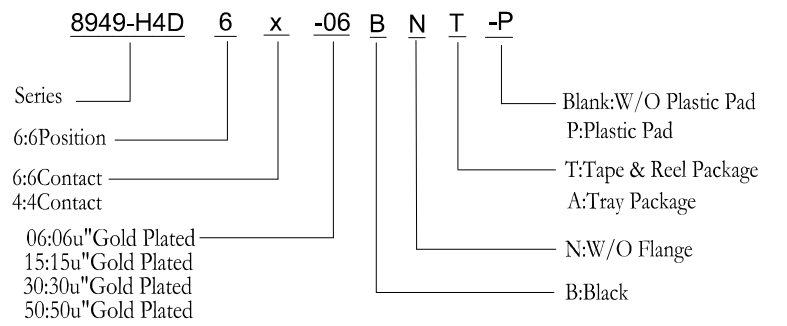

Tolerances	Dwg No.	8949D02138		Title:	
x = ±0.5	Projection	⊕ ↯		8949-H4D Series	
.x = ±0.25	Unit	mm	Scale	1:1	
.xx = ±0.15	Drawn By	Martin 07/11'22		Top Entry SMD Type	
			① 563		

<b>OUPIN</b>			
OUPIN ELECTRONIC(KUNSHAN) CO., LTD.			
P/N: 8949-H4D6x-06BNT-P			
SHEET	1/1	Ver. No.	A5