

REV.	SPECIFICATION	ECN NO.	APPD.
R5		ECN210406	

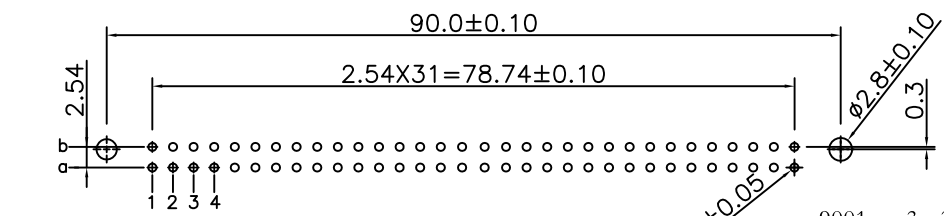
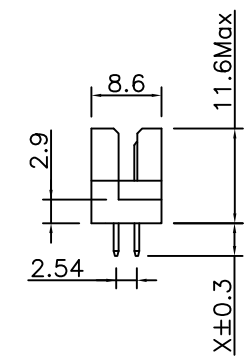
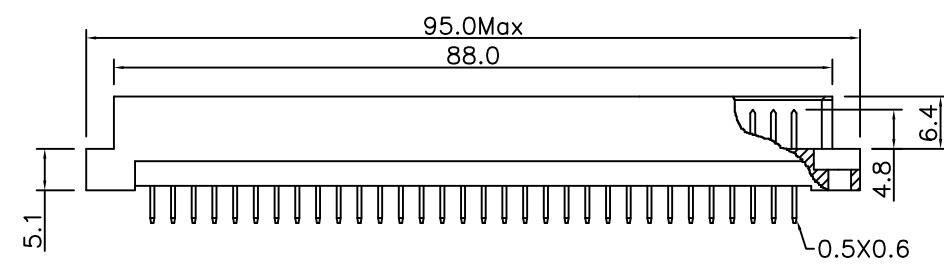
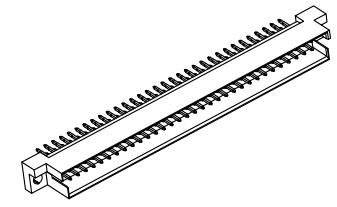
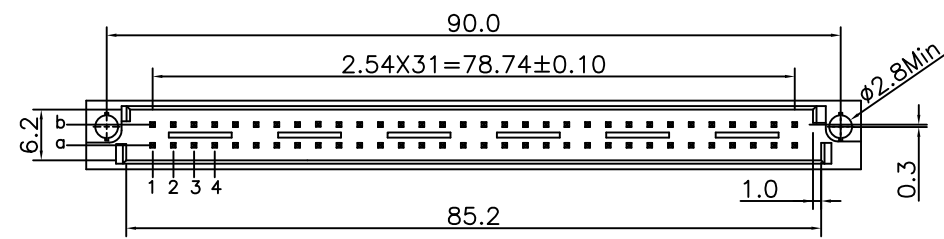

P.C. Board Layout
(Tolerance:±0.05)

9001- 3 3 xx x C xx A
 Series— 3: 2.54mm 4: 5.08mm 3: Male
 Position
 1: Dip Length 2: Dip Length W1: Dip Length W2: Dip Length
 A: Tray Package
 00: G/F 10: 10u" 15: 15u" 30: 30u"
 C: Dip Tin Contact Gold G: Gold Plated

Material and Plating:

Housing: PBT, UL94V-0, Beige
 Contacts: Brass
 Gold Plated on Contact Area and 80u" Min Tin or Gold
 Flash Plated on Solder Tail over 50u" Min Nickel.

Electrical Characteristics:

Current Rating: 2 AMP.
 Dielectric Withstanding Voltage: AC 1000V For 1 minute.
 Insulator Resistance: 1000MΩ min. at DC 500V.
 Contact Resistance: 20mΩ max. at DC 100mA.
 Operating Temperature: -55°C~+125°C.

***RoHS Compliant**

Pitch	Position	Rows with Contacts	Contact Arrange	X length			
				1	2	W1	W2
2.54mm	64	a b		4.0	2.5	13	17
	32	a -					
5.08mm	32	a b					
	16	a -					

Tolerances	Dwg No.	9001D33001	Title:	9001 Series
x = ±0.5	Projection		DIN41612 Q Type Male	
.x = ±0.25	Unit	mm	Scale	1:1
.xx = ±0.15	Drawn By	ZY 04/14'21		

OUPIN			
OUPIN ELECTRONIC(KUNSHAN) CO., LTD.			
P/N: 9001-3(4)3xxxCxxA			
SHEET	1/1	Ver.No.	R5