

REV.	SPECIFICATION	ECN NO.	APPD.
R2		ECN220349	

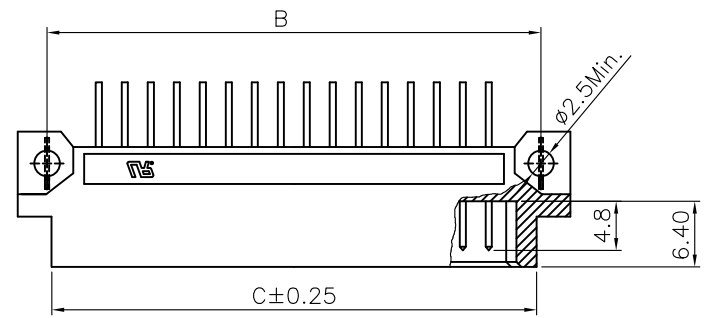

Material and Plating:

Housing: PBT, UL94V-0 , Beige.
 Contacts: Brass.
 Lock: Phosphor Bronze.
 Gold Plated on Contact Area and 80u" Min Tin Plated on Solder Tail over Nickel 50u" Min .

Electrical Characteristics:

Current Rating: 2 AMP.
 Dielectric Withstanding Voltage: AC 1000V For 1 minute.
 Insulator Resistance: 10⁶ MΩ min. at DC 500V.
 Contact Resistance: 20mΩ max. at DC 100mA.
 Operating Temperature: -55°C~+125°C .

***RoHS Compliant**

Notes:

Lock Applicable PCB Board Thickness 1.60mm Min.

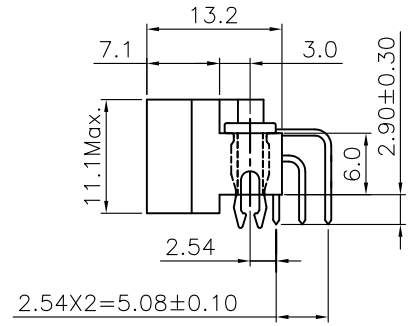

2.54X2=5.08±0.10

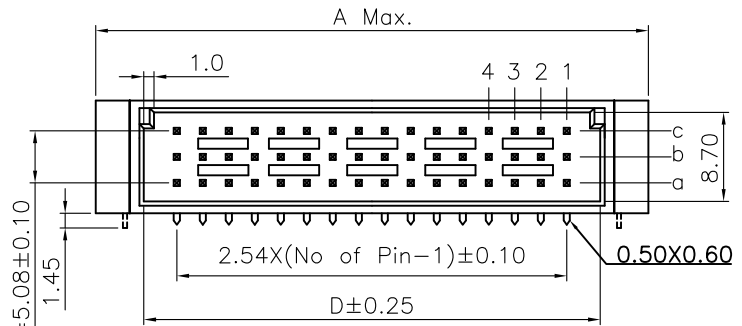

2.54X2=5.08±0.10

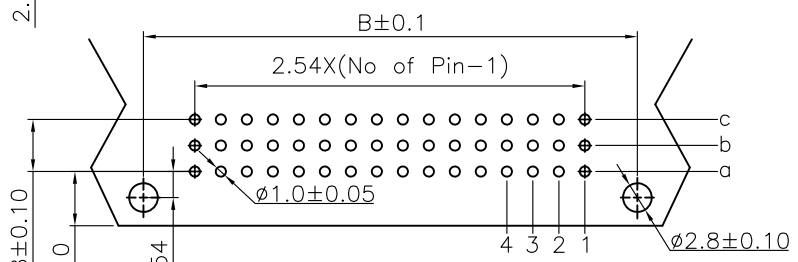

P.C. Board Layout
Tolerance:(± 0.05)

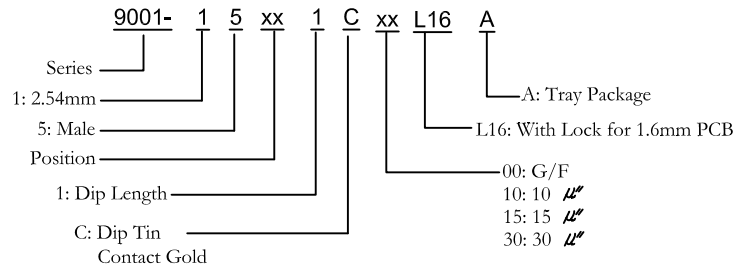

Dimension				
Position	A	B	C	D
48/32/16	54.00	48.26	47.40	44.60
30/20/10	38.10	33.02	32.16	29.36
Pitch	Position	Rows with Contacts	Contact Arrange	P/N
2.54mm	48	a b c		9001-15481C~
	32	a - c		9001-15321C~
	30	a b c		9001-15301C~
	20	a - c		9001-15201C~
	16	a - -		9001-15161C~
	10	a - -		9001-15101C~

Tolerances	Dwg No.	9001D15075		Title:
x = ±0.5	Projection			9001 Series DIN41612 Half C Male Type
.x = ±0.25	Unit mm	Scale	1:1	
.xx = ±0.15	Drawn By	ZY 3/23'22		

OUPIN
 OUPIN ELECTRONIC(KUNSHAN) CO., LTD.
 P/N: 9001-15xx1CxxL16A
 SHEET 1/1 Ver.No. R2