

REV.	SPECIFICATION	ECN NO.	APPD.
R2		ECR180637	

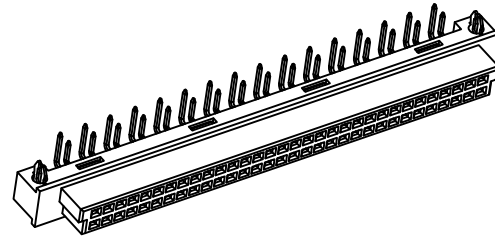
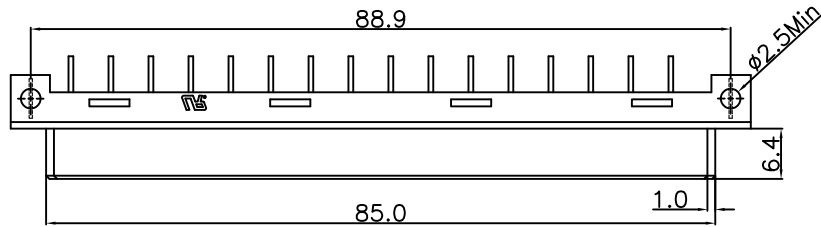

Material and Plating:

Housing: PBT ,Beige,UL94V-0.

Contacts: Phosphor Bronze.

Lock: Phosphor Bronze.

Gold Plated on Contact Area and 80u" Min Tin Plated on Solder Tail over Nickel 50u" Min .

Electrical Characteristics:

Current Rating: 2 AMP.

Dielectric Withstanding Voltage: AC 1000V For 1 minute.

Insulator Resistance: 1000MΩ min. at DC 500V.

Contact Resistance: 30mΩ max. at DC 100mA.

Operating Temperature: -55°C ~+125°C .

***RoHS Compliant**

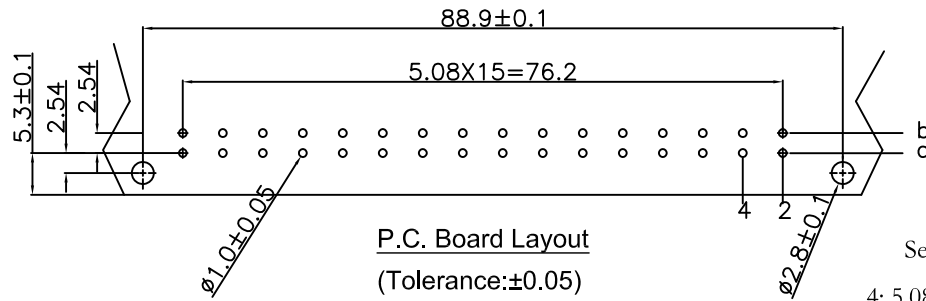
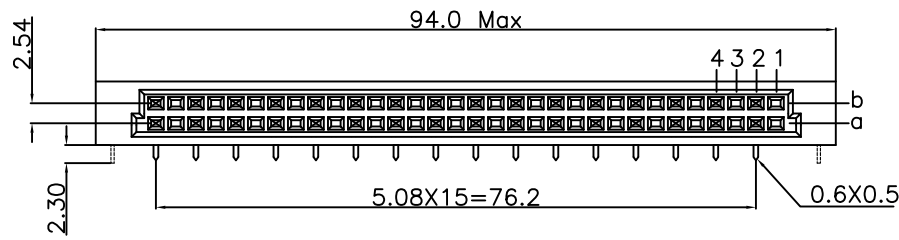
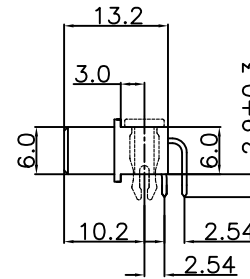

P.C. Board Layout
(Tolerance:±0.05)

9001- 4 4 xx 1 C xx L1 A

Series
4: 5.08mm
4: Female
Position
1: Dip Length

A: Tray Package
Blank: W/O Lock
L1: With Lock
00: G/F
10: 10 μ"
15: 15 μ"
30: 30 μ"
C: Dip Tin
Contact Gold

Pitch	Position	Rows with Contacts	Contact Arrange	P/N
5.08mm	32	a b		9001-44321CxxL1A
	16	a -		9001-44161CxxL1A

Tolerances	Drawn No.	9001D44001
x = ±0.5	Projection	
.x = ±0.25	Unit	mm
.xx = ±0.15	Scale	1:1
	Drawn By	ZJ 06/06"18

Title:
9001 Series
DIN41612
Q Type Female

OUPIN
OUPIN ELECTRONIC(KUNSHAN) CO., LTD.
P/N: 9001-44xx1CxxL1A

SHEET	1/1	Ver.No.	R2
-------	-----	---------	----