

| | | | |
|------|---------------|-----------|-------|
| REV. | SPECIFICATION | ECN NO. | APPD. |
| R3 | | ECN220502 | |

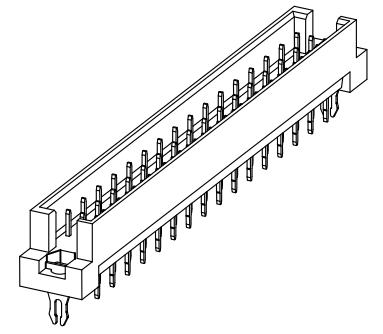
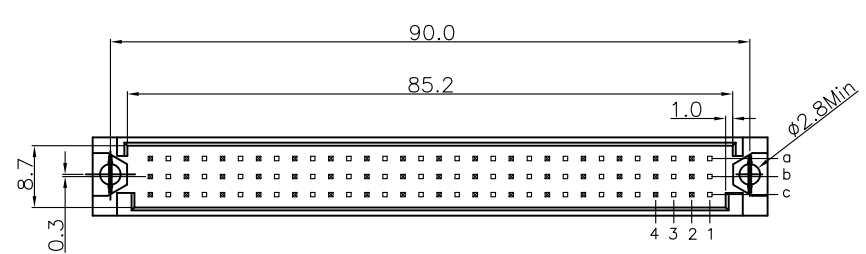

Material and Plating:

Housing: PBT, UL94V-0, Beige
 Contacts: Brass
 Lock: Phosphor Bronze
 Gold Plated on Contact Area and 80u" Min Tin or Gold Flash
 Plated on Solder Tail or Press Fit over Nickel 50u" Min .

Electrical Characteristics:

Current Rating: 2 AMP.
 Dielectric Withstanding Voltage: AC 1000V For 1 minute.
 Insulator Resistance: 10⁶ MΩ min. at DC 500V.
 Contact Resistance: 20mΩ max. at DC 100mA.
 Operating Temperature: -55°C~+125°C .

***RoHS Compliant**

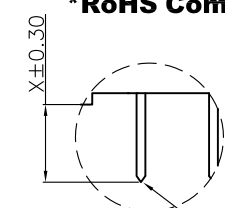
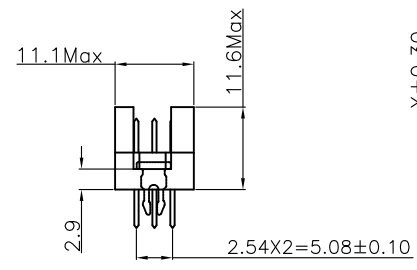
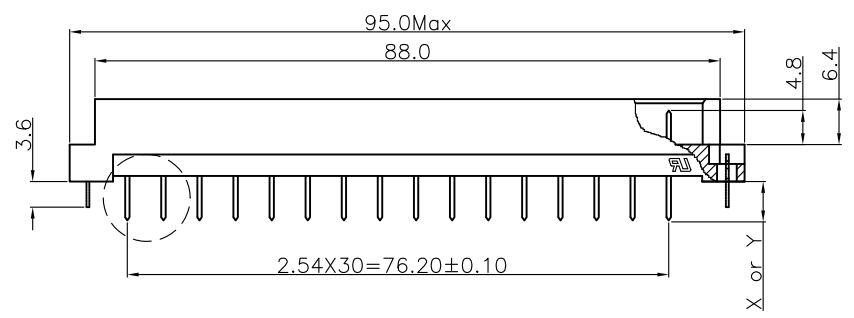

Dip Type

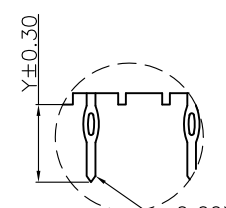

Press Fit Type

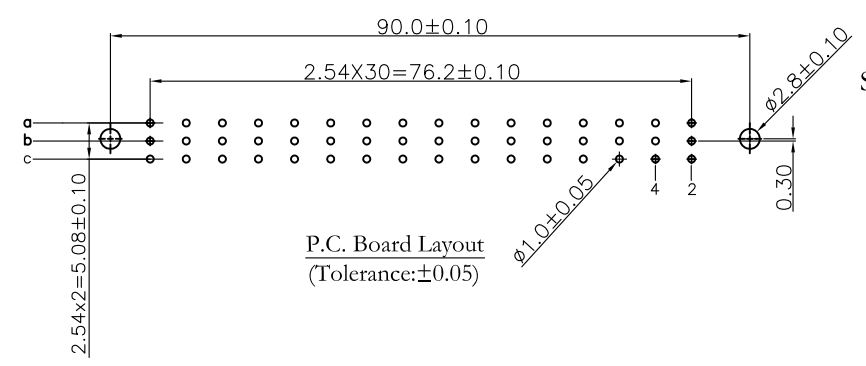

P.C. Board Layout
(Tolerance:±0.05)

9001- 2 3 xx x C xx x L1 A
 Series
 2: 5.08mm
 3: Male
 Position
 1: Dip Length
 2: Dip Length
 W1: Dip Length
 W2: Dip Length
 C: Dip Tin
 Contact Gold
 G: Gold Plated
 A: Tray Package
 Blank: W/O Lock
 L1: With Lock
 Blank: Dip
 P: Press Fit
 00: G/F
 10: 10 μ"
 15: 15 μ"
 30: 30 μ"

| | | | | |
|--------|-----|-----|----|----|
| Length | 1 | 2 | W1 | W2 |
| X | 4.0 | 2.5 | 13 | 17 |
| Y | 4.6 | 6.3 | 13 | 17 |

| Pitch | Pin No. | Rows with Contacts | Contact Arrange |
|--------|---------|--------------------|-----------------|
| 5.08mm | 48 | a b c | |
| | 32 | a - c | |
| | 16 | a - - | |

| | | | | | |
|-------------------|-------------------|-------------|--------------|-------------------------------------|-----|
| Tolerances | Dwg No. | 9001D23005 | | Title: | |
| x = ±0.5 | Projection | | | 9001 Series DIN41612 R Type Male | |
| .x = ±0.25 | Unit | mm | Scale | | 1:1 |
| .xx = ±0.15 | Drawn By | ZY 05/05'22 | | | |

| | | | |
|-------------------------------------|-----|----------------|----|
| OUPIN | | | |
| OUPIN ELECTRONIC(KUNSHAN) CO., LTD. | | | |
| P/N: 9001-23xxxCxxxL1A | | | |
| SHEET | 1/1 | Ver.No. | R3 |