

REV.	SPECIFICATION	ECN NO.	APPD.
R2			

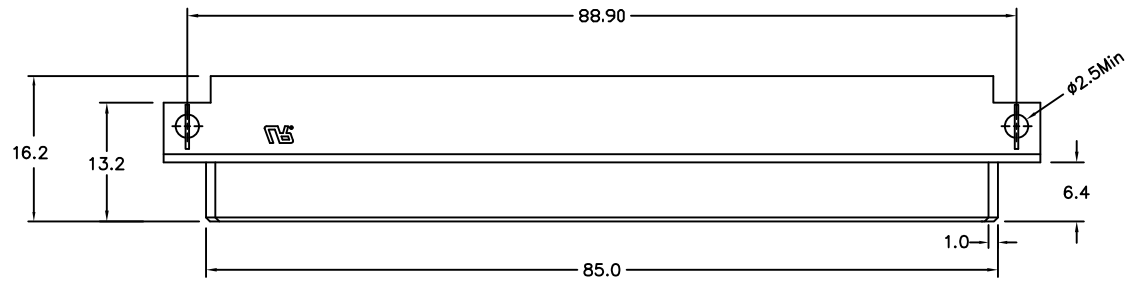

**Material and Plating:**

Housing: PBT, Beige, UL94V-0.  
 Contacts: Phosphor Bronze.  
 Lock: Phosphor Bronze.  
 Gold Plated on Contact Area and 80u" Min Tin Plated on Solder Tail over Nickel 50u" Min.

**Electrical Characteristics:**

Current Rating: 2 A.  
 Dielectric Withstanding Voltage: AC 1000V for 1minute.  
 Insulator Resistance: 1000M $\Omega$  min. at DC 500V.  
 Contact Resistance: 20m $\Omega$  max. at DC 100m A.  
 Operating Temperature: -55°C ~ +125°C .

**\* RoHS Compliant**

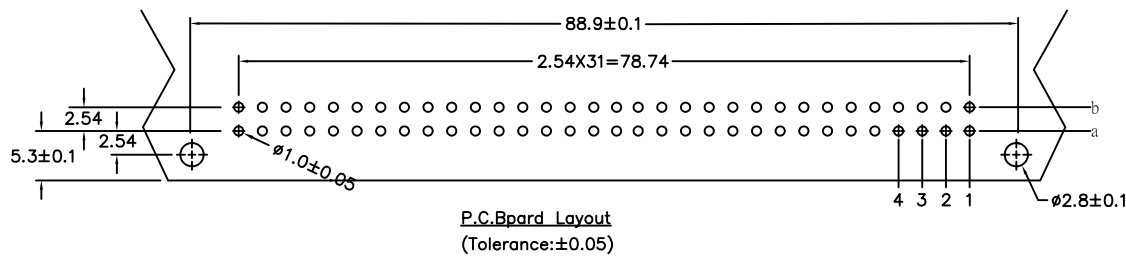
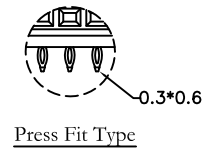
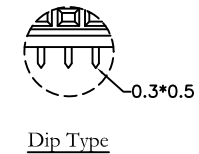
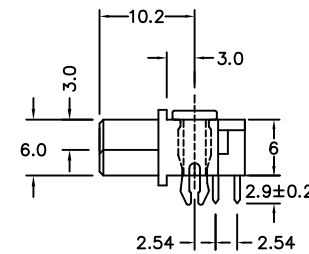
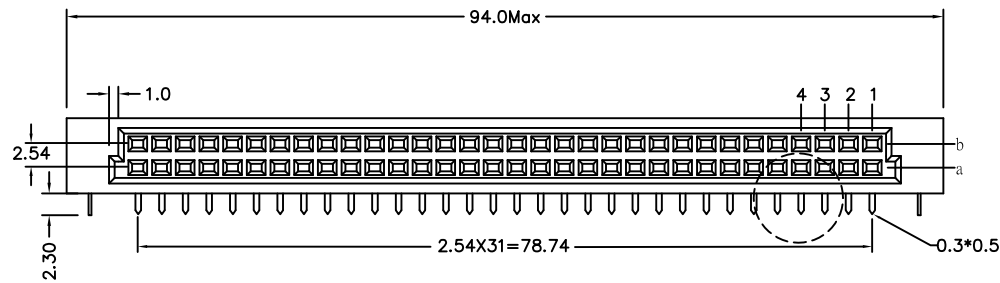

9001-A 3 4 xx 1 C xx P L1 A  
 Series  
 3: 2.54mm  
 4: Female  
 Position  
 1: Dip Length  
 C: Dip Tin Plated  
 Contact Gold Plated  
 G: Gold Plated  
 A: Tray Package  
 Blank: W/O Lock  
 L1: With Lock  
 Blank: Dip Type  
 P: Press Fit Type  
 00: G/F  
 10: 10u"  
 15: 15u"  
 30: 30u"

Pitch	Position	Rows with Contacts	Contact Arrange
2.54mm	64	a b	
	32	a -	
5.08mm	32	a b	
	16	a -	

<b>Tolerances</b>	<b>Dwg No.</b>	9001D34003
x = ±0.5	<b>Projection</b>	
.x = ±0.25	<b>Unit</b> mm	<b>Scale</b> 1:1
.xx = ±0.15	<b>Drawn By</b>	ZJ 06/0718

**Title:**  
 9001-A Series  
 DIN41612 Q Type

<b>OUPIN</b>			
<b>OUPIN ELECTRONIC(KUNSHAN) CO., LTD.</b>			
<b>P/N: 9001-A34xx1CxxxL1A</b>			
<b>SHEET</b>	1/1	<b>Ver. No.</b>	R2