

REV.	SPECIFICATION	ECN NO.	APPD.
R1			

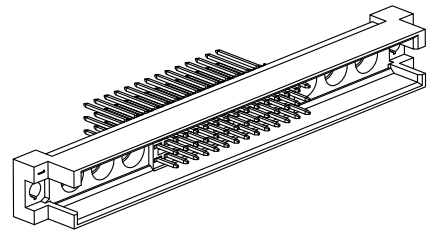

Material:
Housing: Thermoplastic Polyester Glass Filled UL94V-0.
Contacts: Copper Alloy.
Power: Copper Alloy.
Electrical Characteristics:
Current Rating: 2 AMP.
Dielectric Withstanding Voltage: AC 1000V For 1 minute.
Insulator Resistance: 1000MΩ min. at DC 500V.
Contact Resistance: 20mΩ max. at DC 100mA.
Operating Temperature: -55°C ~ +125°C .
***RoHS Compliant**

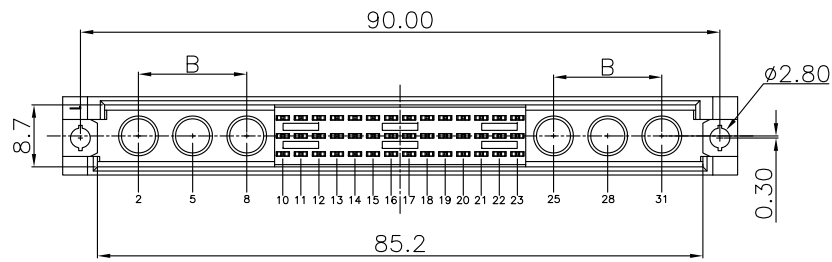
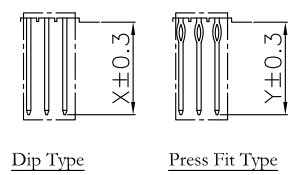
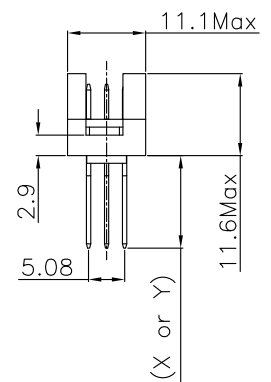
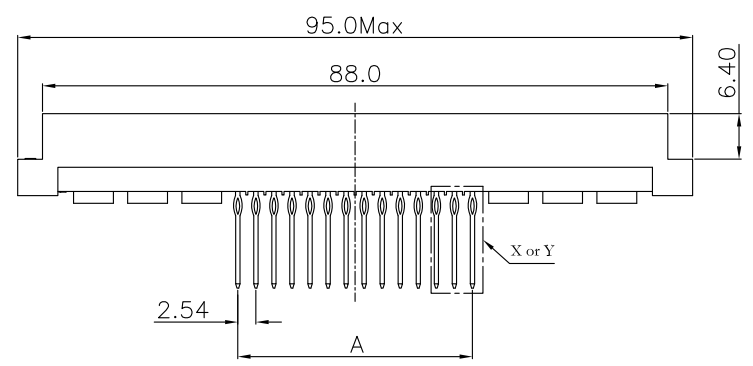

Current Rating(A)	10A	20A	30A	40A
Dimension(φP)	2.10	3.25	3.57	4.15
Length	1	2	W1	W2
X	4.0	2.5	13	17
Y	4.6	6.3	13	17

Dimension
A (2.54 x No of Contact)/3-2.54
B (7.62 x No of Coaxial)/2-7.62

Pitch	Position	Rows with Contacts	Contact Arrange	With Power
2.54mm	78	a b c		2 Pcs
	60	a b c		4 Pcs
	42	a b c		6 Pcs
	24	a b c		8 Pcs
	6	a b c		10 Pcs
	52	a - c		2 Pcs
	40	a - c		4 Pcs
	28	a - c		6 Pcs
	16	a - c		8 Pcs
	4	a - c		10 Pcs

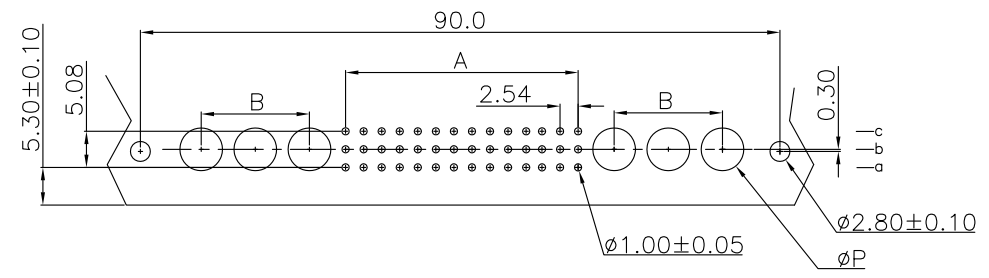

P.C. Board Layout (Power)

9001- 9 3 xx xx x C xx x A
Series: 9001-
3: Male
Position: 9
xx: 02: With 2 Power
04: With 4 Power
06: With 6 Power
08: With 8 Power
10: With 10 Power
C: Selective Gold Plated
xx: 00: G/F
10: 10μ"
15: 15μ"
30: 30μ"
A: Tray Package
D: Dip Type
P: Press Fit Type
1: Dip Length
2: Dip Length
W1: Dip Length
W2: Dip Length
G: Gold Plated

Tolerances	Dwg. No.	9001D93001	Title:	9001 Series DIN41612 M Type Male
x = ±0.5	Projection			
.x = ±0.25	Unit	mm		
.xx = ±0.15	Scale	1:1		
	Drawn By	ZJJ 09/19'12		

OUPIN			
OUPIN ELECTRONIC(KUNSHAN) CO., LTD.			
P/N: 9001-93xxxxCxxxA			
SHEET	1/1	Ver.No.	R1