

REV.	SPECIFICATION	ECN NO.	APPD.
R6		ECN141105	

Material:

Housing: High Temperature Plastic UL94V-0
 Contacts: Copper Alloy.

Electrical Characteristics:

Current Rating: 1 AMP.
 Dielectric Withstanding Voltage: AC 1000V For 1 minute.
 Insulator Resistance: 1000MΩ min. at DC 500V.
 Contact Resistance: 30mΩ max. at DC 100mA.
 Operating Temperature: -55°C~+125°C .

***RoHS Compliant**

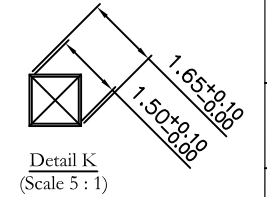
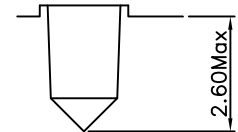
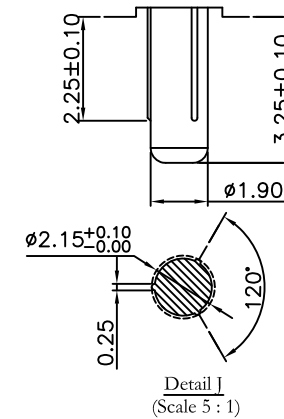
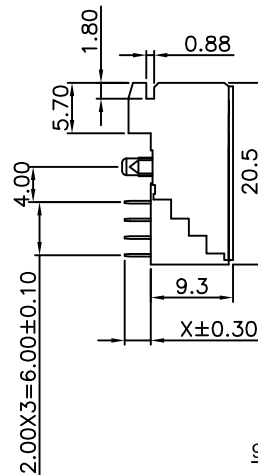
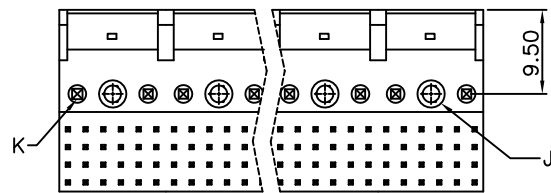
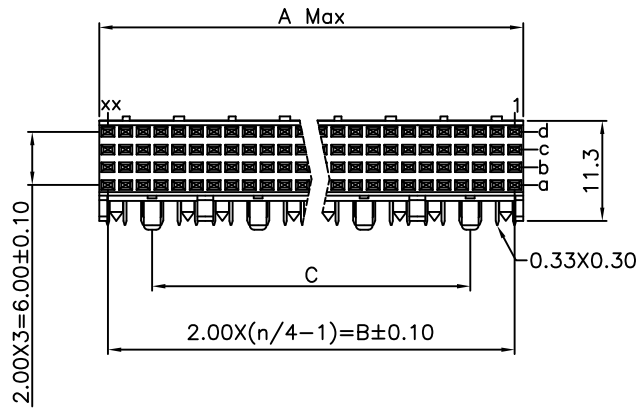
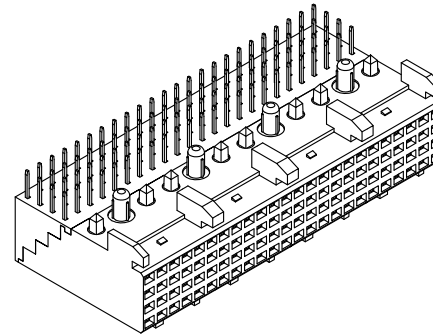

Detail K
(Scale 5 : 1)

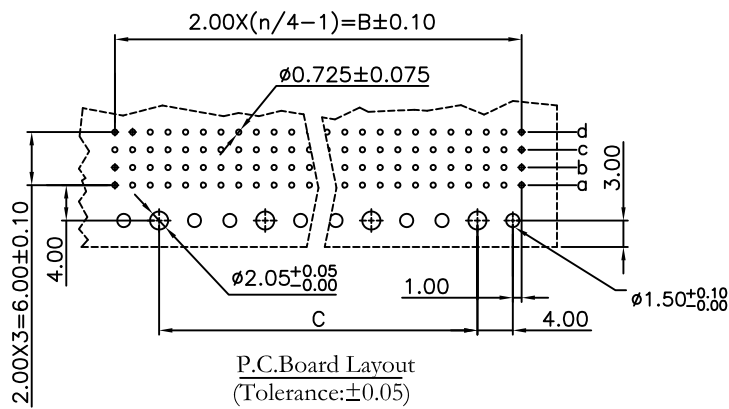

P.C.Board Layout
(Tolerance:±0.05)

- Series: 9111- 4 2 xx x C xx D U
- 4: 4Rows
- 2: Female Signal
- Position: 1: Dip Length, 2: Dip Length
- U: Tube Package
- D: Dip Type
- 10: 10 μ "
- 30: 30 μ "
- C: Dip Tin Plated
- Contact Gold Plated
- G: Gold Plated
- CM: Dip Tin(Matte Tin)
- Contact Gold

X Length	1	2
	2.90	3.53

Position (n)	Dimension		
	A	B	C
24	11.95	10.0	0
48	23.95	22.0	12.0
72	35.95	34.0	24.0
96	47.95	46.0	36.0
120	59.95	58.0	48.0
144	71.95	70.0	60.0
168	83.95	82.0	72.0
192	95.95	94.0	84.0

Tolerances	Dwg. No.	9111D42001	Title:	
x = ±0.5	Projection		9111 Series	
.x = ±0.25	Unit	mm	Scale	1:1
.xx = ±0.15	Drawn By	W G 10/15"14	H.D. Female 2.0mm Dip Type 4 Rows	

OUPIN			
OUPIN ELECTRONIC(KUNSHAN) CO., LTD.			
P/N: 9111-42xxxCxxDU			
SHEET	1/1	Ver.No.	R6