

REV.	SPECIFICATION	ECN NO.	APPD.
X2			

Material and Plating:

Housing: PBT, Bdige, UL94V-0

Contacts: Brass

Gold Plated on Contact Area and 80u" Min Tin Plated on solder tail over Nickel 50u" Min

Electrical Characteristics:

Current Rating: 1 AMP.

Dielectric Withstanding Voltage: AC 750V For 1 minute.

Insulator Resistance: 10000MΩ min. at DC 500V.

Contact Resistance: 20mΩ max. at DC 100mA.

Operating Temperature: -55°C~+125°C .

***RoHS Compliant**

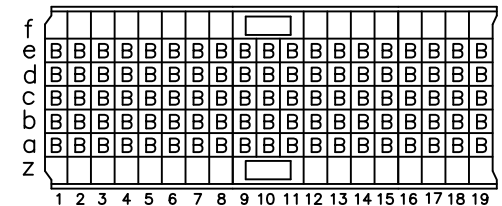
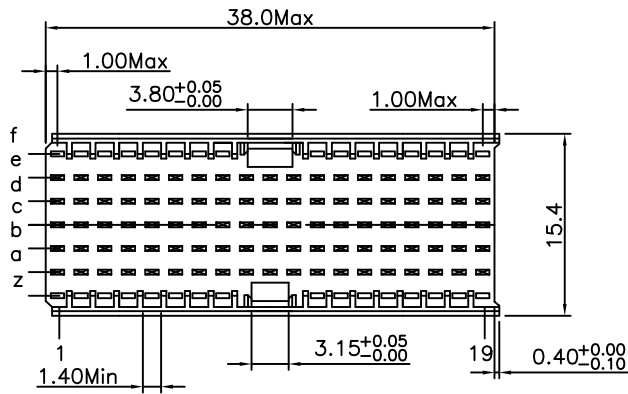

CONTACT LAYOUT

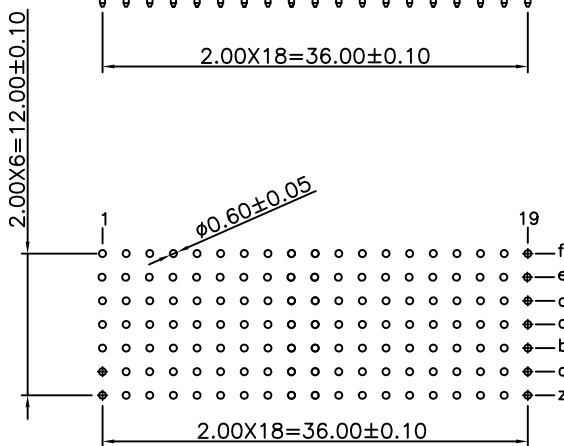
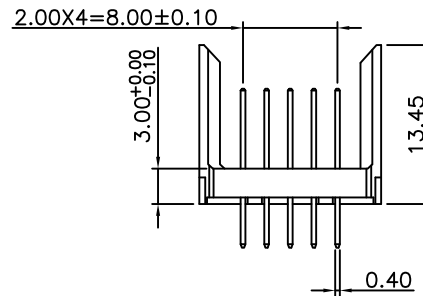
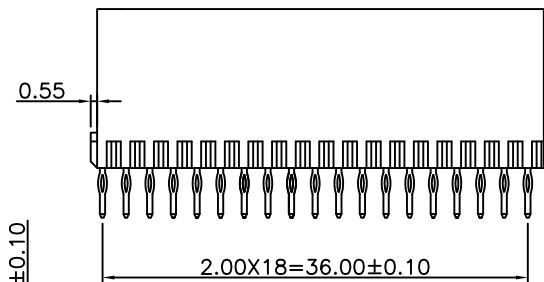
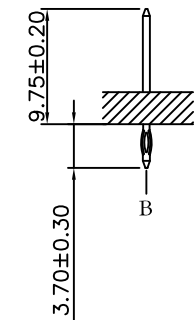

P.C. Board Layout
(Top View)

9111- 7 1 AB 127 J CB xx U
 Series: 9111-7
 7Row: 7
 1: Male
 AB: Type AB
 Housing Type: J
 J: J Option
 CB: Dip Tin Plated
 Contact Au+Pd/Ni Plated
 G: Gold Plated
 U: Tube Package
 10: 10 u"
 30: 30 u"

PROPOSAL ONLY

Tolerances	Dwg. No.	9111D71228	
x = ±0.5	Projection	⊕ ⊖	
.x = ±0.25	Unit	mm	Scale 1:1
.xx = ±0.15	Drawn By	ZJ 04/24'18	

Title: 9111 Series
 2.00 Hard Metric
 Connectors Male
 Type AB-19

OUPIN			
OUPIN ELECTRONIC(KUNSHAN) CO., LTD.			
P/N: 9111-71AB127JCBxxU			
SHEET	1/1	Ver.No.	X2