

REV.	SPECIFICATION	ECN NO.	APPD.
R5		ECN170302	

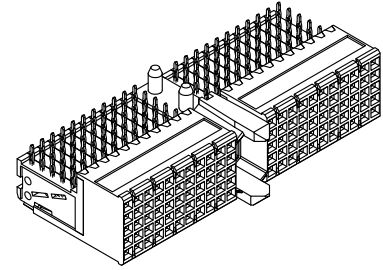
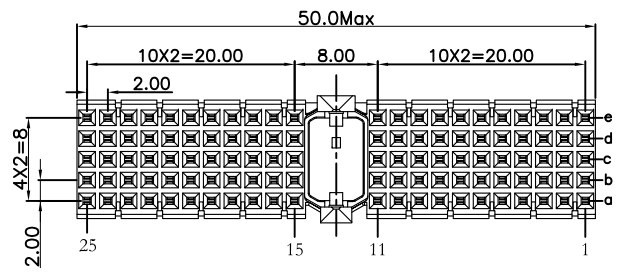

Material:

Housing: Thermoplastic Polyester Glass Filled UL94V-0.
 Contacts: Copper Alloy

Electrical Characteristics:

Current Rating: 1 AMP.
 Dielectric Withstanding Voltage: AC 750V For 1 minute.
 Insulator Resistance: 10000MΩ min. at DC 500V.
 Contact Resistance: 20mΩ max. at DC 100mA.
 Operating Temperature: -55°C ~+125°C .

***RoHS Compliant**

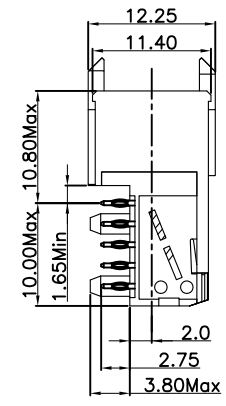
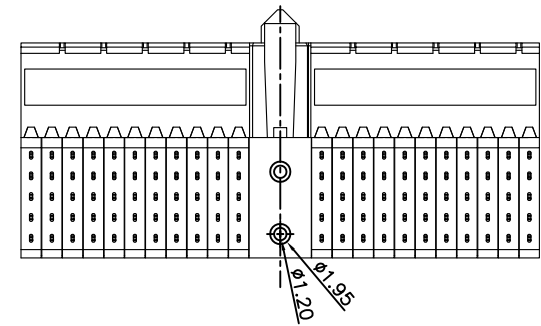

None Shielded

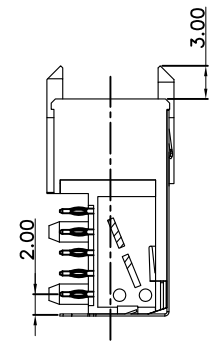

With Top Body Shielded

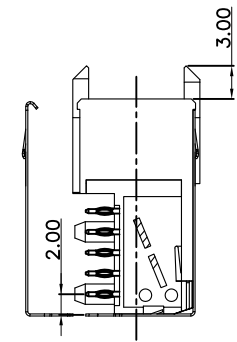

With Top Body Shielded and Bottom Shielded

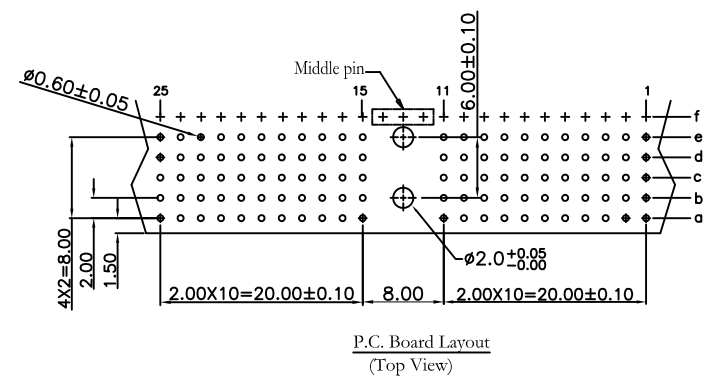

P.C. Board Layout
(Top View)

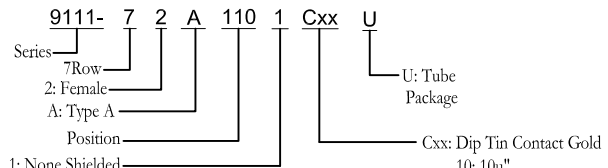

- 1: None Shielded
- 2: Top Body Shielded
- 3: Top Body Shielded and Bottom Shielded (Package Separately)
- 4: Same as 2 but with middle pin
- 5: Same as 3 but with middle pin

Tolerances	Dwg. No.	9111D72001
x = ±0.5	Projection	
.x = ±0.25	Unit	mm
.xx = ±0.15	Scale	1:1
	Drawn By	IQ 03/02'17

Title:
 9111 Series
 Hard Metric Connector
 Female Right Angle Type A

OUPIN			
OUPIN ELECTRONIC(KUNSHAN) CO., LTD.			
P/N: 9111-72A110xCxxU			
SHEET	1/1	Ver.No.	R5