

REV.	SPECIFICATION	ECN NO.	APPD.
X4			

Material:

Housing: High Temperature Plastic UL94V-0.

Contacts: Copper Alloy

Electrical Characteristics:

Current Rating: Power Pin 30 AMP.

Dielectric Withstanding Voltage:

Power Pin DC 1500V For 1 minute.

Contact Resistance: Power Pin 20mΩ max. at DC 20mA.

Operating Temperature: -40°C ~+105°C .

***RoHS Compliant**

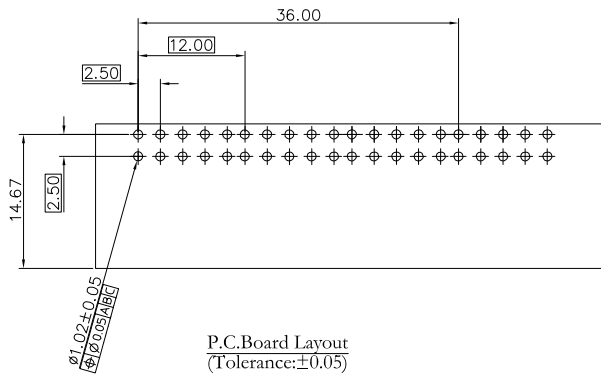
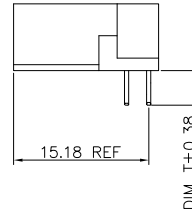
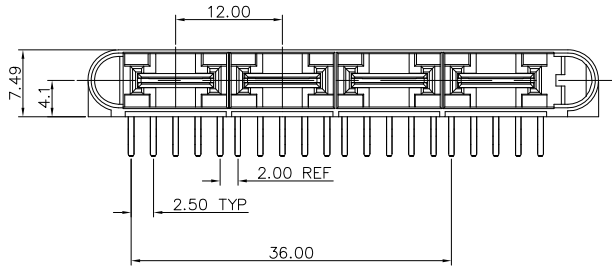
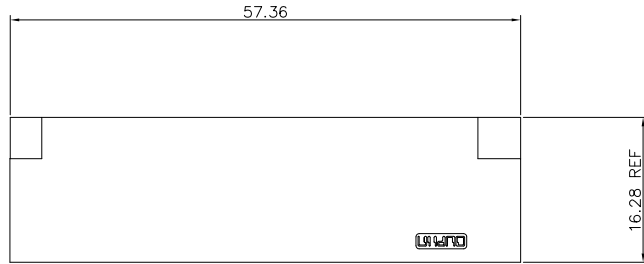

- Series — 9392- 1 P08 N X X Cxx D A
- 1:Male Right Angle
 - P08:Power Contact
 - N:Without Post
 - 1: None Lead Trough
 - 2: With Lead Trough
 - 3: With Left Lead Trough
 - A:Tray Package
 - D:Dip Type
 - CB30: Dip Tin Plated Contact Au+Pd/Ni Plated 30: 30 u"
 - C:Selective Gold Plated 10: 10 u" 30: 30 u"
 - 1: Dim T=2.50mm
 - 2: Dim T=2.90mm
 - 3: Dim T=3.60mm
 - 4: Dim T=4.50mm
 - 5: Dim T=3.90mm

Tolerances	Dwg. No.	9392-D0000-018		Title:		
x = ±0.5	Projection			9392 Series Low Profile Hybrid Power Plug		
.x = ±0.25	Unit	mm	Scale			1:1
.xx = ±0.15	Drawn By	LQ	05/23'17			

OUPIIN ELECTRONIC(KUNSHAN) CO., LTD.			
P/N: 9392-1P08NxxCxxDA			
SHEET	1/1	Ver. No.	X4