

TOP LAYER DESCRIPTION	TABLE 1 PLATED THROUGH-HOLE REQUIREMENTS								FINISHED HOLE DIAMETER
	DRILLED HOLE DIAMETER	COPPER THICKNESS	TIN-LEAD THICKNESS	NICKEL THICKNESS	GOLD THICKNESS	TIN THICKNESS	SILVER THICKNESS	COPPER THICKNESS	
TIN-LEAD	0.81-0.86<0.85 DRILL>	0.025-0.050	0.005-0.015			0.9-1.5um			0.65-0.80
IMMERSION TIN	0.81-0.86<0.85 DRILL>	0.025-0.050							0.70-0.80
IMMERSION SILVER	0.81-0.86<0.85 DRILL>	0.025-0.050					0.15-0.65um		0.70-0.80
COPPER	0.81-0.86<0.85 DRILL>	0.025-0.050						0.003 MAX	0.70-0.80
GOLD	0.81-0.86<0.85 DRILL>	0.025-0.050		0.003-0.007	FLASH UP TO 0.0002				0.69-0.80

REV.	SPECIFICATION	ECN NO.	APPD.
R10		ECN170120	

### Material:

Housing: High Temperature Plastic, UL94V-0.

Contacts: Copper Alloy.

### Electrical Characteristics:

Current Rating: 20 AMP@75°C ambient.

Dielectric Withstanding Voltage: AC 1500V For 1 minute.

Insulator Resistance: 10000MΩ min. at DC 500V.

Contact Resistance: 1.0mΩ max.

Operating Temperature: -55°C~+105°C.

**\*RoHS Compliant**

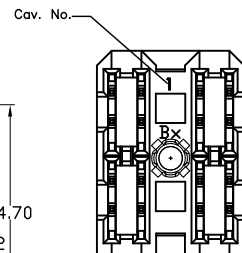
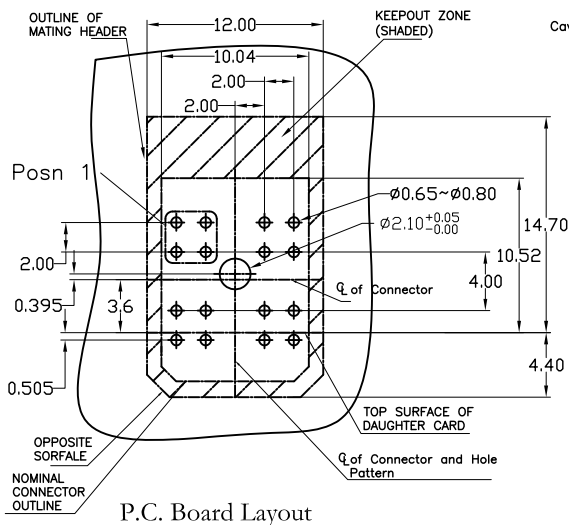
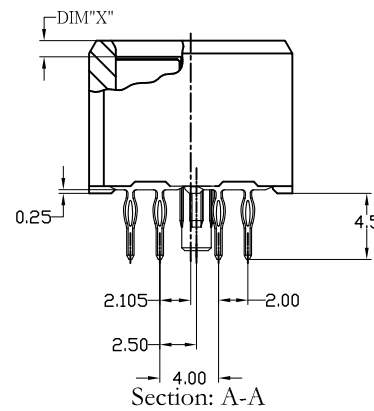
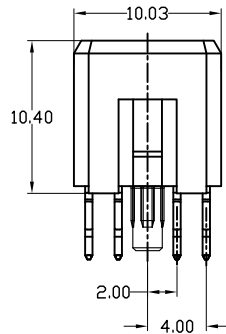
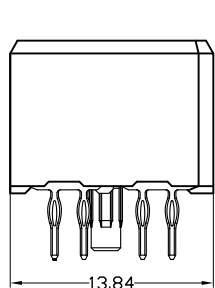
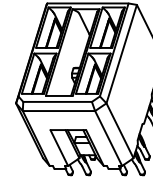
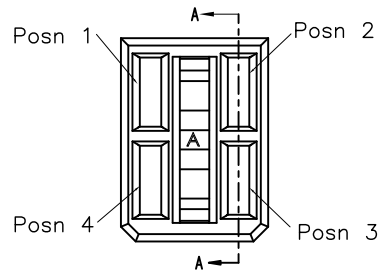

Series: 9114 - 2 x 2 Cxx P P x A  
 Position Per Column: P P x A  
 Column No.: P P x A  
 Cxx: Selective Gold Plated  
 00: 00μ"  
 10: 10μ"  
 15: 15μ"  
 30: 30μ"  
 CB30: Dip Tin  
 Contact Au+Pd/Ni  
 30: 30μ"

A: Tray Packaging  
 1~9 Type  
 P: With Post  
 N: Without Post  
 Press fit Type

**Available Product				
Product No.	DIM "X"			
	Posn 1	Posn 2	Posn 3	Posn 4
• 9114-2X2CxxPx1A	1.40	1.40	1.40	1.40
9114-2X2CxxPx2A	2.60	2.60	2.60	2.60
• 9114-2X2CBxxPx3A	1.40	2.60	2.60	2.60
9114-2X2CxxPx4A	2.60	1.40	2.60	2.60
9114-2X2CxxPx5A	2.60	2.60	1.40	2.60
9114-2X2CxxPx6A	2.60	2.60	2.60	1.40
• 9114-2X2CxxPx7A	1.40	2.60	2.60	1.40
• 9114-2X2CxxPx8A	1.40	1.40	2.60	2.60
• 9114-2X2CxxPx9A	2.60	2.60	1.40	1.40

Tolerances	Dwg. No.	9114-D0000-001	Title:	9114 Series
.x = ±0.3	Projection		9114 Series	2.00mm Pitch Power Conn.
.xx = ±0.10	Unit	mm	Scale	1:1
.xxx = ±0.05	Drawn By	Frank 1/18'17		

<b>OUPIN</b>			
OUPIN ELECTRONIC(KUNSHAN) CO., LTD.			
P/N: 9114-2x2CxxPPxA			
SHEET	1/1	Ver.No.	R10