

REV.	SPECIFICATION	ECN NO.	APPD.
R2		ECN231036	

Material and Plating :

Housing: High Temperature Plastic UL94V-0.
 Power Contacts: High Conductivity Copper .
 30u" Au+Pd/Ni on Contact Area and 80u" Min
 Tin Plated on Press Fit over 50u" Min Nickel.
 Signal Contacts: Phosphor Bronze .
 30u" Au+Pd/Ni on Contact Area and 80u" Min
 Tin Plated on Press Fit over 50u" Min Nickel.

Electrical Characteristics:

Current Rating: 1 AMP/Signal pin.
 25 AMP/AC Power pin .
 100 AMP/DC Power pin.
 Dielectric Withstanding Voltage: DC Power: 2000V AC For 1 minute.
 AC Power: 2000V AC For 1 minute.
 Signal Pin: 500V For 1 minute.
 Between AC Power pin and Signal pin:
 3000 VAC For 1 minute.
 Between AC Power pin and PE Power pin:
 2000 VAC For 1 minute.
 Between PE Power pin and Signal pin:
 1000 VAC For 1 minute.
 Insulator Resistance: Power:5000MΩ min.
 Signal: 500MΩ min.
 Between all power conductors 500MΩ min.
 Contact Resistance: Power pin : AC Power:5mΩ max
 DC Power:1mΩ max.
 Signal pin : 25mΩ max.
 Operating Temperature: -40°C~+115°C.

***RoHS Compliant**

RDWS	DC POWER			SIGNAL	AC POWER		
	P1	P2	P3		P4	P5	P6
B	PL	PL	PL		PL	PS	PS
A	PL	PL	PL		PL	PS	PS

POWER CONTACT TO THE A FACE DISTANCE 7.95mm,	PS
POWER CONTACT TO THE A FACE DISTANCE 8.95mm,	PL
SIGNAL CONTACT TO THE A FACE DISTANCE 8.95mm,	L

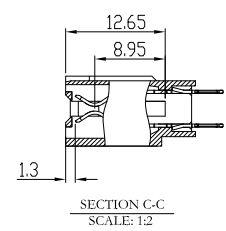
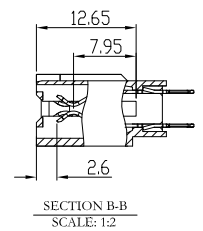
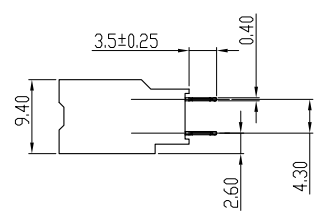
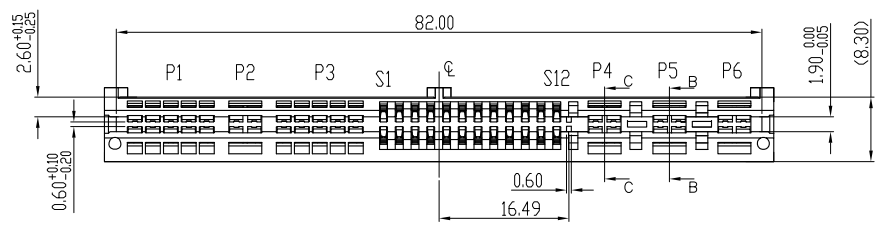
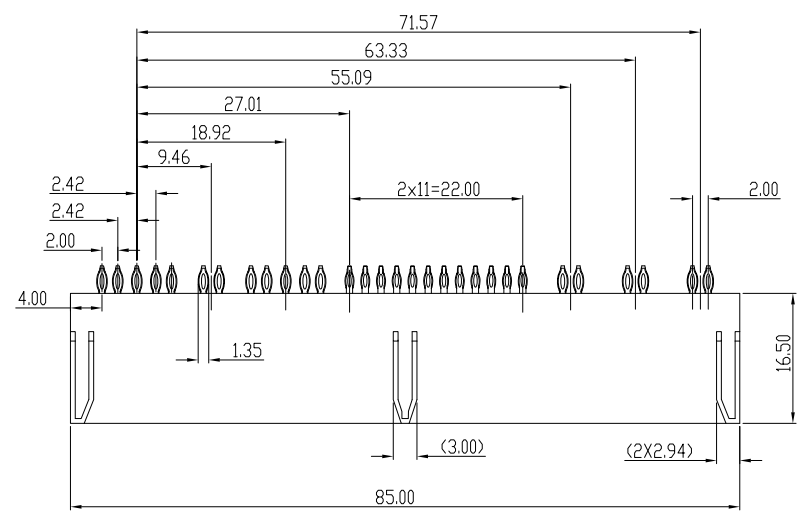
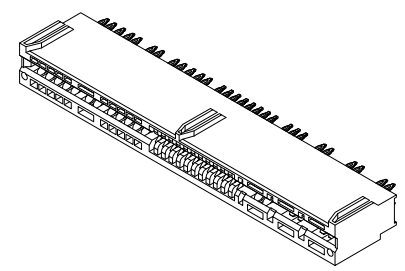

9394- 2 A2 N 1 2 1 A CB 30 P A

Series: 2:Female Straight
 A2:Type A2
 See Table: P:Without Post, N:With Post
 DIM T=3.5mm
 1.DIM GAP=1.00mm, 2.DIM GAP=0.60mm
 A:Signal Pitch 2.0mm, B:Signal Pitch 2.54mm
 1:W/O Left Key,With Right Key
 A:Tray Package, P: Press Fit Type
 30: 30 u"
 CB: Contact Au+Pd/Ni,Dip Tin
 C: Selective Gold Plated
 G: Gold Plated

Tolerances	Dwg. No.	9394-D0000-008	Title:		 OUPIN ELECTRONIC(KUNSHAN) CO., LTD. P/N: 9394-2A2N121ACB30PA SHEET 1/2 Ver.No. R2
x.=±0.50	Projection		9394 Series HYBRID POWER CARD EDGE PRESS FIT LOW PROFILE		
.x=±0.25	Unit	mm	Scale	1:1	
.xx=±0.15	Drawn By	GYJ 11/02'23			
.xxx=±0.10					

REV.	SPECIFICATION	ECN NO.	APPD.
R2		ECN231036	

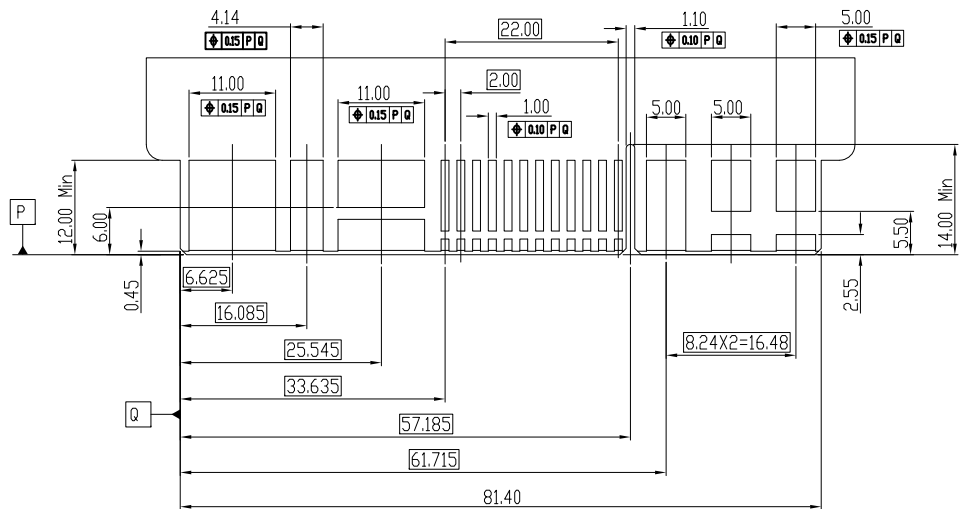

RECOMMENDED MATTING BOARD FOOTPRINT
(Tolerance: ±0.05)

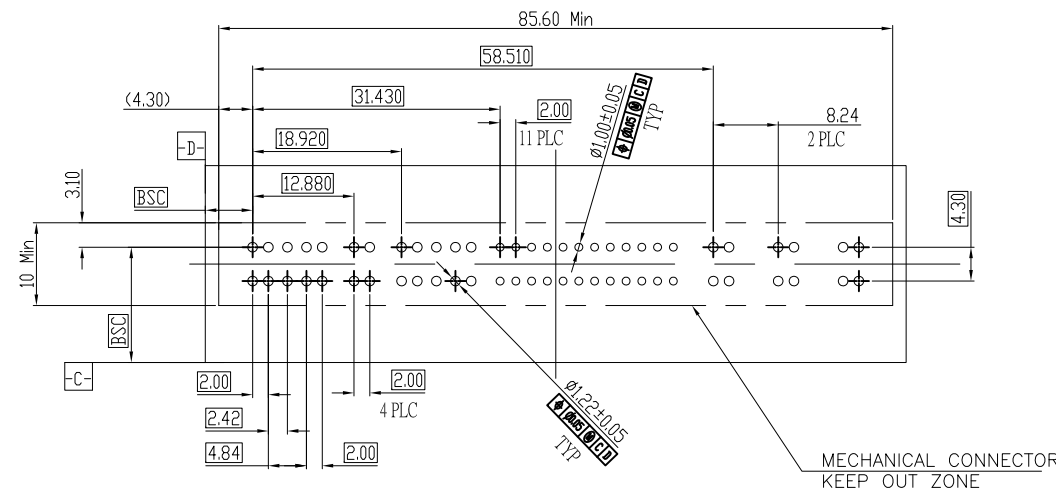

P.C Board Layout
Tolerance: ±0.05mm

Tolerances	Dwg. No.	9394-D0000-008	Title:
x.=±0.50	Projection		9394 Series HYBRID POWER CARD EDGE PRESS FIT LOW PROFILE
.x=±0.25	Unit	mm	
.xx=±0.15	Scale	1:1	
.xxx=±0.10	Drawn By	GYJ 11/02'23	

OUPIIN ELECTRONIC(KUNSHAN) CO., LTD.			
P/N: 9394-2A2N121ACB30PA			
SHEET	2/2	Ver. No.	R2

OUPIIN ELECTRONIC(KUNSHAN) CO., LTD.			
P/N: 9394-2A2N121ACB30PA			
SHEET	2/2	Ver. No.	R2