

REV.	SPECIFICATION	ECN NO.	APPD.
R5		ECN211220	

**Material and Plating:**

Housing: LCP,UL94V-0 , BLACK.  
 Contacts : High performance Copper Alloy  
 Gold Plated on Contact Area and 80u" Min Tin  
 Plated on solder tail over Nickel 50u" Min.

**Electrical Characteristics:**

Current Rating: 3.1 AMP.  
 Dielectric Withstanding Voltage: AC 600V For 1 minute.  
 Insulator Resistance: 6000MΩ min. at DC 250V.  
 Contact Resistance: 8.4mΩ max. at DC 100mA.  
 Operating Temperature: -55°C~+125°C.

**\*RoHS Compliant**

Insertion Depth: 3.15mm To 5.55mm.  
 Speed:28+Gbps @-3dB.

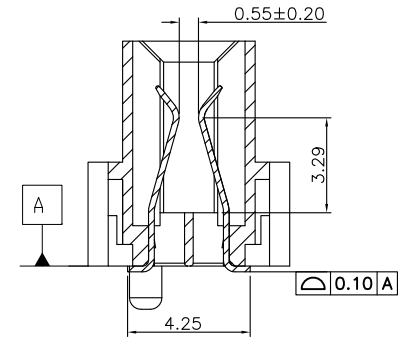
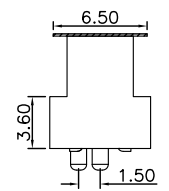
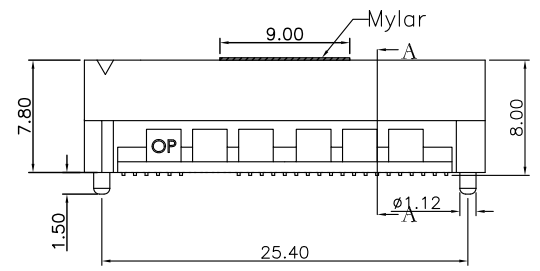
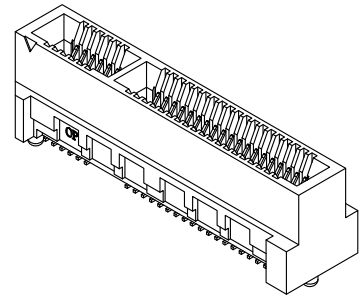
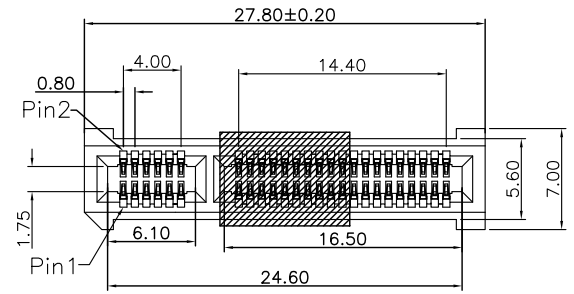

Section A-A  
 Scale 2:1

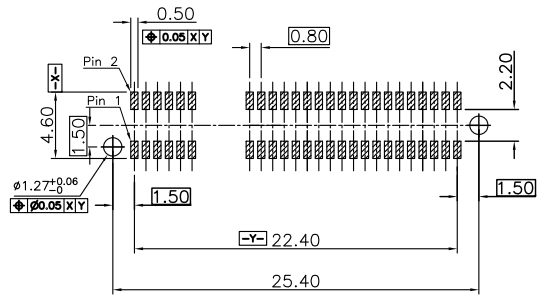

P.C. Board Layout  
 (Tolerance ±0.05)

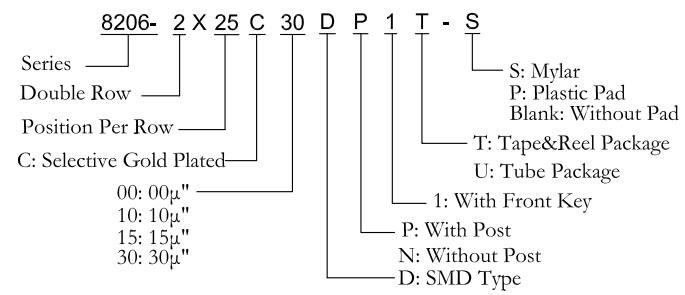

Tolerances	Dwg. No.	8206-D0000-016		Title:	
x = ±0.50	Projection	⊕ ↯		8206 Series Edge Card Connector 0.80mm (0.0315") Pitch SMD Type	
.x = ±0.25	Unit	mm	Scale		1:1
.xx = ±0.15	Drawn By	ZY 12/23'21			

<b>OUPIN</b>			
OUPIN ELECTRONIC(KUNSHAN) CO., LTD.			
P/N: 8206-2X25C30DP1T-S			
SHEET	1/2	Ver.No.	R5

REV.	SPECIFICATION	ECN NO.	APPD.
R5		ECN211220	

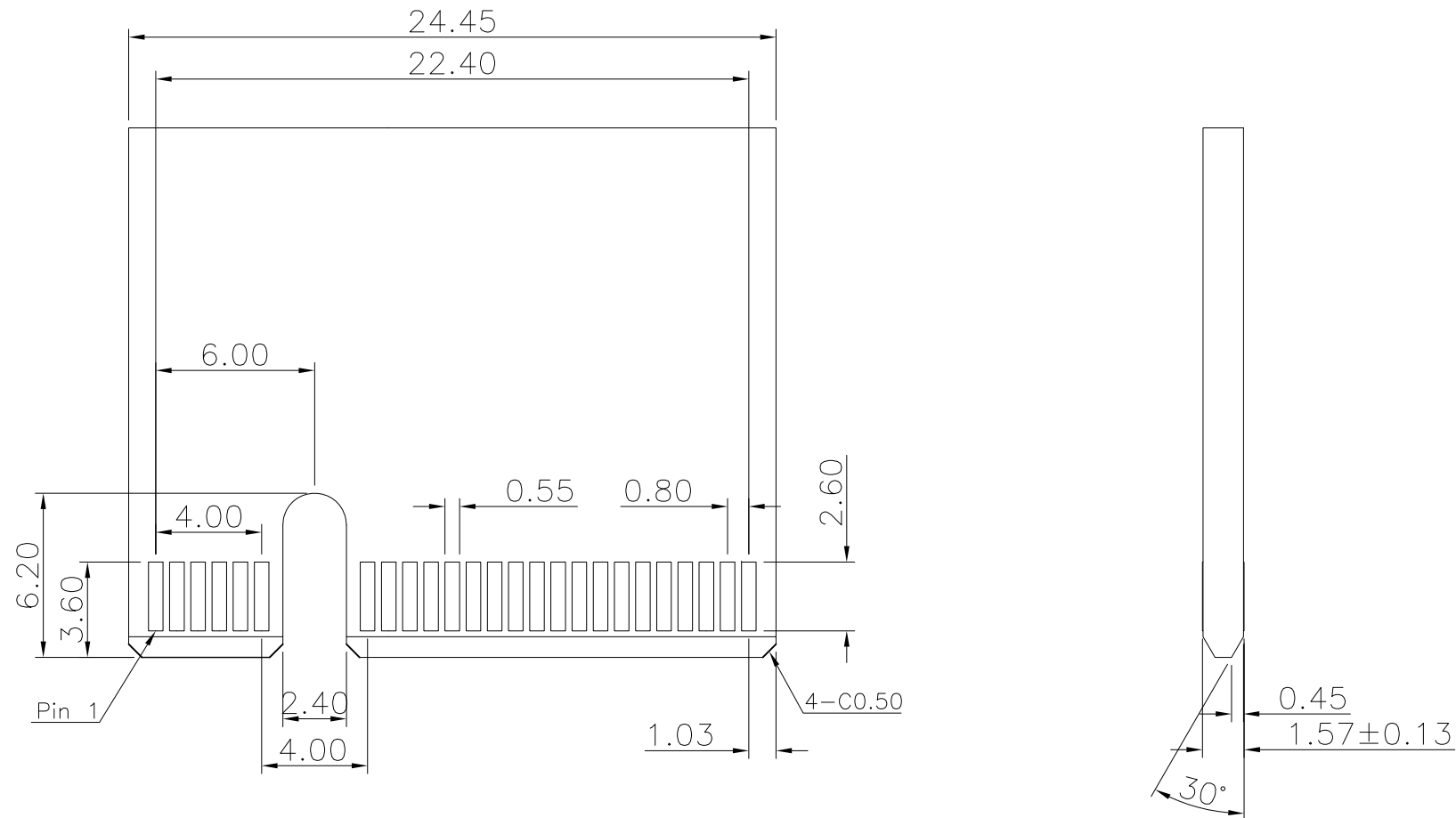

**RECOMMENDED MATTING BOARD FOOTPRINT**  
(Tolerance: ±0.05)

Tolerances	Dwg.No.	8206-D0000-016	Title:		<b>OUPIN</b> OUPIN ELECTRONIC(KUNSHAN) CO., LTD.
x = ±0.50	Projection	⊕ ↯	8206 Series Edge Card Connector		
.x = ±0.25	Unit	mm	Scale	1:1	P/N: 8206-2X25C30DP1T-S
.xx = ±0.15	Drawn By	ZY 12/23'21	0.80mm (0.0315") Pitch SMD Type		SHEET 2/2
					Ver.No.
					R5