

REV.	SPECIFICATION	ECN NO.	APPD.
R4		ECN211220	

**Material and Plating:**

Housing: LCP, UL94V-0 , BLACK.  
 Contacts : High performance Copper Alloy  
 Gold Plated on Contact Area and 80u" Min Tin  
 Plated on solder tail over Nickel 50u" Min.

**Electrical Characteristics:**

Current Rating: 3.1 AMP.  
 Dielectric Withstanding Voltage: AC 600V For 1 minute.  
 Insulator Resistance: 6000MΩ min. at DC 250V.  
 Contact Resistance: 8.4mΩ max. at DC 100mA.  
 Operating Temperature: -55°C~+125°C.

**\*RoHS Compliant**

Insertion Depth: 3.15mm To 5.55mm.  
 Mates With: 1.6±0.05mm Thick Edge Card.  
 Speed: 28+Gbps @-3dB.

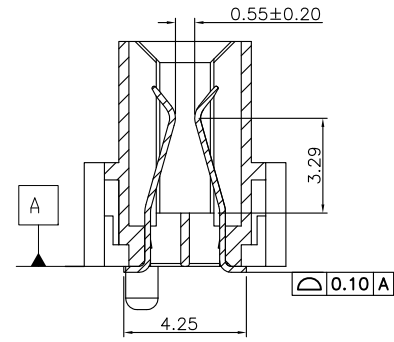
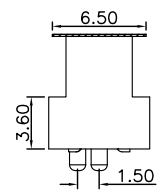
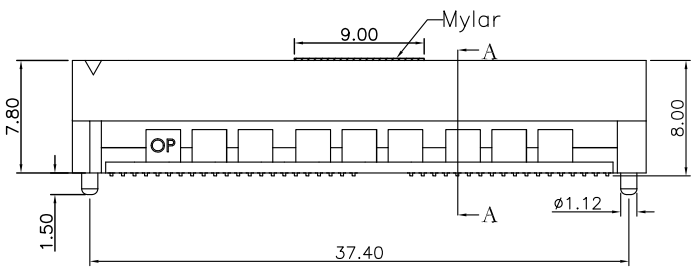
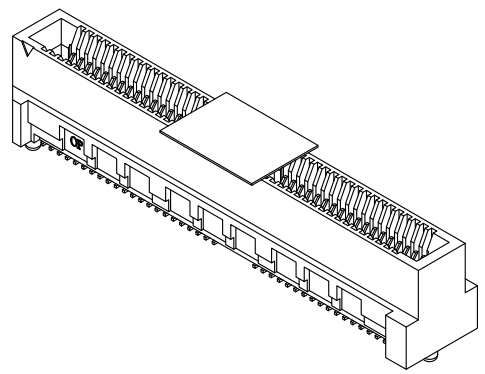
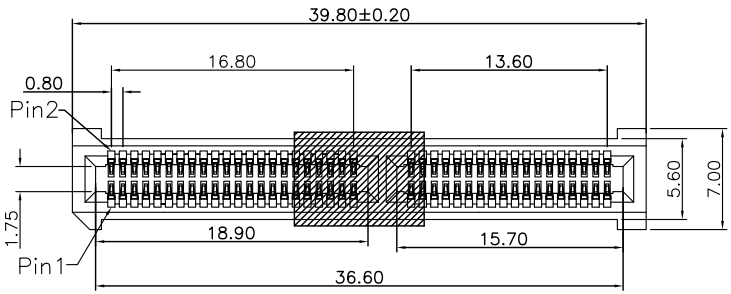

Section A-A  
Scale 2:1

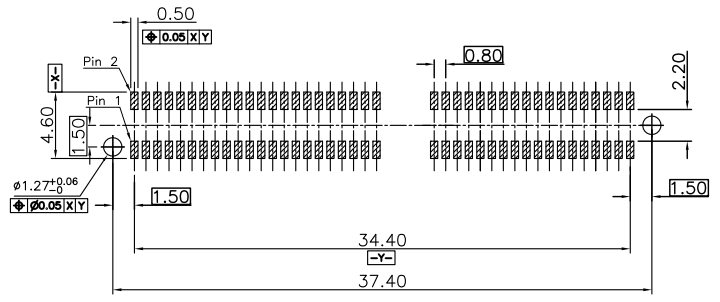

P.C. Board Layout  
(Tolerance ±0.05)

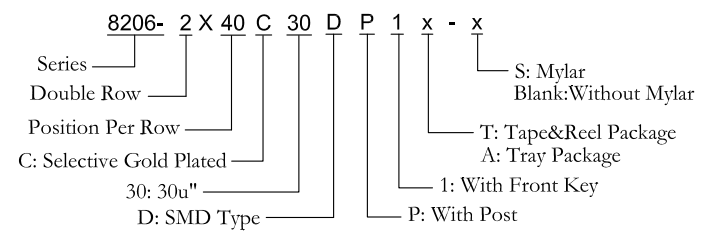

Tolerances	Dwg. No.	8206-D0000-019	Title:		 <b>OUPIIN ELECTRONIC(KUNSHAN) CO., LTD.</b> P/N: 8206-2X40C30DP1X-X SHEET 1/2 Ver.No. R4
x = ±0.50	Projection		8206 Series		
.x = ±0.25	Unit	mm	Scale	1:1	
.xx = ±0.15	Drawn By	ZY 12/22'21	Edge Card Connector 0.80mm (0.0315") Pitch SMD Type		

REV.	SPECIFICATION	ECN NO.	APPD.
R4		ECN211220	

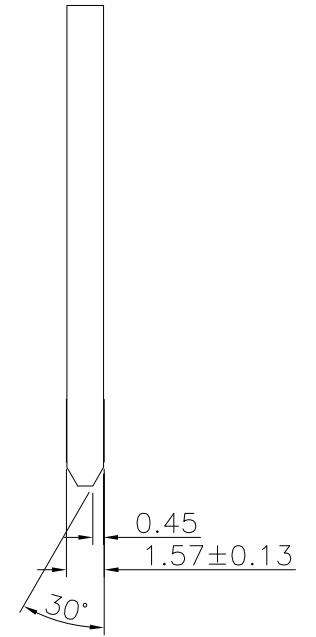
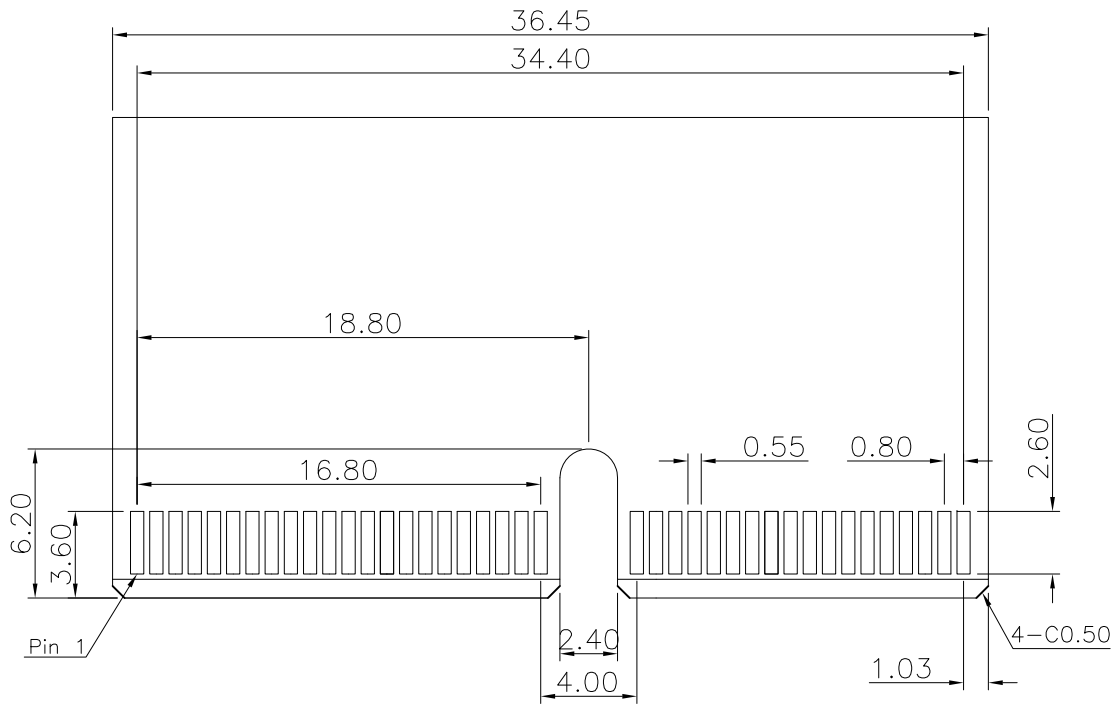

**RECOMMENDED MATTING BOARD FOOTPRINT**  
(Tolerance: ±0.05)

Tolerances x = ±0.50 .x = ±0.25 .xx = ±0.15	Dwg. No.	8206-D0000-019		Title: 8206 Series Edge Card Connector 0.80mm (0.0315") Pitch SMD Type	<b>OUPIN</b>				
	Projection	⊕ ↯			OUPIN ELECTRONIC(KUNSHAN) CO., LTD.				
	Unit	mm	Scale		1:1	P/N: 8206-2X40C30DP1X-X			
	Drawn By	ZY	12/22'21		Ⓢ	SHEET	2/2	Ver.No.	R4