

REV.	SPECIFICATION	ECN NO.	APPD.
X2			

**Material and Plating::**  
Housing:LCP, UL94V-0,Black.  
**Power Contacts:** High Conductivity Copper ,  
30μ" Au+Pd/Ni on Contact Area and 80μ" Min Tin Plated on Solder Tail over Nickel 50μ" Min.  
**Signal Contacts:** Phosphor Bronze.  
30μ" Au+Pd/Ni on Contact Area and 80μ" Min Tin Plated on Solder Tail over Nickel 50μ" Min.  
**Lock:**Phosphor Bronze,  
**Electrical Characteristics:**  
**Current Rating:** Signal Pin 2.5 AMP.  
Power Pin 30 AMP.  
**Dielectric Withstanding Voltage:** Signal Pin DC 1000V For 1 minute.  
Power Pin DC 2500V For 1 minute.  
**Insulation Resistance:** Signal Pin 5000MΩ min. at DC 500V.  
Power Pin 20000MΩ min. at DC 500V.  
**Contact Resistance:** Signal Pin 15mΩ max. at DC 20mA.  
Power Pin 0.7mΩ max. at DC 20mA.  
**Operating Temperature:** -40°C~+105°C.

**\*RoHS Compliant**  
**Notes :**  
H: High density Power---PCB Mount 5.08mm Pitch  
P: DC Power---PCB Mount 6.35mm Pitch  
A: AC Power---PCB Mount 7.62mm Pitch  
S: Signal---PCB Mount 2.54mm Pitch

ROWS	POWER						SIGNAL				FM		
	P6	P5	P4	P3	P2	P1	6	5	4	3		2	1
D							□	□	□	□	□	□	
C							□	□	□	□	□	□	
B							□	□	□	□	□	□	
A	HD	FS	FS	FS	FS	FS	□	□	□	□	□	□	HD

POWER CONTACT TO THE TOP DISTANCE 2.34mm, THE MATING LENGTH 3.61mm	FM
POWER CONTACT TO THE TOP DISTANCE 1.07mm, THE MATING LENGTH 4.88mm	FS
SIGNAL CONTACT 3.43 SOLDER TAIL, PD/NI	L

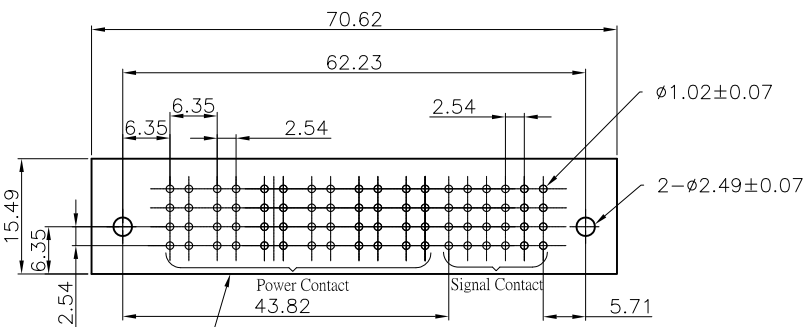
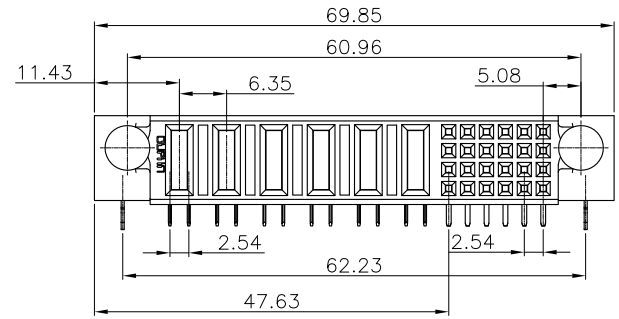
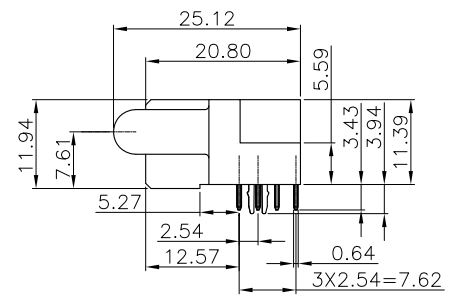
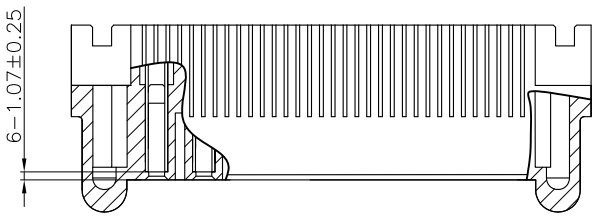
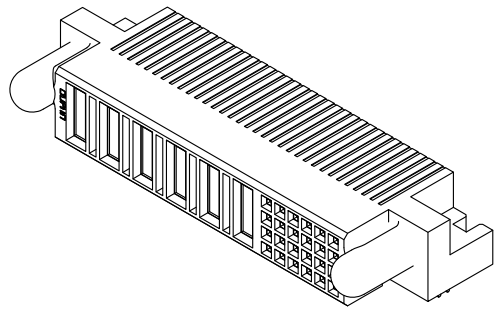

9391-A 4 P06 S24 CB30 D L A  
Series 4: Femla Right-angle P06: Without Contact S24: Dip Tin Plated Contact Au+Pd/Ni Plated 30: 30u"  
Blank: Without Contact Power Contact: Hxx; Pxx, Axx No. of position  
Blank: Without Contact Signal Contact: S xx No. of position  
A: Tray Package L: With Lock D: Dip Type  
CB30: Dip Tin Plated Contact Au+Pd/Ni Plated 30: 30u"

P.C.Board Layout  
Recommended PCB Thickness: 1.6mm±0.5

Tolerances	Dwg. No.	9391-D0000-202		Title:	
x = ±0.5	Projection	⊕ ⊖		9391 Series Female Right-angle Dip Type	
.x = ±0.25	Unit	mm	Scale		1:1
.xx = ±0.15	Drawn By	zcc 06/30'20			

<b>OUPIN</b>			
OUPIN ELECTRONIC(KUNSHAN) CO., LTD.			
P/N: 9391-A4P06S24CB30DLA			
SHEET	1/1	Ver. No.	X2