

REV.	SPECIFICATION	ECN NO.	APPD.
X5			

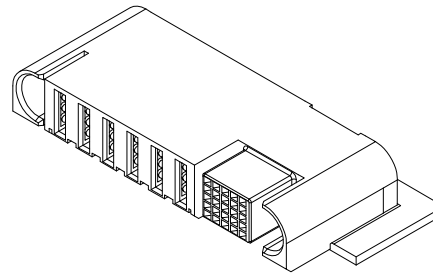
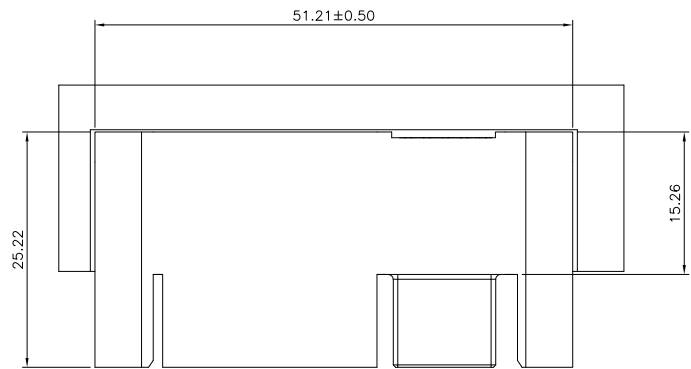

Material and Plating:

Housing: LCP, 30% Glass Filled, UL94V-0, BLACK.
Power Contacts: High Conductivity Copper .
 Au(3u")+Pd/Ni (27u") gold plated on Contact Area and 80u" Min Tin Plated on Solder Tail over nickel 50u" Min under plated .
Signal Contacts : Phosphor Bronze .
 Au(3u")+Pd/Ni (27u") gold plated on Contact Area and 80u" Min Tin Plated on Solder Tail over nickel 50u" Min under plated .

Electrical Characteristics:

Current Rating: Signal Pin 2.5 AMP.
 Power Pin 60 AMP.
Dielectric Withstanding Voltage: DC 1500V For 1 minute.
Insulator Resistance: 5000MΩ min. at DC 500V.
Contact Resistance: Signal Pin 30mΩ max.
 Power Pin 0.3mΩ max.
Operating Temperature: -40°C ~+105°C .

***RoHS Compliant**

Notes :

- L: Low Power---PCB Mount 3.0mm Pitch
- D: DC Power---PCB Mount 5.5mm Pitch
- A: AC Power---PCB Mount 7.5mm Pitch

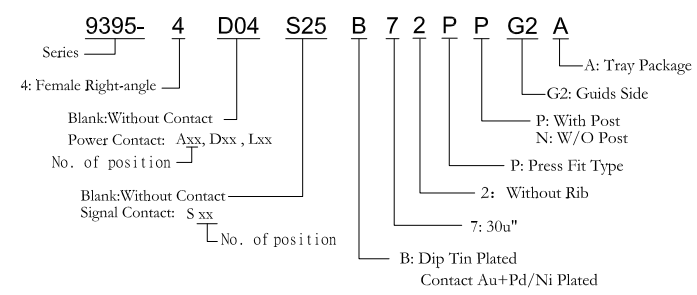
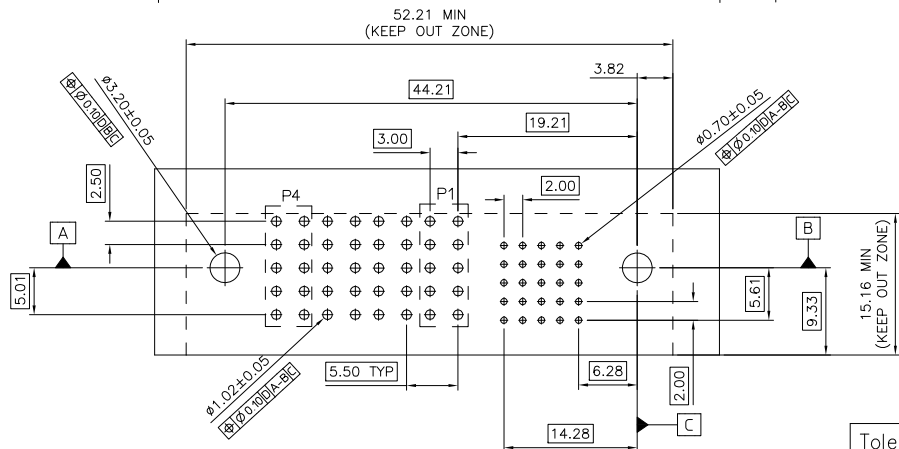
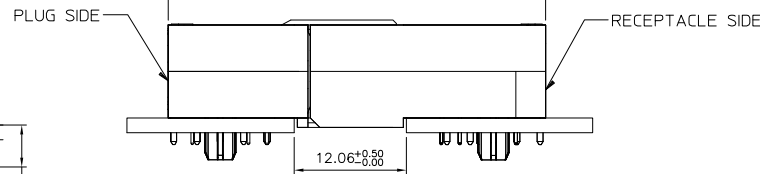
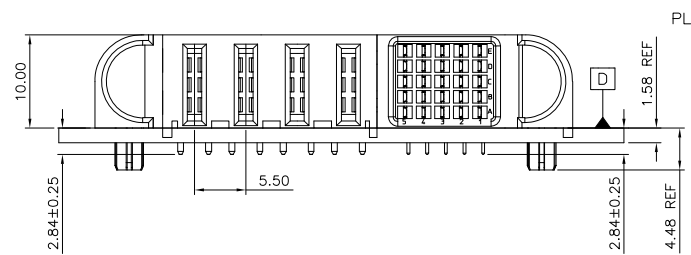

P.C.Board Layout
(Tolerance:±0.05)

Tolerances	Dwg. No.	9395-D0000-003
x = ±0.5	Projection	
.x = ±0.25	Unit	mm
.xx = ±0.15	Scale	1:1
	Drawn By	LQ 07/02'16

Title: 9395 Series
 Max P60
 10mm Low Profile, 60Amp
 Receptable, Right Angle

OUPIN			
OUPIN ELECTRONIC(KUNSHAN) CO., LTD.			
P/N:9395-4D04S25B72PPG2A			
SHEET	1/1	Ver. No.	X5