

REV.	SPECIFICATION	ECN NO.	APPD.
R3		ECN210908	

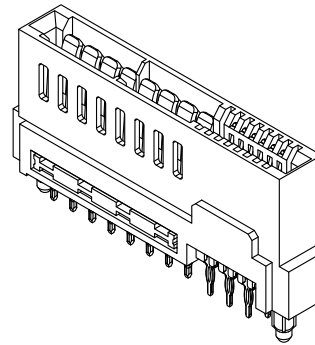
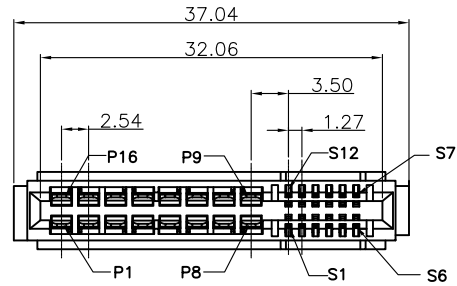

Material and Plating:

Housing: LCP, UL94V-0 ,Black.

Power Contacts: High Conductivity Copper .
30u" Au+Pd/Ni or Gold Plated on Contact Area and 80u" Min Tin Plated on Press Fit over 50u" Min Nickel.

Signal Contacts : Phosphor Bronze .

30u" Au+Pd/Ni or Gold Plated on Contact Area and 80u" Min Tin Plated on Press Fit over 50u" Min Nickel.

Electrical Characteristics:

Current Rating: Signal Pin 1.5 A

Power Pin 12.5A(UL).

Dielectric Withstanding Voltage:

Signal Pin DC 500V For 1 minute.

Power Pin DC 1000V For 1 minute.

Insulator Resistance: Signal Pin 500MΩ min. at DC 500V.

Power Pin 5000MΩ min. at DC 500V.

Contact Resistance: Signal Pin 25mΩ max.

Power Pin 0.6mΩ max.

Operating Temperature: -55°C ~+105°C.

***RoHS Compliant**

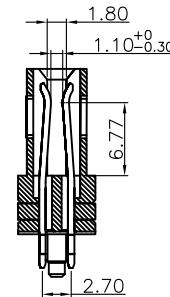
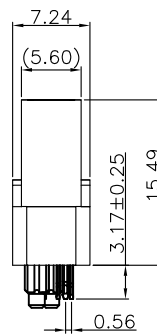
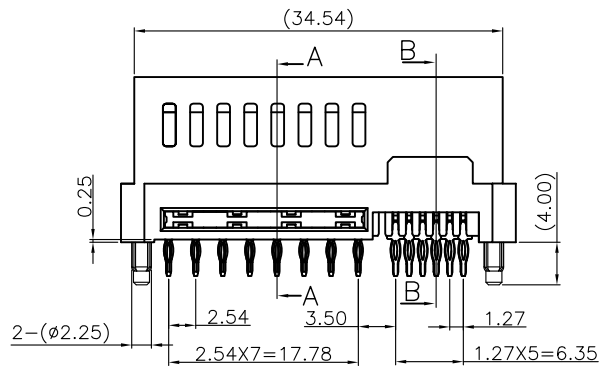

SECTION A-A
SCALE 1:1

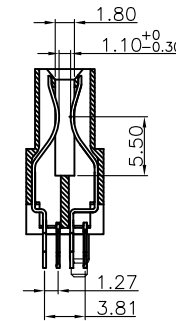

SECTION B-B
SCALE 1:1

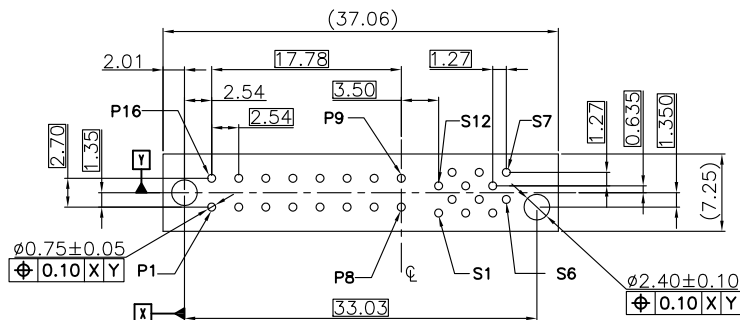

P.C.Board Layout
(Tolerance:±0.05)

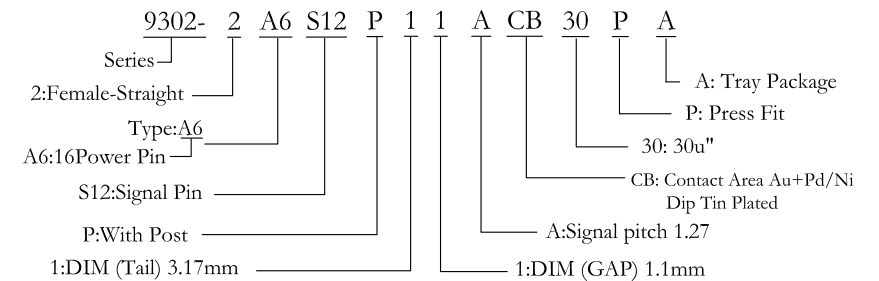

Tolerances	Dwg No.	9302-D0000-056		Title:	9302 Series	
x = ±0.5	Projection			High Power and Signal		
.x = ±0.25	Unit	mm	Scale	Edge Card Connector		
.xx = ±0.15	Drawn By	GYJ	12/11'21	SHEET 1/2 Ver. No. R3		

9302 Series
High Power and Signal
Edge Card Connector

OUPIN ELECTRONIC(KUNSHAN) CO., LTD.			
P/N: 9302-2A6S12P11ACB30PA			
SHEET	1/2	Ver. No.	R3

REV.	SPECIFICATION	ECN NO.	APPD.
R3		ECN210908	

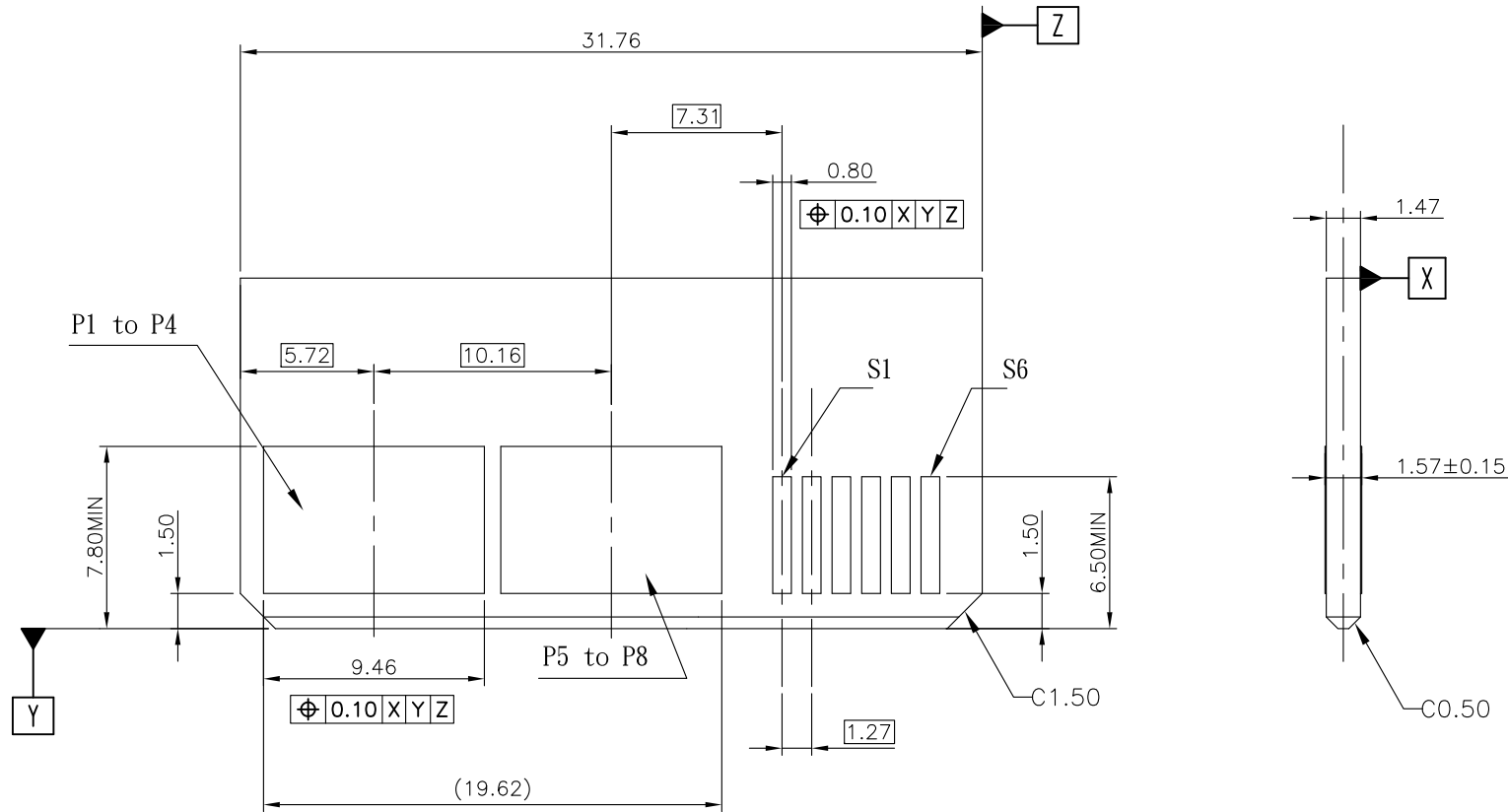

RECOMMENDED MATING BOARD FOOTPRINT
(Tolerance:±0.05)

Tolerances	Dwg No.	9302-D0000-056	
x = ±0.5	Projection		
.x = ±0.25	Unit	mm	Scale 1:1
.xx = ±0.15	Drawn By	GYJ 12/11'21	

Title: 9302 Series
High Power and Signal
Edge Card Connector

OUPIIN ELECTRONIC(KUNSHAN) CO., LTD.			
P/N: 9302-2A6S12P11ACB30PA			
SHEET	2/2	Ver. No.	R3