

REV.	SPECIFICATION	ECN NO.	APPD.
R2		ECN231036	

Material and Plating:

Housing: LCP, UL94V-0, Black.
 Power Contacts: High Conductivity Copper .
 30u"Au+Pd/Ni on Contact Area and 80u" Min Matte Tin
 Plated on Solder Tail over nickel 50u" Min .
 Signal Contacts: Phosphor Bronze .
 30u"Au+Pd/Ni on Contact Area and 80u" Min Matte Tin
 Plated on Solder Tail over nickel 50u" Min .

Electrical Characteristics:

Current Rating: 1 AMP/Signal pin.
 60 AMP/DC Power pin.
 Dielectric Withstanding Voltage: DC Power: 1500V For 1 minute.
 Signal Pin : 1000V For 1 minute.
 Insulator Resistance: Power:5000MΩ min.
 Signal:100MΩ min.
 Contact Resistance: DC Power pin : 1mΩ max.
 Signal pin : 25mΩ max.
 Operating Temperature: -40°C ~+115°C .

***RoHS Compliant**

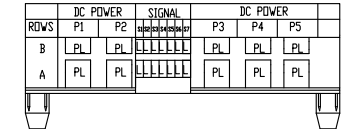
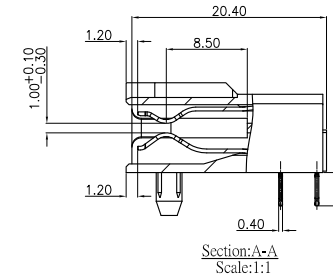
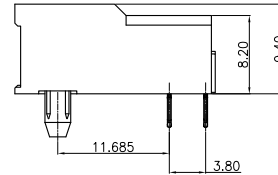
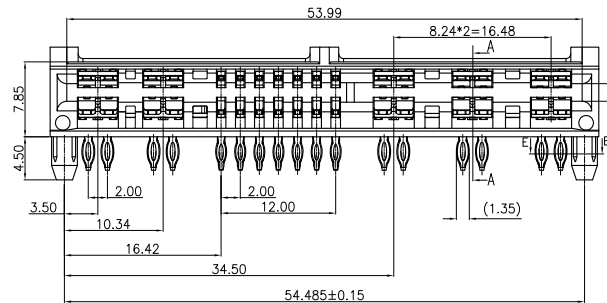
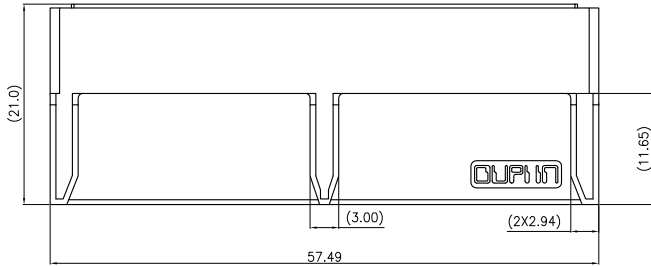
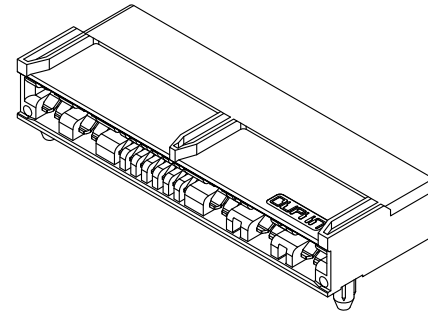

POWER CONTACT TO THE A FACE DISTANCE 8.5mm.	PL
SIGNAL CONTACT TO THE A FACE DISTANCE 8.5mm.	L

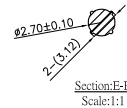

9394- 4 A3 P 1 1 1 A CB 30 P A

- Series: 4:Female -Right Angle
- A3:Type A3
- See Table
- P:With Post:4.5mm
- DIM T=3.5mm
- DIM GAP=1.0mm
- A:Tray Package
- P: Press Fit Type
- 30: 30 u"
- CB: Contact Au+Pd/Ni,Dip Tin
- C: Selective Gold Plated
- G: Gold Plated
- A:Signal Pitch 2.0mm
- B:Signal Pitch 2.54mm
- 1:W/O Left Key,With Right Key

Tolerances	Dwg. No.	9394-D0000-015	
x.=±0.50 .x=±0.25 .xx=±0.15 .xxx=±0.10	Projection		
	Unit	mm	Scale 1:1
	Drawn By	GYJ 11/02'23	

Title:
 9394 Series
 HYBRID POWER
 CARD EDGE PRESS FIT
 LOW PROFILE

OUPIN ELECTRONIC(KUNSHAN) CO., LTD.			
P/N: 9394-4A3P111ACB30PA			
SHEET	1/2	Ver. No.	R2

REV.	SPECIFICATION	ECN NO.	APPD.
R2		ECN231036	

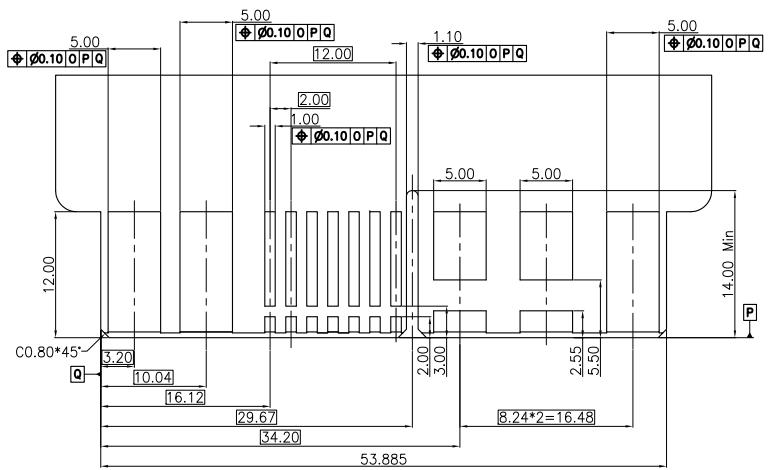

RECOMMENDED MATTING BOARD FOOTPRINT
(Tolerance:±0.05)

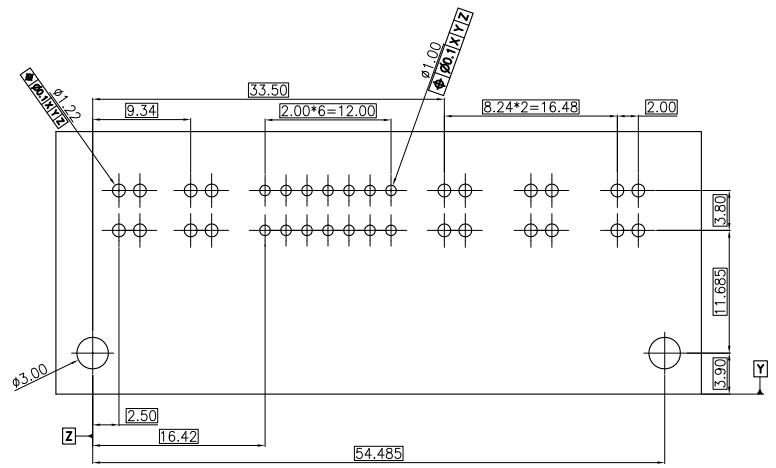
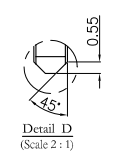
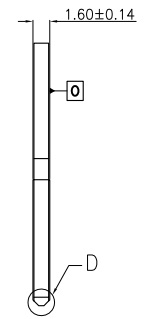

P.C. Board Layout
(Tolerance:±0.05)

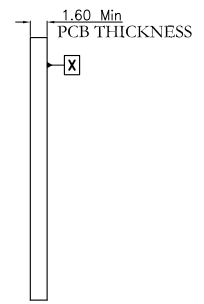

Tolerances	Dwg. No.	9394-D0000-015	
x.=±0.50	Projection		
.x=±0.25	Unit	mm	Scale 1:1
.xx=±0.15	Drawn By	GYJ 11/02'23	
.xxx=±0.10			

Title:
9394 Series
HYBRID POWER
CARD EDGE PRESS FIT
LOW PROFILE

OUPIN ELECTRONIC(KUNSHAN) CO., LTD.			
P/N: 9394-4A3P111ACB30PA			
SHEET	2/2	Ver.No.	R2