

REV.	SPECIFICATION	ECN NO.	APPD.
X2			

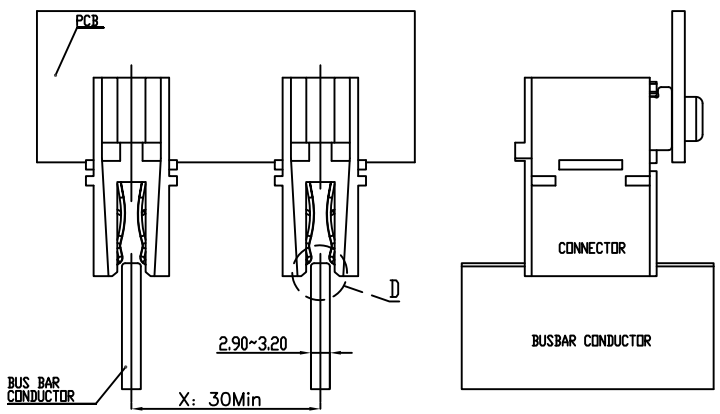

PCB And BUSBAR Conductor  
In These Views Are Shown For Reference Only.

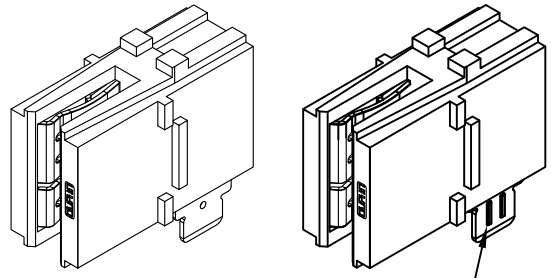

Dimples

**Material and Plating:**

Housing: LCP, UL94V-0, Black.  
Power Contacts: High Conductivity Copper.  
80µ" Min Tin Plated or 100µ" Min Ag Plated over Nickel 50µ" Min.  
Clip: Stainless Steel.

**Electrical Characteristics:**

Current Rating: 200AMP.  
Dielectric Withstanding Voltage: AC 1500V For 1 minute.  
Insulator Resistance: 1500MΩ min. at DC 500V.  
Contact Resistance: 0.2mΩ max.  
Operating Temperature: -40°C ~+105°C .

**\*RoHS Compliant**

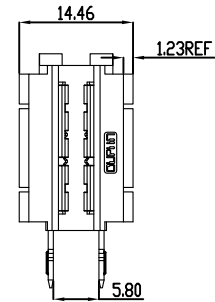
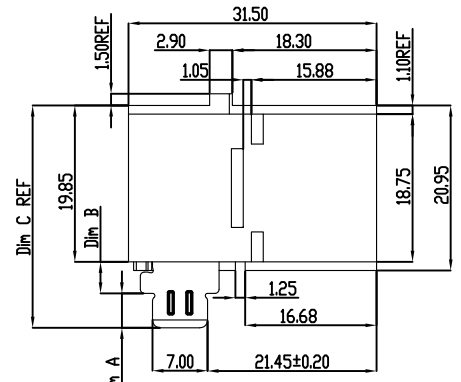
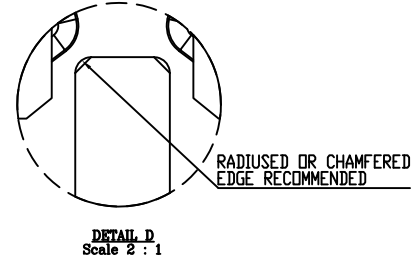
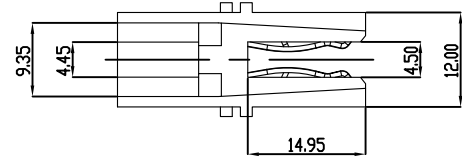

9192-A 02 x Sx A  
Series No. of Pin Count A: Tray Package  
S1 :Straight Type 1  
S2 :Straight Type 2  
S3 :Straight Type 3  
S4 :Straight Type 4  
S5 :Straight Type 5

P/N	Dim A	Dim B	Dim C	PCB THICKNESS	Dimple Feature
9192-A02xS1A	4.40	4.00	28.23	2.00 Max	NO
9192-A02xS2A	5.68	2.70	28.23	4.80 Max	NO
9192-A02xS3A	4.40	4.00	28.23	2.00 Max	YES
9192-A02xS4A	5.68	2.70	28.23	4.80 Max	YES
9192-A02xS5A	3.50	4.00	27.35	2.00 Max	NO

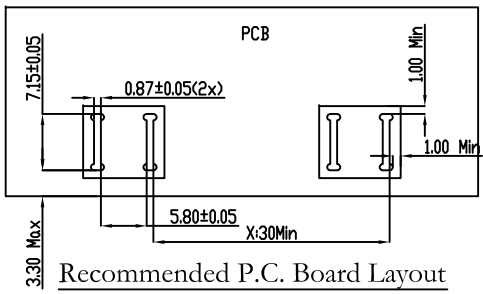

Recommended P.C. Board Layout

Tolerances	Dwg. No.	9192-D0000-005		Title:		
x.=±0.5	Projection	⊕		9192 Series BUSBARClip POWER CONNECTOR		
.x=±0.25	Unit	mm	Scale			1:2
.xx=±0.15	Drawn By	WP 05/07'21				

**OUPIN**  
OUPIN ELECTRONIC(KUNSHAN) CO., LTD.  
P/N: 9192-A02xSxA  
SHEET 1/1 Ver.No. X2