

REV.	SPECIFICATION	ECN NO.	APPD.
R9		ECN230636	

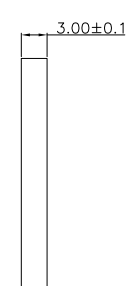
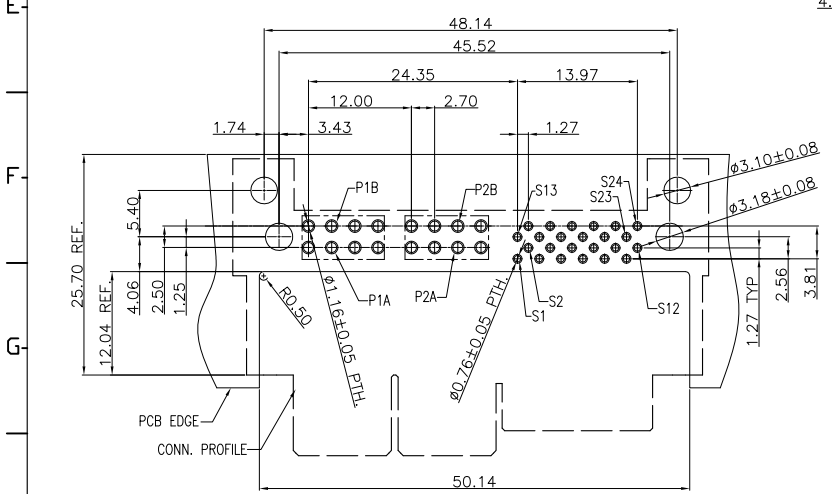
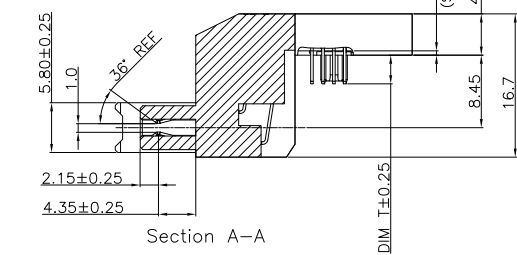
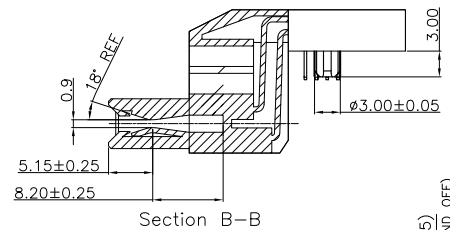
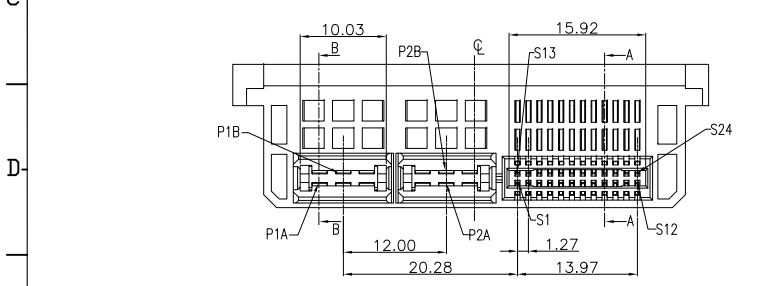
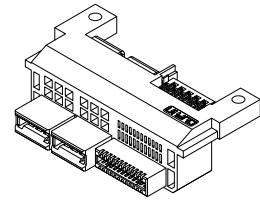
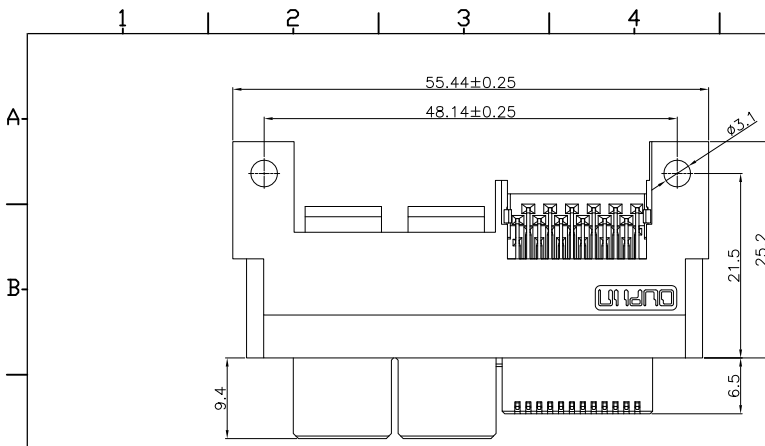

- Series 9392 - M 4 S P04 S24 P 1 x B 7 D T
- M: Height of sink board 8.45mm
 - 4: Female Right Angle
 - S: With Slot
Blank: W/O Slot
 - P04: Power Contact
 - S24: Signal Pin
 - N: W/O Post
P: With Post
 - 1: Without Guides
 - T: Tape & Reel
 - A: Tray Package
 - D: Dip Type
 - 7: 30 u"
 - B: Dip Tin Plated
Contact Au+Pd/Ni Plated
 - 1: Dim T=2.50mm
 - 8: Dim T=3.34mm

P.C. Board Layout
(Tolerance: ±0.05)

Tolerances	Dwg. No.	9392-D0000-055		Title:
x = ±0.5	Projection			9392 Series Low Profile Hybrid Power Receptacle
.x = ±0.25	Unit	mm	Scale 1:1	
.xx = ±0.15	Drawn By	JCQ 06/27'23		

OUPIN			
OUPIN ELECTRONIC(KUNSHAN) CO., LTD.			
P/N: 9392-M4SP04S24P1xB7DT			
SHEET	1/2	Ver. No.	R9

REV.	SPECIFICATION	ECN NO.	APPD.
R9		ECN230636	

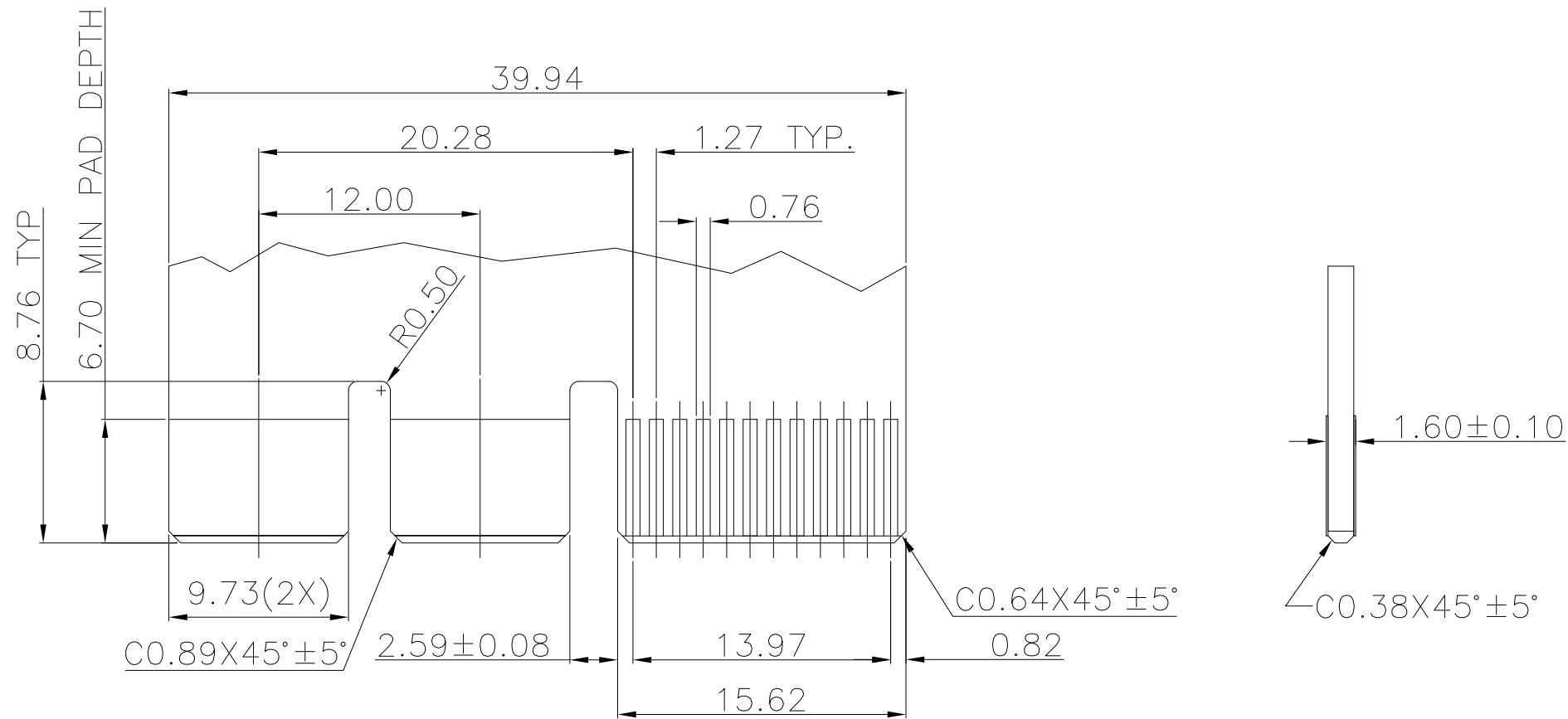

Recommended Edge Card Layout
(Tolerance:±0.05)

Tolerances	Dwg. No.	9392-D0000-055		Title:
x = ±0.5	Projection			9392 Series Low Profile Hybrid Power Receptacle
.x = ±0.25	Unit	mm	Scale 1:1	
.xx = ±0.15	Drawn By	JCQ	06/27'23	

OUPIIN ELECTRONIC(KUNSHAN) CO., LTD.			
P/N: 9392-M4SP04S24P1xB7DT			
SHEET	2/2	Ver. No.	R9

SHEET	2/2	Ver. No.	R9
-------	-----	----------	----