

REV.	SPECIFICATION	ECN NO.	APPD.

**Material:**

Housing: High Temperature Plastic UL94V-0.  
 Contacts: Copper Alloy.

**Electrical Characteristics:**

Current Rating: 1.5 AMP.  
 Dielectric Withstanding Voltage: 500 V AC.  
 Insulator Resistance: 1000MΩ min.  
 Contact Resistance: 30mΩ max.  
 Operating Temperature: -55°C ~ +85°C.

**\*RoHS Compliant**

Signal Segment	
Name	Type
S1	GND
S2	A+
S3	A-
S4	GND
S5	B-
S6	B+
S7	GND

Power Segment	
Name	Type
P1	V33
P2	V33
P3	V33
P4	GND
P5	GND
P6	GND
P7	V5
P8	V5
P9	V5
P10	GND
P11	DAS/DSS
P12	GND
P13	V12
P14	V12
P15	V12

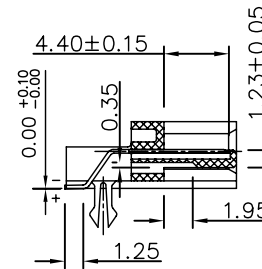
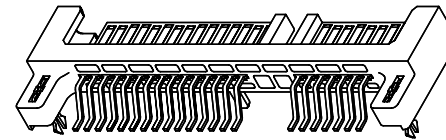
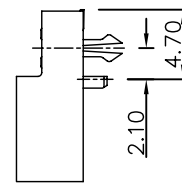

SECT A-A

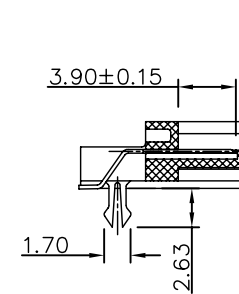

SECT B-B

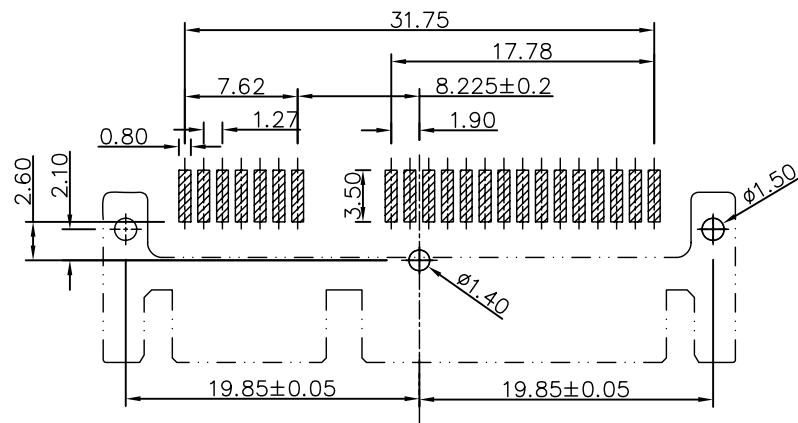
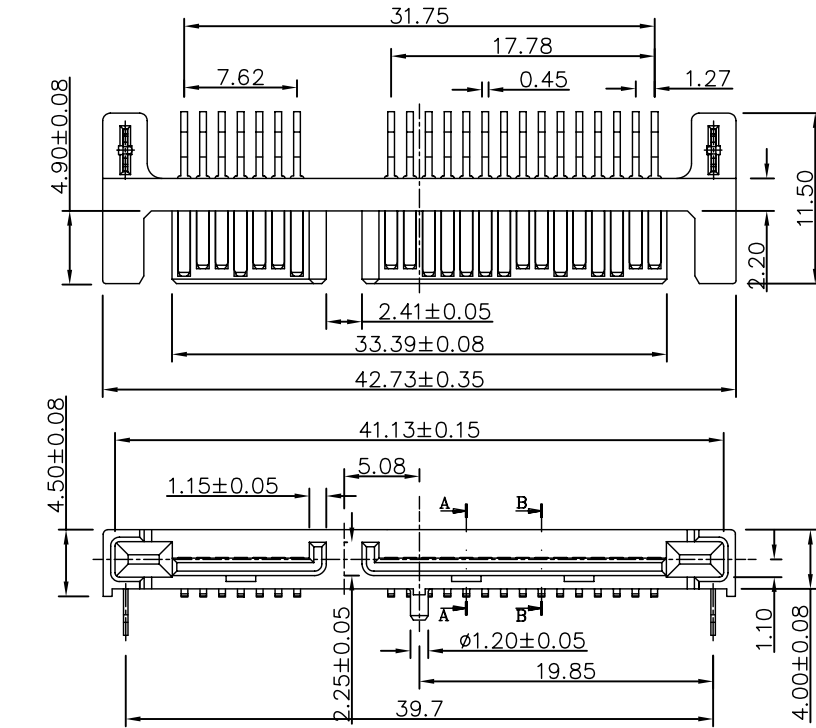

P.C.Board Layout

7904- 22 M C 15 D B A - 01  
 Series Position Male C:Selective 15:15u" D:SMD B:Reverse A:Tray Internal Code  
 Gold Plated Package

<b>Tolerances</b>	<b>Dwg. No.</b>	7904D01001	<b>Title:</b>		 <b>OUPIIN ELECTRONIC(KUNSHAN) CO., LTD.</b> <b>P/N: 7904-22MC15DBA-01</b>
x = ±0.5	<b>Projection</b>		7904 Series		
.x = ±0.38	<b>Unit</b>	mm	Serial ATA 7+15P SMD		
.xx = ±0.25	<b>Scale</b>	2:1	Right Angle (Reverse) Male		
	<b>Drawn By</b>	ZJJ 08/27'12	705	<b>SHEET</b>	1/1
				<b>Ver.No.</b>	A2