

REV.	SPECIFICATION	ECN NO.	APPD.
R3		ECN210702	

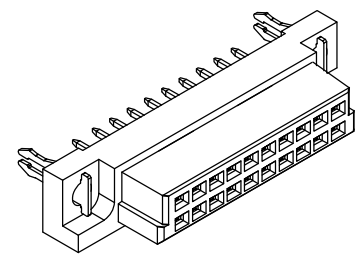
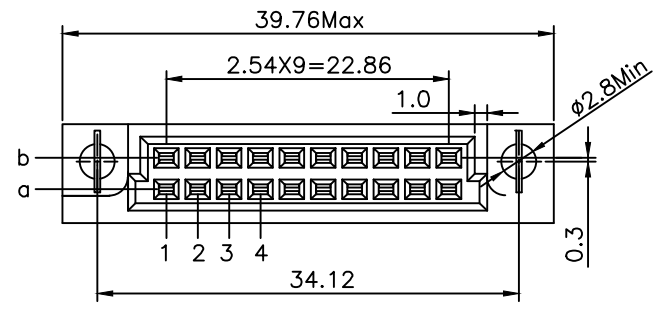

Material and Plating:

Housing: PBT, UL94V-0 Beige.
Contacts: Copper Alloy
Lock: Phosphor Bronze.
 Gold Plated on Contact Area and 80u" Min Tin or Gold Flash Plated on Solder tail over 50u"Min Nickel.

Electrical Characteristics:

Current Rating: 2 AMP.
Dielectric Withstanding Voltage: AC 1000V For 1 minute.
Insulator Resistance: 1000MΩ min. at DC 500V.
Contact Resistance: 20mΩ max. at DC 100mA.
Operating Temperature: -55°C~+125°C .

*RoHS Compliant

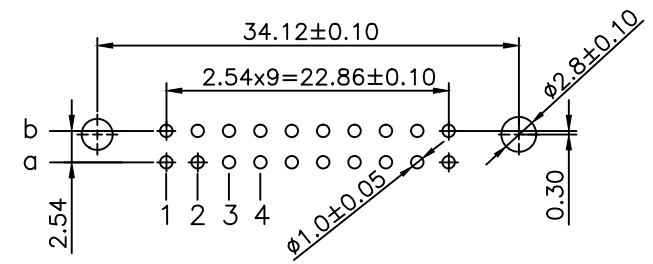
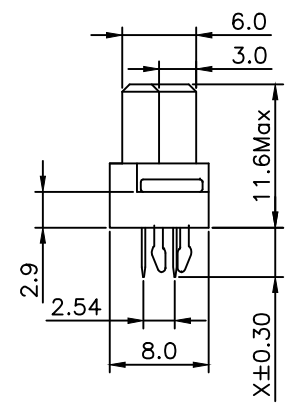
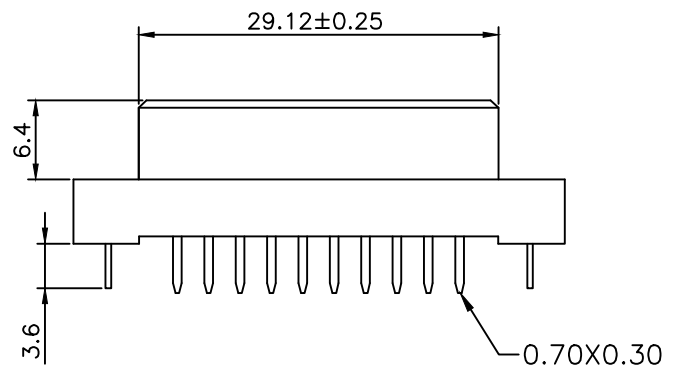

P.C. Board Layout
(Tolerance:±0.05)

9001-C 3 6 xx x C xx L1 A
 Series
 3: 2.54mm
 6: Female
 Position
 1: Dip Length
 2: Dip Length
 C: Dip Tin Plated
 Contact Gold Plated
 G: Gold Plated
 A: Tray Package
 Blank: Without Lock
 L1: With Lock
 00: G/F
 10: 10μ"
 15: 15μ"
 30: 30μ"

X length	1	2
	4.0	2.5

Pitch	Position	Rows with Contacts	Contact Arrange	P/N
2.54mm	20	a b		9001-C3620xCxxL1A
	10	a -		9001-C3610xCxxL1A

Tolerances	Dwg. No.	9001-D0000-030	
x = ±0.5	Projection		
.x = ±0.25	Unit	mm	Scale 1:1
.xx = ±0.15	Drawn By	ZY 07/01'21	

Title:
 9001 Series
 DIN41612
 Half B,1/3B Type Female

OUPIN ELECTRONIC(KUNSHAN) CO., LTD.			
P/N: 9001-C36xxxCxxL1A			
SHEET	1/1	Ver.No.	R3