

REV.	SPECIFICATION	ECN NO.	APPD.

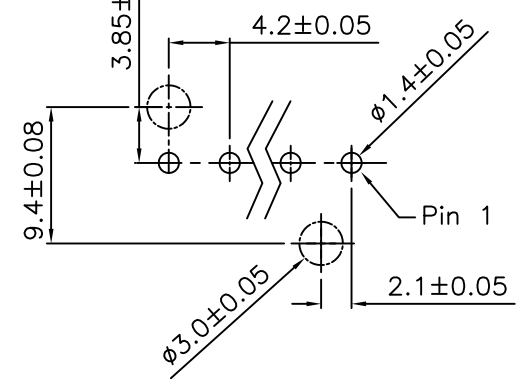

P.C. Board Layout  
(Recommended Thickness 1.78mm Max.)

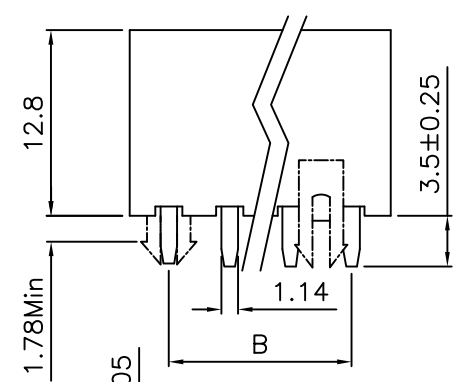
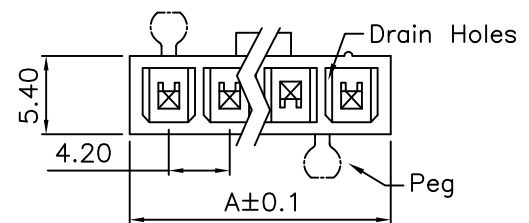
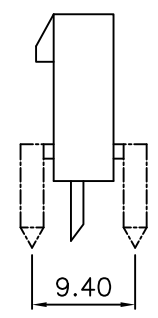

4973- 1 X xx T S x B -V0

Series ——— 1 ——— X ——— xx ——— T ——— S ——— x ——— B ——— -V0 ——— UL94V-0

Single Row ———

No. of Position ———

T: Tin Plated ———

S: Straight ———

B: Bulk Package

P: With Post, Available from 3 to 12 Position.

Blank: Without Post

**Material:**

Housing: PA66, UL94V-0.  
Contacts: Brass, 80~100u" Tin Plated over Nickel 25u".

**Electrical Characteristics:**

Current Rating:

Circuits	2~3	4~6	7~10	11~12
Ampere	9 A	8 A	7 A	6 A

Dielectric Withstanding Voltage: AC 1500V For 1 minute.  
Insulator Resistance: 1000MΩ min. at DC 250V.  
Contact Resistance: 10mΩ max. at DC 100mA.  
Operating Temperature: -40°C~+105°C.

**\*RoHS Compliant**

Position	Dimension	
	A	B
2	9.6	4.2
3	13.8	8.4
4	18.0	12.6
5	22.2	16.8
6	26.4	21.0
7	30.6	25.2
8	34.8	29.4
9	39.0	33.6
10	43.2	37.8
11	47.4	42.0
12	51.6	46.2

Tolerances	Dwg. No.	4973D02016	Title:		 <b>OUPIIN ELECTRONIC(KUNSHAN) CO., LTD.</b> P/N: 4973-1XxxTSxB-V0 SHEET 1/1 Ver.No. A4
x = ±0.5	Projection		4973 Series		
.x = ±0.25	Unit	mm	Scale	1:1	
.xx = ±0.15	Drawn By	Vivian 03/02'17	0732	4.2mm Connector Straight Wafer	