

REV.	SPECIFICATION	ECN NO.	APPD.
R1		ECR120602	

**Material:**

Housing: Thermoplastic Polyester Glass Filled UL94V-0.  
 Contacts: Copper Alloy.

**Electrical Characteristics:**

Current Rating: 2 AMP.  
 Dielectric Withstanding Voltage: AC 1000V For 1 minute.  
 Insulator Resistance: 1000MΩmin. at DC 500V.  
 Contact Resistance: 20mΩmax. at DC 100mA.  
 Operating Temperature: -55°C ~ +125°C.

**\*RoHS Compliant**

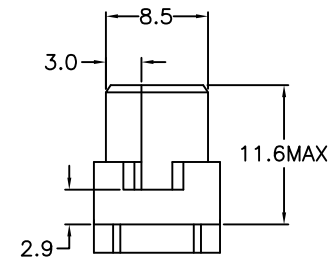
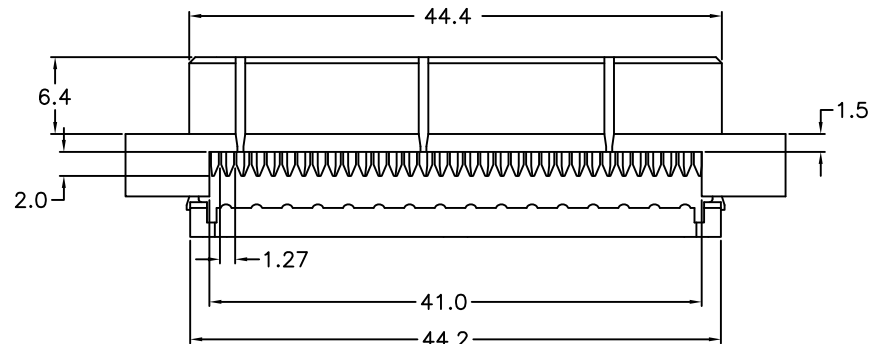
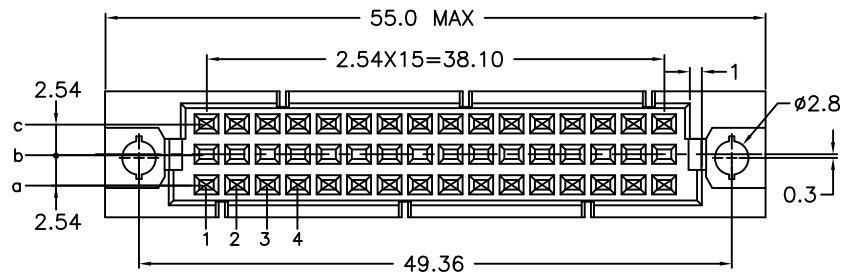
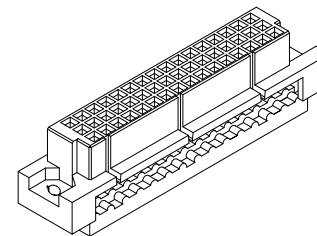

9001- 1 6 32 IDC XX A  
 Series | Position | A: Tray Package  
 1: 3Row Insulators For 1.27 Cable  
 6: Female  
 00: G/F  
 10: 10μ"  
 15: 15μ"  
 30: 30μ"

Tolerances x = ±0.5 .x = ±0.25 .xx = ±0.15	Dwg. No.	9001D16006		Title: 9001 Series DIN41612 I.D.C. Type 3 Rows Female	 OUPIIN ELECTRONIC(KUNSHAN) CO., LTD. P/N: 9001-1632IDCXXA	
	Projection					
	Unit	mm	Scale			1:1
	Drawn By	XCY06/11'12				
SHEET 1/1					Ver.No.	R1