

REV.	SPECIFICATION	ECN NO.	APPD.

Material:
Housing: Thermoplastic Polyester UL94V-0.
Solder Pin: Copper Alloy, Tin Plated.
Wire Guard: Metal.

Electrical Characteristics:
Voltage Rating: 300V.
Current Rating: 10A.
Solid Wire(AWG): 14~24.
Stranded Wire(AWG): 14~24.
Withstanding Voltage: 1.6KV.
Operating Temperature: -40°C~+115°C
***RoHS Compliant**

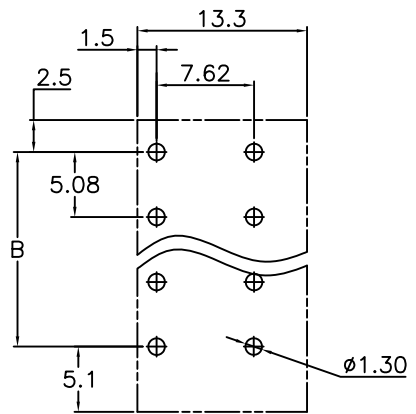
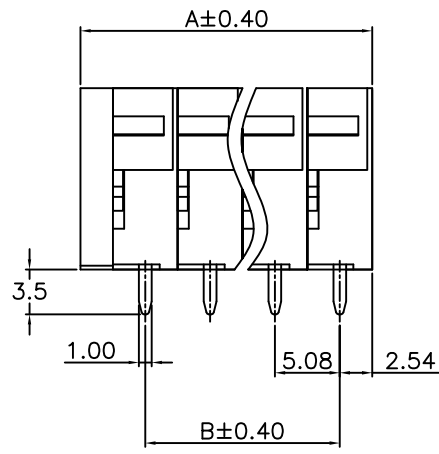
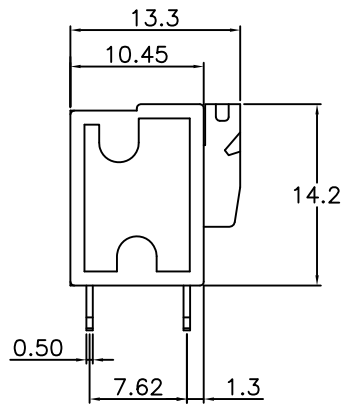
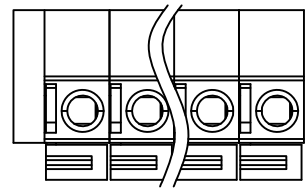

P.C. Board Layout

8935- G 133142 G xx S B
Series G:Pitch Manufacturing G:Green No. of S: Straight B: Bulk
5.08mm Code O: Orange Positions Package
Y: Grey

Position	2 Thru 24
Dimension	
A	No. of Positions X 5.08 + 2.54
B	(No. of Positions - 1) X 5.08

Tolerances	Dwg. No.	8935D02010	Title:	
X= ±0.50	Projection		8935 Series	
.X= ±0.30	Unit	mm	Scale	1:1
.XX= ±0.15	Drawn By	Vic Lyu10/06'15	5.08mm Terminal Block	
			(8800-XXTR12-01)	

① 780

OUPIIN ELECTRONIC(KUNSHAN) CO., LTD.			
P/N: 8935-G133142GxxSB			
SHEET	1/1	Ver.No.	X3