

REV.	SPECIFICATION	ECN NO.	APPD.
A1			

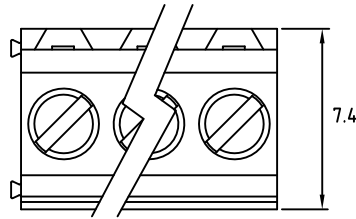

AA:Slotted "-" Screw

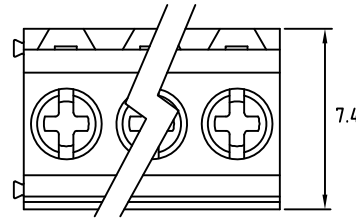

AB:Combination "+" Screw

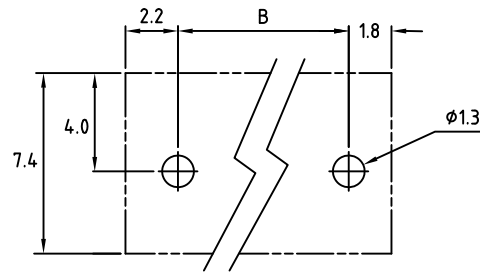
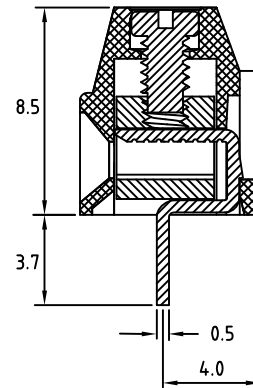
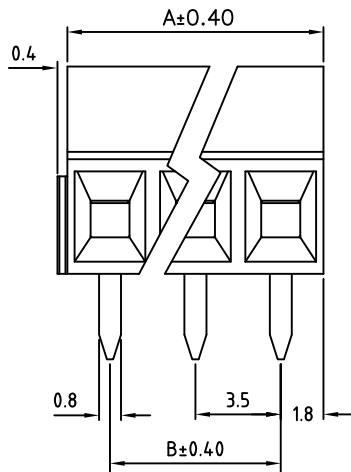

P.C. Board Layout

**Material:**

Housing: Nylon66, UL94V-0.

Solder Pin: Brass, Tin Plated.

Clamp: Zinc Alloy, Ni Plated.

Screw: Steel, Zinc Plated,M2.

**Electrical Characteristics:**

Voltage Rating: 300V

Current Rating: 10A

Solid Wire(AWG): 16-24

Stranded Wire(AWG): 16-24

Torque(Lb-In):1.7

Wire Strip Length: 5-6mm

Withstanding Voltage: 1.6KV

Operating Temperature: -40°C~+115°C

**\*RoHS Compliant**

<u>8932-</u> Series	<u>C</u> C:Pitch 3.5mm	<u>074085</u> Manufacturing Code	<u>G</u> G:Green B:Black Y:Grey U:Blue	<u>AA</u> AA:Slotted "- "Screw AB:Combination "+ "Screw	<u>xx</u> No. of Positions	<u>S</u> S:Straight	<u>B</u> B:Bulk Package for 2~3Pos. Box Package for 4~24Pos.
------------------------	------------------------------	--	--	---	----------------------------------	------------------------	--

Position	2 Thru 24
Dimension	
A	No. of Positions X3.5
B	(No. of Positions -1) X3.5

<b>Tolerances</b>	<b>Dwg. No.</b>	8932D02001
x = ±0.5	<b>Projection</b>	
.x = ±0.30	<b>Unit</b>	mm
.xx = ±0.15	<b>Scale</b>	1:1
	<b>Drawn By</b>	Scott 09/14'16

<b>Title:</b>	8932 Series 3.5mm Terminal Block (8300-xxTS11-01)
Ø780	

<b>OUPIN</b>			
OUPIN ELECTRONIC(KUNSHAN) CO., LTD.			
P/N: 8932-C074085GAxxSB			
<b>SHEET</b>	1/1	<b>Ver.No.</b>	A4