

REV.	SPECIFICATION	ECN NO.	APPD.
R4		ECN201126	

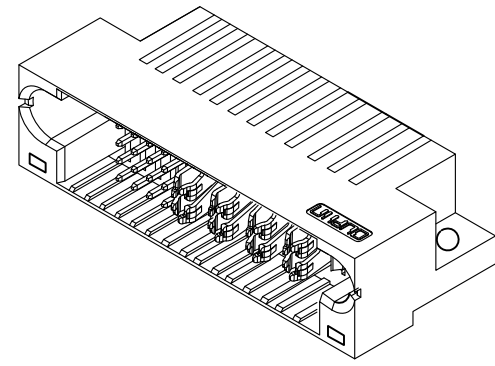

**Material and Plating:**  
**Housing:** LCP, UL94V-0, BLACK.  
**Power Contacts:** High Conductivity Copper.  
 30u" Au+Pd/Ni on Contact Area and 80u" Min Tin Plated on Solder Tail over Nickel 50u" Min.  
**Signal Contact:** Brass  
 30u" Au+Pd/Ni on Contact Area and 80u" Min Tin Plated on Solder Tail over Nickel 50u" Min.  
**Electrical Characteristics:**  
**Current Rating:** Signal Pin 2.5 AMP.  
 Power Pin 30 AMP.  
**Dielectric Withstanding Voltage:**  
 Signal Pin DC 1000V For 1 minute.  
 Power Pin DC 2500V For 1 minute.  
**Insulator Resistance:** Signal Pin 5000MΩ min. at DC 500V.  
 Power Pin 20000MΩ min. at DC 500V.  
**Contact Resistance:** Signal Pin 15mΩ max. at DC 20mA.  
 Power Pin 0.7mΩ max. at DC 20mA.  
**Operating Temperature:** -40°C ~+105°C.

**\*RoHS Compliant**  
 Notes 1 :  
 H: High density Power---PCB Mount 5.08mm Pitch  
 P: DC Power---PCB Mount 6.35mm Pitch  
 A: AC Power---PCB Mount 7.62mm Pitch  
 S: Signal---PCB Mount 2.54mm Pitch  
 Notes 2 :  
 A1 Contact Length is 5.59mm.

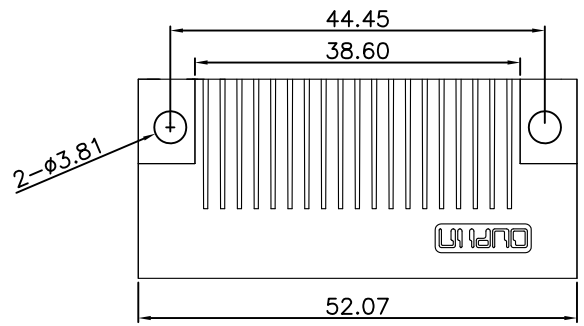
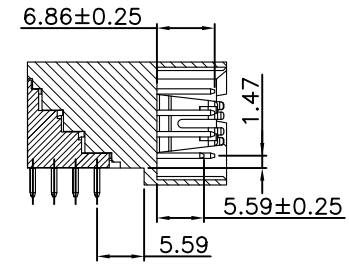
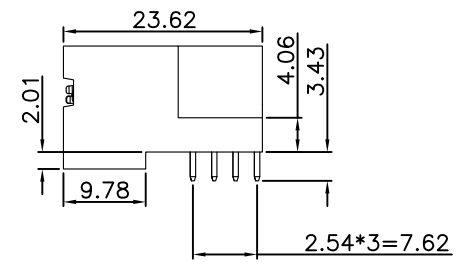
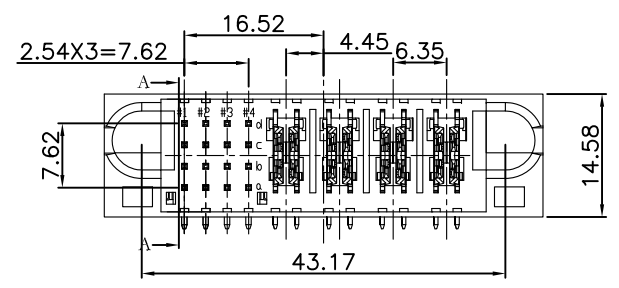

Section:A-A  
Scale:1:1

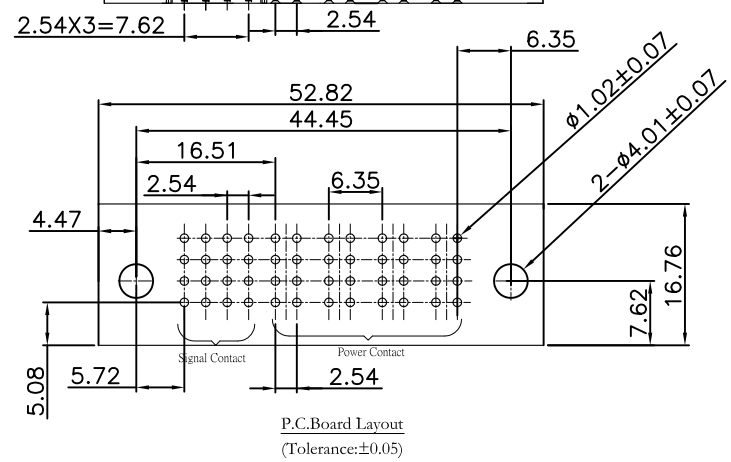
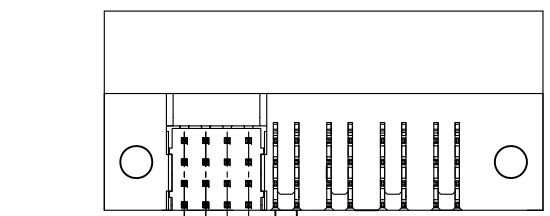

9391-A 1 S16 P04 CB 30 D A -A004  
 Series  
 1: Male Right-angle  
 Blank: Without Contact  
 Signal Contact: Sxx  
 No. of position  
 Blank: Without Contact  
 Power Contact: Hx, Px, Ax  
 No. of position  
 Internal Code  
 A: Tray Package  
 D: Dip Type  
 30: 30u"  
 CB: Dip Tin Plated  
 Contact Au+Pd/Ni Plated

ROWS	SIGNAL	POWER			
		1	2	3	4
D	GGGG	P1	P2	P3	P4
C	GGGG	MS	MS	MS	MS
B	GGGG				
A	GGGG				

SIGNAL PIN CONTACT LENGTH 4.32mm	H
SIGNAL PIN CONTACT LENGTH 5.59mm	E
SIGNAL PIN CONTACT LENGTH 7.05mm	F
SIGNAL PIN CONTACT LENGTH 6.86mm	G
HOT PLUG POWER CONTACT.STD	MS

Tolerances	Dwg. No.	9391-D0000-041
x = ±0.5	Projection	
.x = ±0.25	Unit	mm
.xx = ±0.15	Scale	1:1
	Drawn By	XS 06/11'21

Title:  
9391 Series  
Male Right-angle Dip Type

<b>OUPIN</b>			
OUPIN ELECTRONIC(KUNSHAN) CO., LTD.			
P/N: 9391-A1S16P04CB30DA-A004			
SHEET	1/1	Ver. No.	R4