

REV.	SPECIFICATION	ECN NO.	APPD.
R6		ECN221118	

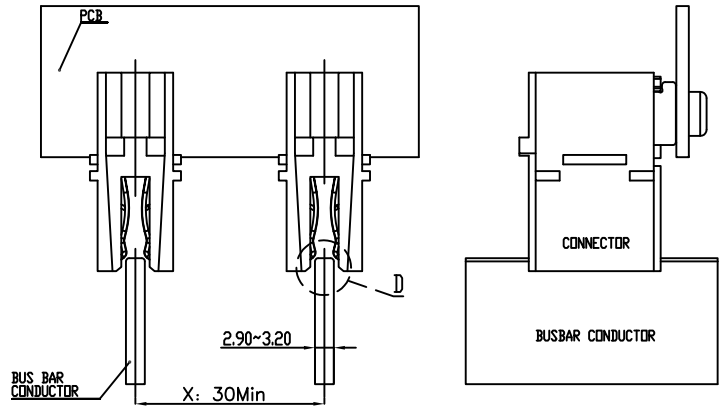

PCB And BUSBAR CONDUCTOR
In These Views Are Shown For Reference Only.

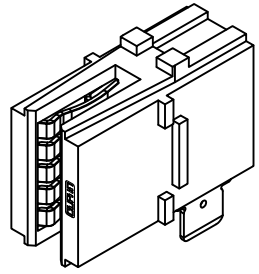

Material and Plating:

Housing: LCP, UL94V-0, Black.
Power Contacts: High Conductivity Copper.
80µ" Min Tin Plated or 100µ" Min Ag Plated over Nickel 50µ" Min.
Clip: Stainless Steel.

Electrical Characteristics:

Current Rating: 180AMP.
Hot plugged 180A at 1.3V
Dielectric Withstanding Voltage: AC 1500V For 1 minute.
Insulator Resistance: 1500MΩ min. at DC 500V.
Contact Resistance: 0.2mΩ max.
Operating Temperature: -40°C ~+105°C .

***RoHS Compliant**

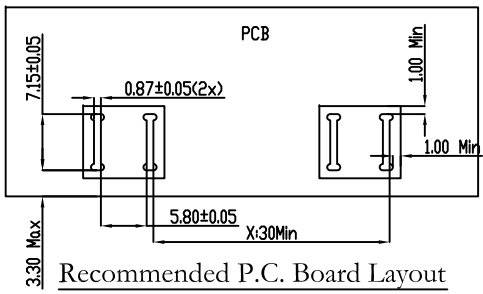
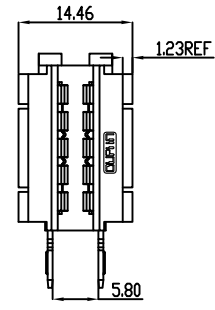
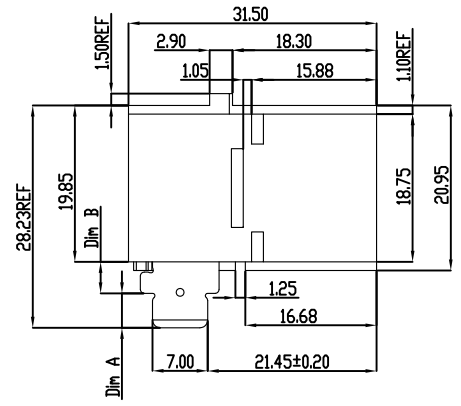
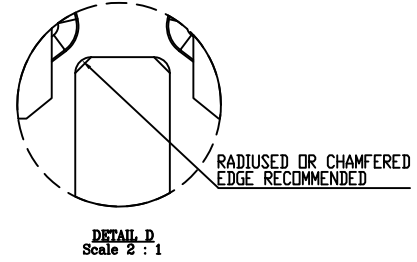
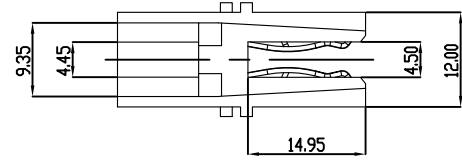

Recommended P.C. Board Layout

9192- 02 x S1(2) A
Series ——— A:Tray Package
No.of Pin Count ——— S1 :Straight Type 1
T: Tin/Ni Plating ——— S2 :Straight Type 2
A: Ag/Ni Plating

P/N	Dim A	Dim B	PCB THICKNESS	Dimple Feature
9192-02xS1A	4.40	4.00	2.00 Max	NO
9192-02xS2A	5.68	2.70	4.80 Max	NO

Tolerances	Dwg. No.	9192-D0000-003	Title:
x.=±0.5	Projection		9192 Series BUSBARClip POWER CONNECTOR
.x=±0.25	Unit	mm	
.xx=±0.15	Scale	1:2	
	Drawn By	ZY 11/9'22	

OUPIN
OUPIN ELECTRONIC(KUNSHAN) CO., LTD.
P/N: 9192-02xS1(2)A
SHEET 1/1 Ver.No. R6