

REV.	SPECIFICATION	ECN NO.	APPD.

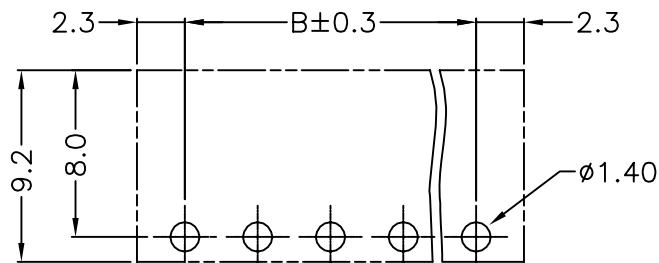
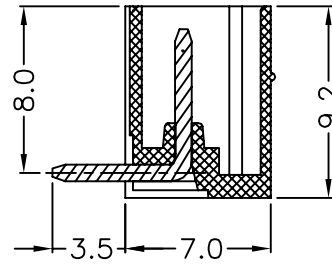
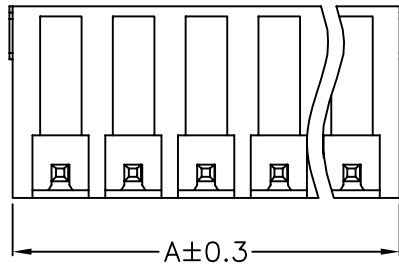
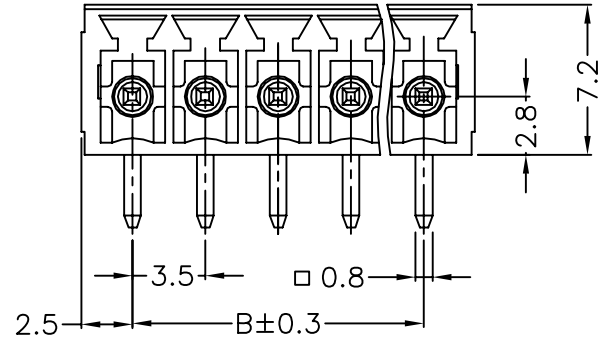

P.C.Board Layout

Material:

Housing: Thermoplastic Polyester UL94V-0.
Contact Pin: Copper Alloy, Tin Plated.

Electrical Characteristics:

Voltage rating: 300V
Current rating: 10A
Withstanding Voltage: 1.6 KV
Operating temperature: -40°C ~ +115°C

***RoHS Compliant**

8930- C 070092 G BA xx R B
Series C: Pitch 3.5mm Manufacturing Code G:Green BA:Close Type No.of Positions R: Right Angle B: Bulk Package for 2~5Pos. Box Package for 6~24Pos.
Y:Grey U:Blue

Position	2 Thre 24
Dimension	
A	No.of Positions*3.5+1.1
B	(No.of Positions-1)*3.5

Tolerances	Dwg. No.	8930D01001		Title:		 OUPIIN ELECTRONIC(KUNSHAN) CO., LTD. P/N: 8930-C070092GBAxxRB	
x = ±0.5	Projection			8930 Series			
.x = ±0.30	Unit	mm	Scale	3.5mm Terminal Block		SHEET	
.xx = ±0.15	Drawn By	Peggy 08/29'12		(8300-xxMTR11-01)		1/1	Ver.No.
				① 780			A4