

| | | | |
|------|---------------|---------|-------|
| REV. | SPECIFICATION | ECN NO. | APPD. |
| | | | |

Material:
Housing: PA46,UL94V-0.
Contacts: Brass,Gold Plated on Contact Area and 100μ" min
Tin Plated on Solder Tail over Nickel 40μ"min.

Electrical Characteristics:
Current Rating: 1.5 AMP.
Dielectric Withstanding Voltage: 500 V AC.
Insulator Resistance: 1000MΩ min.
Contact Resistance: 30mΩ max.
Operating Temperature: -55°C ~ +85°C .

***RoHS Compliant**

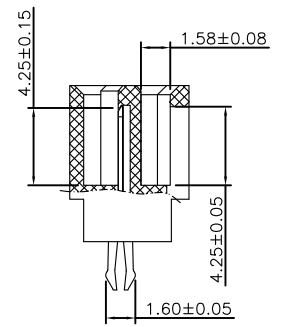
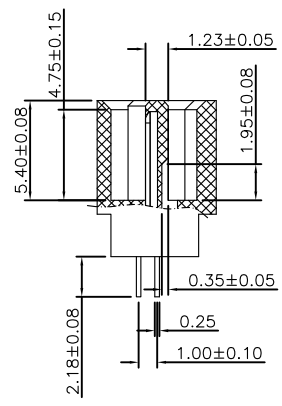
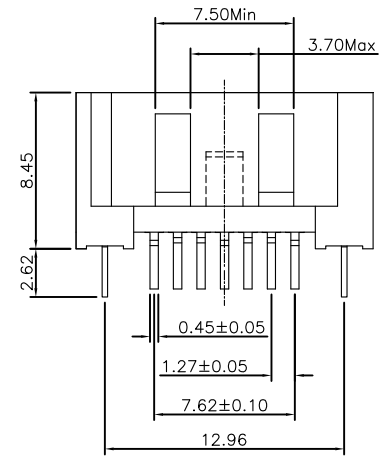
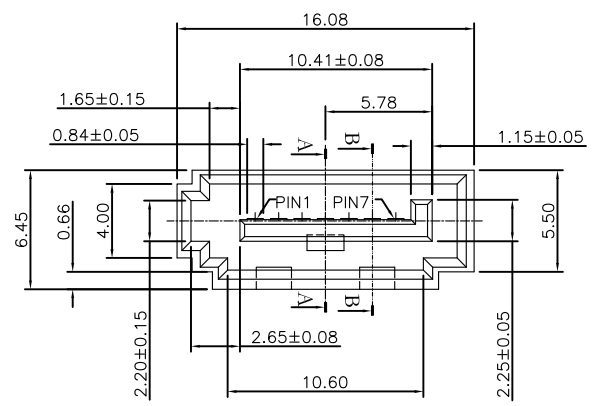
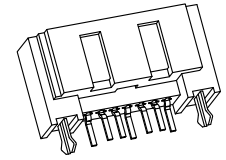

SECTION A-A

SECTION B-B

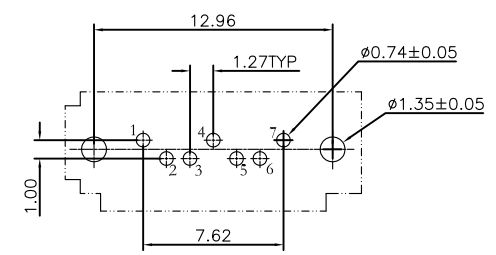

P.C.Board Layout

7904- 07 M C 15 S B U - 01
Series Position Male C:Selective 15:15u" S:Straight B:Black U:Tube Internal
Gold Plated Package Code

| Pin | Signal Name |
|-----|-------------|
| 1 | GND |
| 2 | A+ |
| 3 | A- |
| 4 | GND |
| 5 | B- |
| 6 | B+ |
| 7 | GND |

| | | | |
|-------------|------------|----------------|---------------|
| Tolerances | Dwg. No. | 7904D01008 | Title: |
| x = ±0.5 | Projection | | 7904 Series |
| .x = ±0.25 | Unit | mm | Serial ATA 7P |
| .xx = ±0.15 | Drawn By | Doris 01/03'17 | DIP Type |

7904 Series
Serial ATA 7P
DIP Type

| | | | |
|--------------------------------------|-----|---------|----|
| | | | |
| OUPIIN ELECTRONIC(KUNSHAN) CO., LTD. | | | |
| P/N: 7904-07MC15SBU-01 | | | |
| SHEET | 1/1 | Ver.No. | A2 |

Ø 705