

REV.	SPECIFICATION	ECN NO.	APPD.
R5		ECN220120	

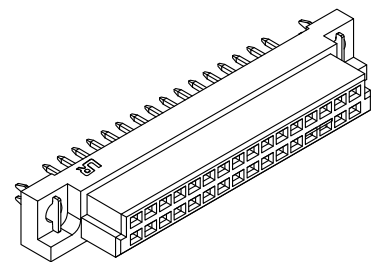
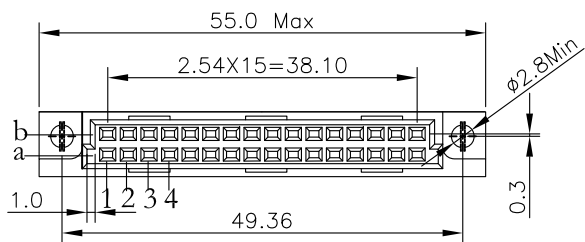

**Material and Plating:**  
Housing: PBT, UL94V-0, Beige.  
Contacts: Copper Alloy.  
Lock: Phosphor Bronze.  
Gold Plated on contact Area and 80u"Min Tin or Gold Flash plated on solder tail over 50u"Min Nickel.

**Electrical Characteristics:**  
Current Rating: 2 AMP.  
Dielectric Withstanding Voltage: AC 1000V For 1 minute.  
Insulator Resistance: 1000MΩ min. at DC 500V.  
Contact Resistance: 20mΩ max. at DC 100mA.  
Operating Temperature: -55°C ~+125°C .

**\*RoHS Compliant**

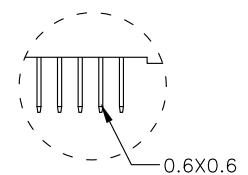
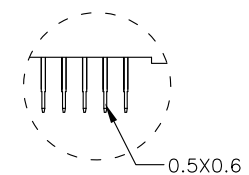
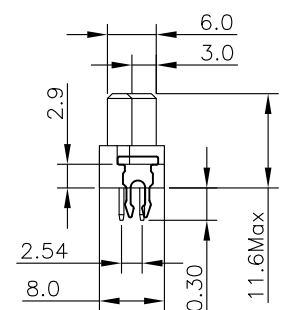
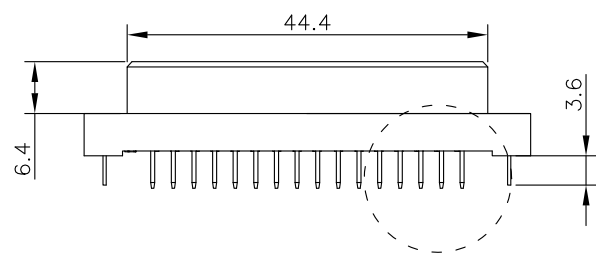

Dip :1,2

Dip :W1,W2

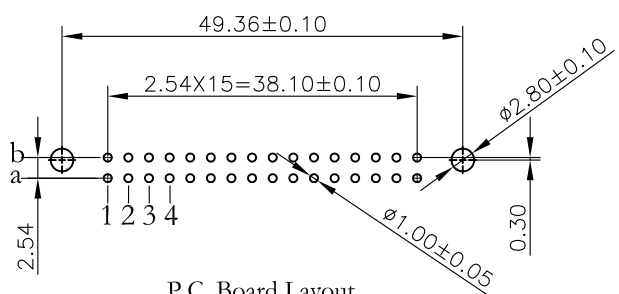

P.C. Board Layout  
(Tolerance:±0.05)

9001- 3 (4)6 xx x C xx L1 A  
Series  
3: 2.54mm  
4: 5.08mm  
6: Female  
Position  
1: Dip Length  
2: Dip Length  
W1: Dip Length  
W2: Dip Length  
A: Tray Package  
Blank: W/O Lock  
L1: With Lock  
00: G/F  
10: 10u"  
15: 15u"  
30: 30u"  
C: Dip Tin Contact Gold Plated  
G: Gold Plated

Pitch	Position	Rows with Contacts	Contact Arrange	x length			
				1 4.0	2 2.5	W1 13	W2 17
2.54mm	32	a b		9001-3632xCxxL1A			
	16	a -		9001-3616xCxxL1A			
5.08mm	16	a b		9001-4616xCxxL1A			
	8	a -		9001-4608xCxxL1A			

Tolerances	Dwg. No.	9001D36001	
x = ±0.5	Projection		
.x = ±0.25	Unit	mm	Scale 1:1
.xx = ±0.15	Drawn By	ZY 1/12'22	

Title:  
9001 Series  
DIN41612 Half B Type Female

<b>OUPIN</b>			
OUPIN ELECTRONIC(KUNSHAN) CO., LTD.			
P/N: 9001-3(4)6xxxL1A			
SHEET	1/1	Ver.No.	R5