

REV.	SPECIFICATION	ECN NO.	APPD.
R6		ECN231131	

**Material:**  
**Housing:** PBT,UL94V-0,Beige  
**Contacts:** Copper Alloy  
 Gold Plated on Contact Area and 80u"Min Tin Plated on solder tail over Nickel 50u" Min.  
**Lock:** Phosphor Bronze  
 80u" Min Tin Plated over Nickel 50u" Min.  
**Electrical Characteristics:**  
**Current Rating:** 2 AMP.  
**Dielectric Withstanding Voltage:** AC 1000V For 1 minute.  
**Insulator Resistance:** 10<sup>6</sup>MΩ min. at DC 500V.  
**Contact Resistance:** 20mΩ max. at DC 100mA.  
**Operating Temperature:** -55°C ~+125°C .  
**\*RoHS Compliant**

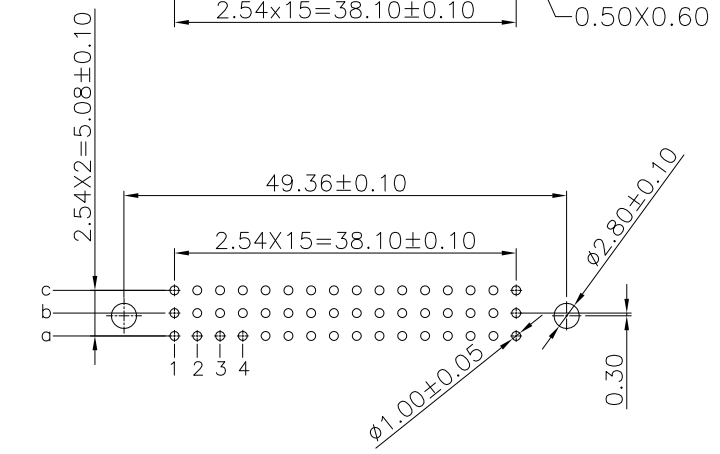
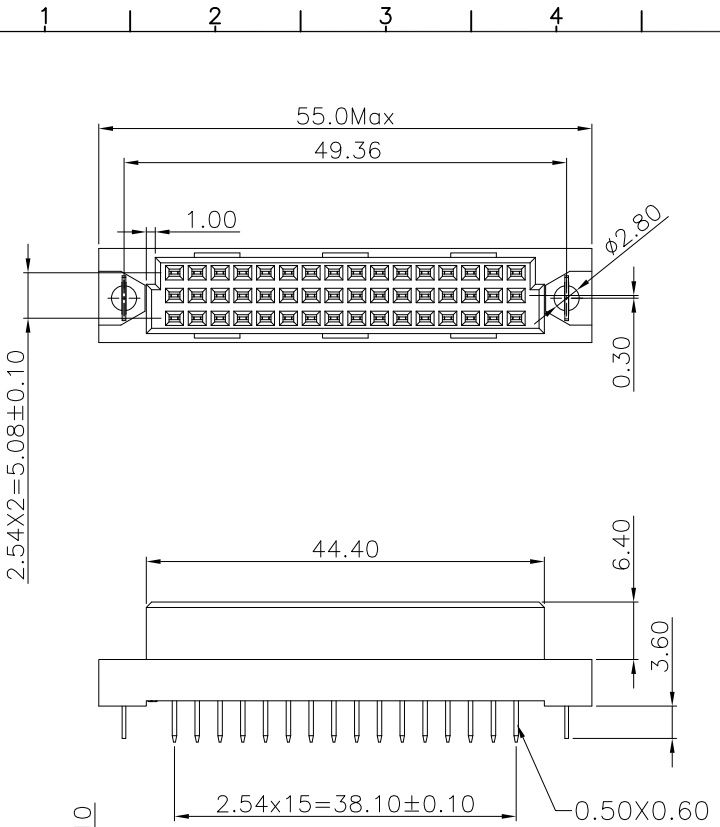
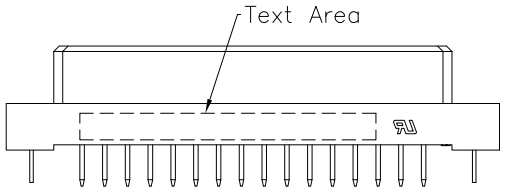
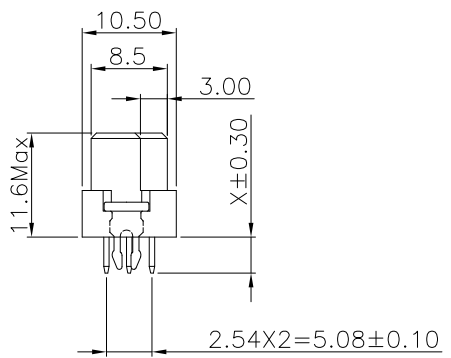
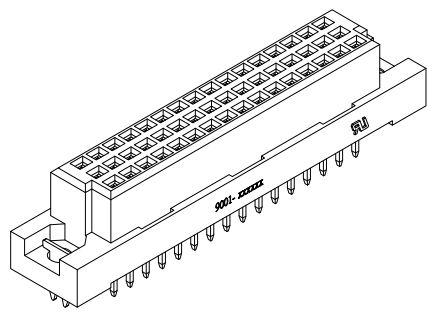

P.C. Board Layout  
Tolerance:(± 0.05)

**9001- x 6 xx x C xx L1 A**

Series  
 1: 2.54mm  
 2: 5.08mm  
 6: Female

Position  
 1: Dip Length  
 2: Dip Length  
 W1: Dip Length  
 W2: Dip Length

A: Tray Package  
 Blank: W/O Lock  
 L1: With Lock  
 00: G/F  
 10: 10u"  
 15: 15u"  
 30: 30u"  
 C: Dip Tin Contact Gold

	length	1	2	W1	W2
	X	4.0	2.5	13	17
2.54mm	48	a b c			
	32	a - c			
	16	a - -			
5.08mm	24	a b c			
	16	a - c			
	8	a - -			
Pitch	Pin No.	Rows With Contacts	Contact Arrange		

<b>Tolerances</b>	<b>Dwg. No.</b>	9001D16001	<b>Title:</b>	
x = ±0.5	<b>Projection</b>		9001 Series	
.x = ±0.25	<b>Unit</b>	mm	DIN41612 Half	
.xx = ±0.15	<b>Scale</b>	1:1	C Type Female	
	<b>Drawn By</b>	GYJ 11/21'23		

**OUPIIN**  
**OUPIIN ELECTRONIC(KUNSHAN) CO., LTD.**  
**P/N: 9001-x6xxxCxxL1A**

<b>SHEET</b>	1/1	<b>Ver.No.</b>	R6
--------------	-----	----------------	----